



OVERSTRAND ROAD

, Cromer, NR27 0AJ

£179,950

Leasehold

Overstrand Road

Cromer,
NR27 0AJ

£179,950

Leasehold

- **** CHAIN FREE ****
- **Two bedroom**
- **Stunning views of the sea and North Lodge Park**
- **Close to town centre**
- **Large living/dining room**
- **Close to North Lodge Park**
- **Traditional features**
- **Close to seafront/beach**

**** CHAIN FREE ****

This beautifully presented second floor, two bedroom apartment close to the town centre boasts a spacious living/dining room and wonderful views of the sea and North Lodge Park. The property comprises of a spacious living room, two bedrooms, kitchen and family bathroom.

With traditional features such as the fireplaces in the living room and bedroom one and being so close to the town centre, this property would make a great investment or an ideal home.

Call Henleys to arrange a viewing





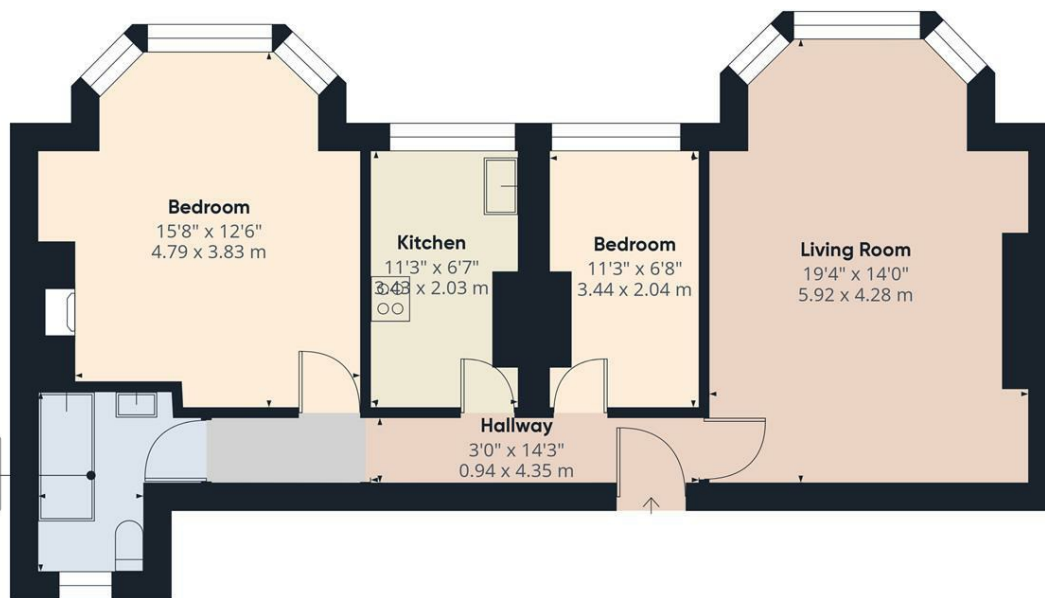

Approximate total area⁽¹⁾
696.42 ft²
64.7 m²

(1) Excluding balconies and terraces

While every attempt has been made to ensure accuracy, all measurements are approximate, not to scale. This floor plan is for illustrative purposes only.

Calculations are based on RICS IPMS 3C standard.

GIRAFFE360

Energy Efficiency Rating

	Current	Potential
Very energy efficient - lower running costs		
(92 plus) A		81
(81-91) B		
(69-80) C	69	
(55-68) D		
(39-54) E		
(21-38) F		
(1-20) G		
Not energy efficient - higher running costs		
England & Wales	EU Directive 2002/91/EC	

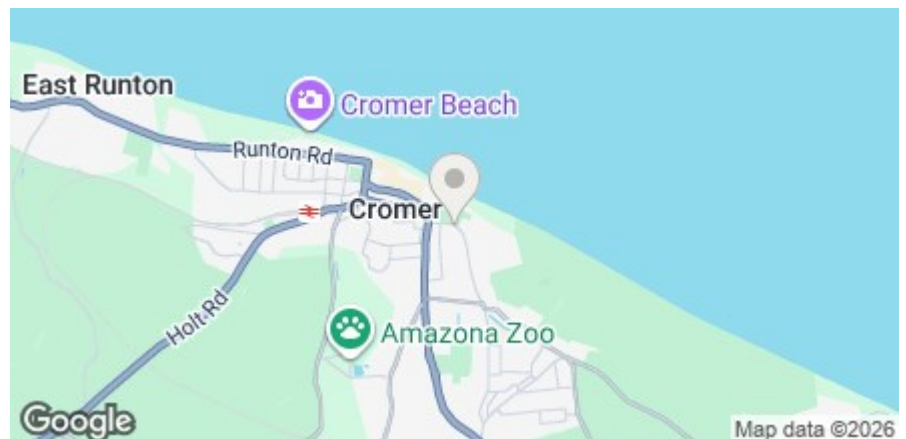

15 West Street, Cromer, Norfolk, NR27 9HZ

01263 511111 • hello@henleyshomes.co.uk • henleyshomes.co.uk

These particulars and measurements whilst believed to be accurate, are set out as a general outline only for guidance and do not constitute any part of an offer or contract. Intending purchasers should not rely on them as statements of representation of fact, but must satisfy themselves by inspection or otherwise as to their accuracy. No person in this firm's employment has the authority to make or give representation or warranty in respect of the property.

