



Chepstow Villas, W11

£995 per week (£4,745 pcm)



- Three Bedrooms
- Natural Light
- House
- South facing Garden
- Bright living/dining room
- Prime Location

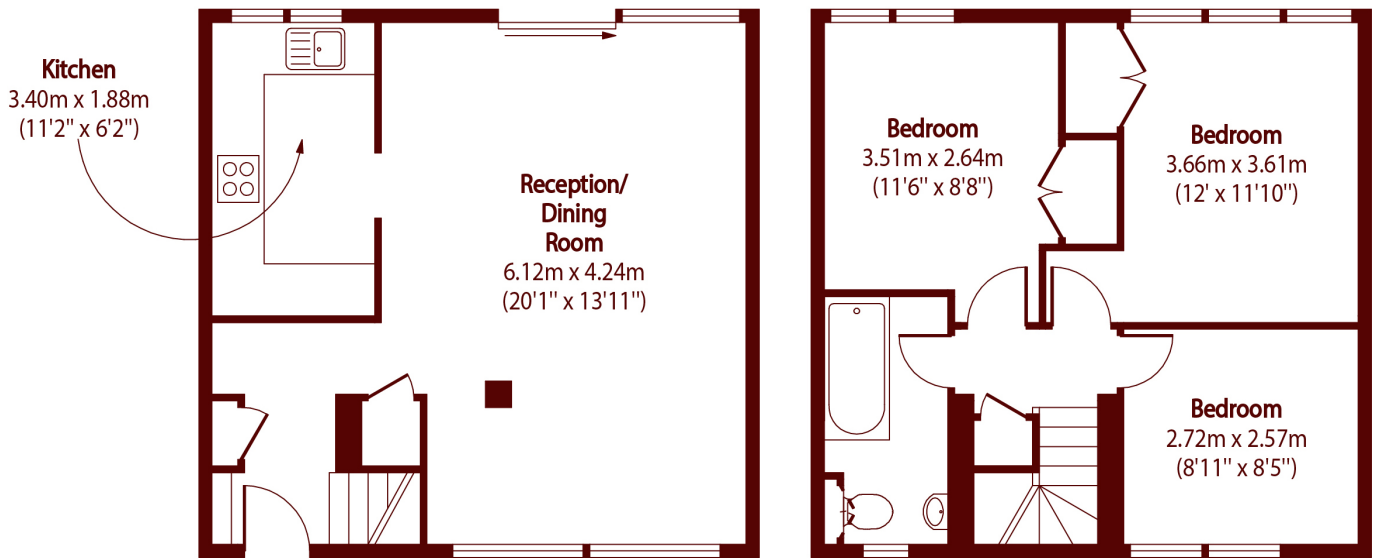

Total area (approx): 76.18 sq m (820 sq. ft)

Marsh & Parsons Notting Hill

2-6 Kensington Park Road,
London, W11 3BU
020 7313 2890