



42 Gaveller Road, Swindon
Swindon



42 Gaveler Road

Swindon

Stylish three-bedroom semi in Redhouse with three floors, en-suite, modern kitchen, low-maintenance garden, garage, parking, and great access to schools, amenities, and transport links.

Council Tax band: D

Tenure: Freehold

EPC Energy Efficiency Rating: C

EPC Environmental Impact Rating: C

- Three Double Bedrooms
- Garage and Allocated Parking
- Large Kitchen and Seperate Dining/Living
- Close to Local Ammeneties and Schools
- Finished to a High Standard
- Low Maintenance Garden



Ground Floor

Approx. 36.4 sq. metres (391.7 sq. feet)

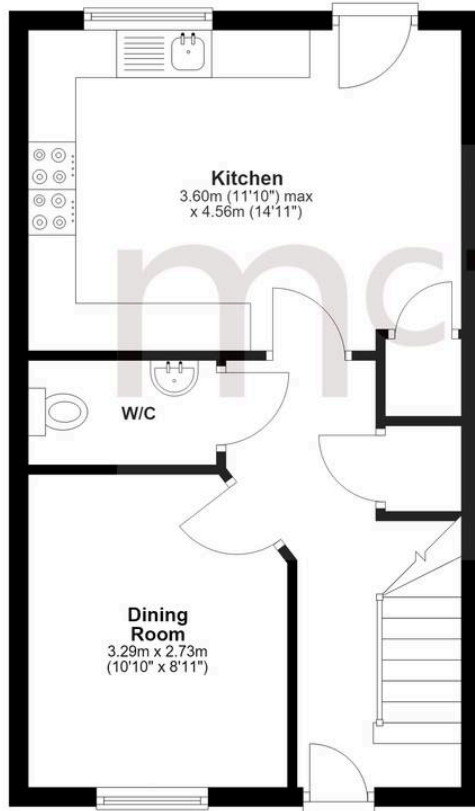

First Floor

Approx. 36.2 sq. metres (390.1 sq. feet)

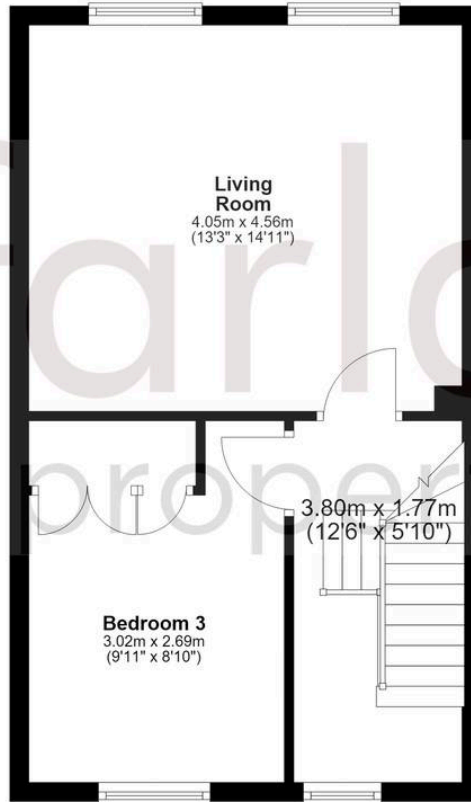

Second Floor

Approx. 35.9 sq. metres (386.3 sq. feet)

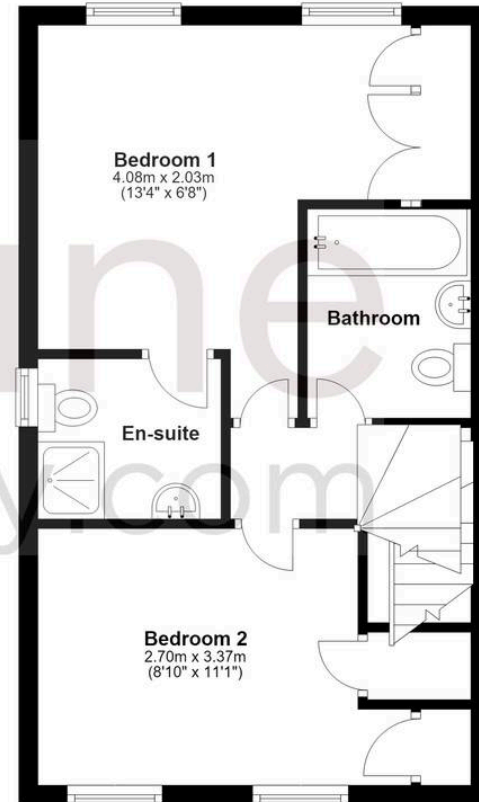

Total area: approx. 108.5 sq. metres (1168.0 sq. feet)

McFarlane Sales & Lettings

North Swindon, Redhouse Village Centre, Swindon - SN25 2FW

01793 296600 • swindon@mcfarlaneproperty.com • www.mcfarlaneproperty.com/