

Wilton Street, Bolton, BL1 8PR  
Offers In Excess Of £120,000

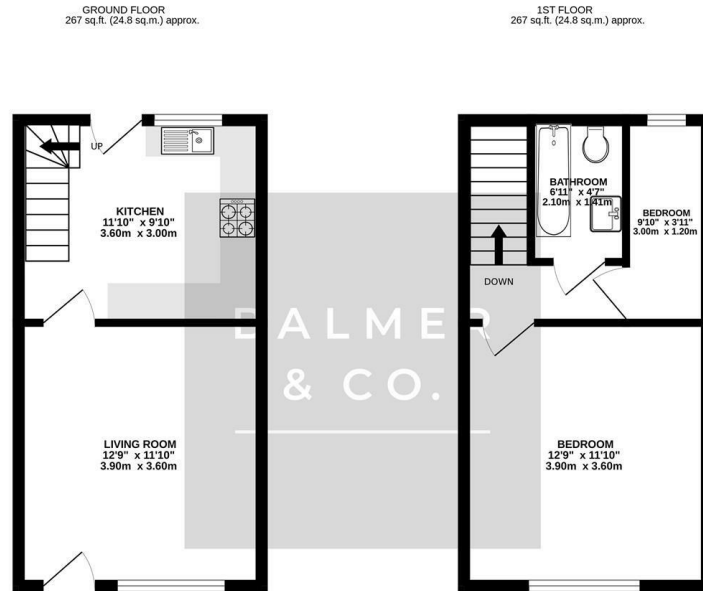

BALMER & CO in ATHERTON are delighted to offer FOR SALE this two bedroom mid terraced property located on Wilton Street, a quiet cobbled street in the Astley Bridge area of Bolton. Conveniently located within walking distance of a wide range of amenities including shops, schools, pub & restaurants as well as Asda supermarket, Nuffield Health Club and Cineworld Cinema, it would suit a wide range of buyers. The ground floor comprising in brief; lounge with feature fireplace and a fitted kitchen with an open staircase to the first floor. To the first floor you'll find a master bedroom with fitted storage and an airing cupboard where the boiler is located, a small single bedroom which would also be suitable for a nursery or office and a part tiled three piece bathroom suite. Externally, on street parking is offered to the front of the property with a enclosed garden to the rear with a raised artificial lawned area. Early viewings highly recommended, all enquiries welcome.

## Floor Plan



TOTAL FLOOR AREA: 535 sq.ft. (49.7 sq.m.) approx.  
While every attempt has been made to ensure the accuracy of the figures contained here, measurements of doors, windows, rooms and any other items are approximate and no responsibility is taken for any error, omission or misstatement. This plan is for guidance purposes only and should be used as such by any prospective purchaser. The services, systems and appliances shown have not been tested and no guarantee as to their operability or efficiency can be given.  
Made with Metrepx ©2025

## Area Map

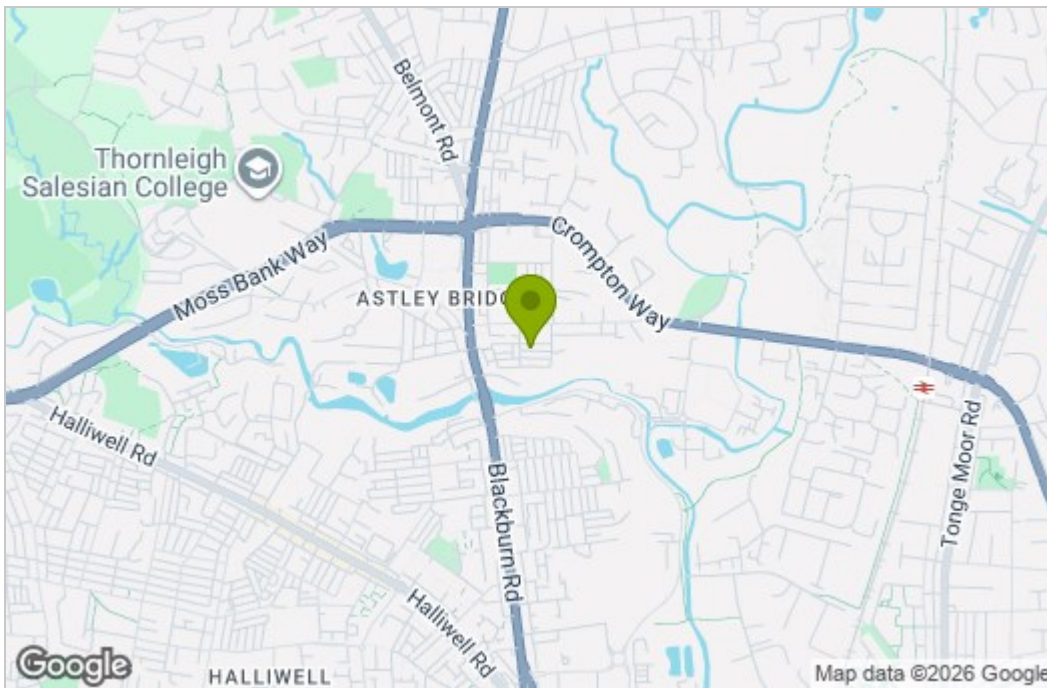

## Energy Efficiency Graph

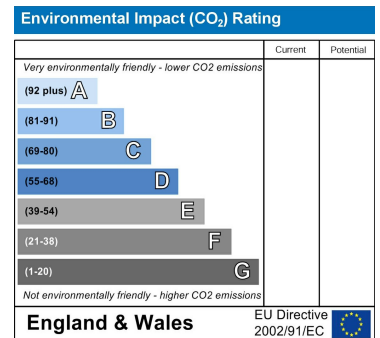
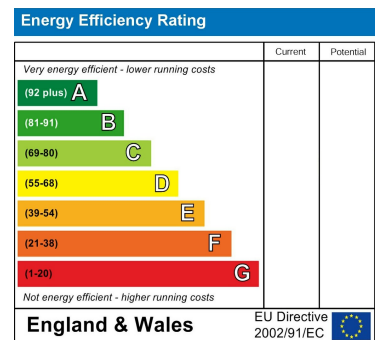

These particulars, whilst believed to be accurate are set out as a general outline only for guidance and do not constitute any part of an offer or contract. Intending purchasers should not rely on them as statements of representation of fact, but must satisfy themselves by inspection or otherwise as to their accuracy. No person in this firm's employment has the authority to make or give any representation or warranty in respect of the property.