

## Fishers Court, Horsham

Offers Over £315,000

🛏️ 2 🚿 1 🚗 1



A Centrally Located Two Bedroom Home located down a quiet Cul De Sac, boasting Allocated Parking and No Onward Chain.

Tenure: Freehold  
Council Tax Band: C  
EPC: Current D - Potential C

## Key Features

- Watch Our Video Tour
- Ideal First Time Purchase Or Investment
- Allocated Parking
- Potential To Improve
- Quiet Cul De Sac Location
- No Onward Chain
- 14'11" x 12' Living Room
- 1.2 Miles To Horsham Town Centre
- 0.9 Miles To Horsham Station
- 0.7 Miles To Horsham Park

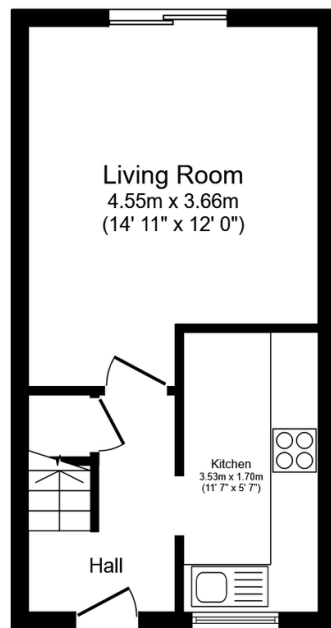

**Ground Floor**  
Floor area 27.0 sq.m. (291 sq.ft.)

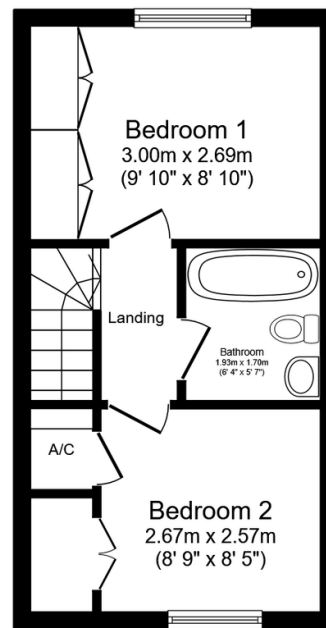

**First Floor**  
Floor area 27.0 sq.m. (291 sq.ft.)

Total floor area: 54.0 sq.m. (582 sq.ft.)

This floor plan is for illustrative purposes only. It is not drawn to scale. Any measurements, floor areas (including any total floor area), openings and orientations are approximate. No details are guaranteed, they cannot be relied upon for any purpose and do not form any part of any agreement. No liability is taken for any error, omission or misstatement. A party must rely upon its own inspection(s). Powered by [www.Propertybox.io](http://www.Propertybox.io)