



Brading Road, Brixton, SW2

2 bedroom flat - conversion for sale

£450,000

Leasehold

Property Details

A bright and airy two-bedroom period apartment on Brading Road, a quiet Victorian street with cafés, shops, pubs and eateries nearby, as well as easy access to Brixton and Herne Hill. The open-plan reception room offers space to cook, dine and relax, with modern flooring and large windows that flood the space with natural light. The kitchen is neatly positioned along one wall, maximising space without disrupting the light-filled layout. Both bedrooms are set away from the street with leafy garden views and are well sized and thoughtfully separated to provide privacy, making the home ideal for sharers or those looking to rent a room. The principal bedroom benefits from direct access to a private terrace, perfect for morning coffee or evening relaxation. The bathroom includes a bathtub with an overhead shower. Offered as a blank canvas, the apartment is ready to move into with scope to personalise. A share of freehold will be granted upon completion of the final flat.

Features

- Two bedrooms
- Private terrace
- Victorian conversion
- Bright and airy throughout
- Local amenities on the doorstep
- Brockwell Park a short stroll away
- Walking distance to Brixton and Herne Hill
- Victoria Line, Thameslink and Overground
- Chain-free
- Share of freehold will be granted

Council tax band C EPC rating C (71)



Brading Road, Brixton, SW2

Brading Road, SW2

2 Bedroom Flat

APPROXIMATE GROSS INTERNAL AREA: 547 SQ FT / 51 SQ M

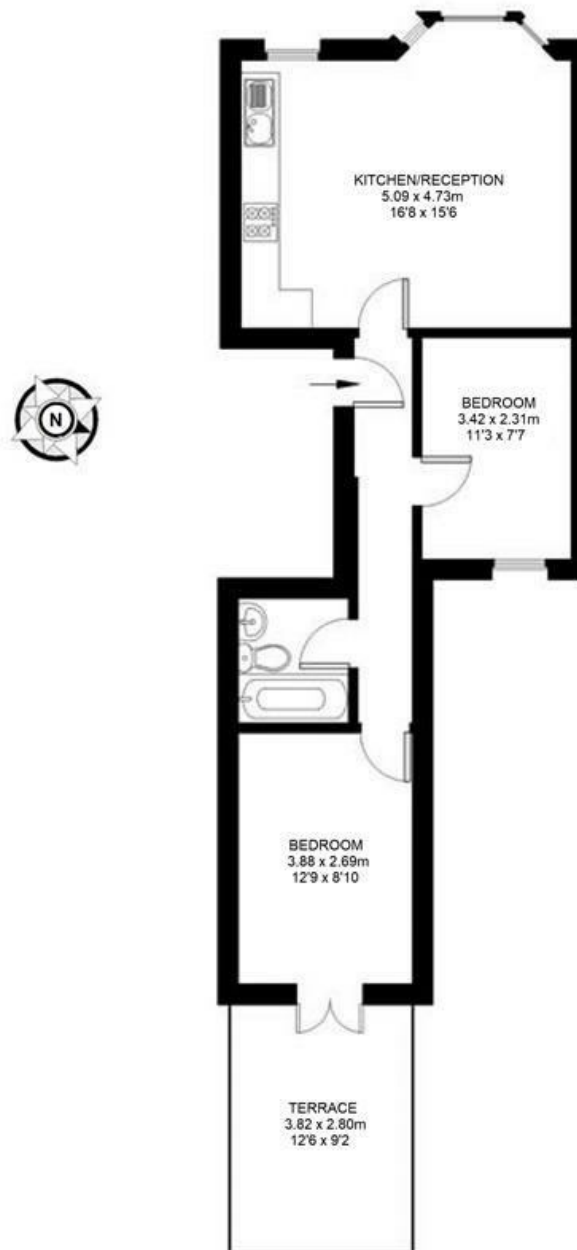

First Floor



While we try our very best, floor plans are produced as a guide only and we take no responsibility for the precise accuracy with which any property is represented.

Brading Road, Brixton, SW2

