



# Cornfield Drive, Lichfield, WS14 9UG

£380,000

3 1 2



**A beautifully presented three-bedroom detached home, offering spacious and modern living in a desirable area of Lichfield.**

**Enjoying a prime location on Cornfield Drive in Lichfield, this property offers convenient access to a wealth of local amenities. Residents will appreciate the proximity to shopping facilities, delightful cafes, and a variety of dining options. Excellent transport links ensure easy commuting to Lichfield city centre and surrounding areas, while nearby parks and green spaces provide ample opportunities for outdoor recreation. This location perfectly blends everyday convenience with a pleasant living environment.**

**The accommodation is thoughtfully arranged over two floors, beginning with a welcoming entrance porch leading into a main entrance hall. The ground floor further comprises a bright living room, a contemporary kitchen/diner, and a delightful conservatory – perfect for relaxation. To the first floor, you will find three well-proportioned bedrooms, complemented by a stylish family bathroom.**

**Early viewing is highly recommended to fully appreciate the quality, space, and ideal location this wonderful home has to offer.**



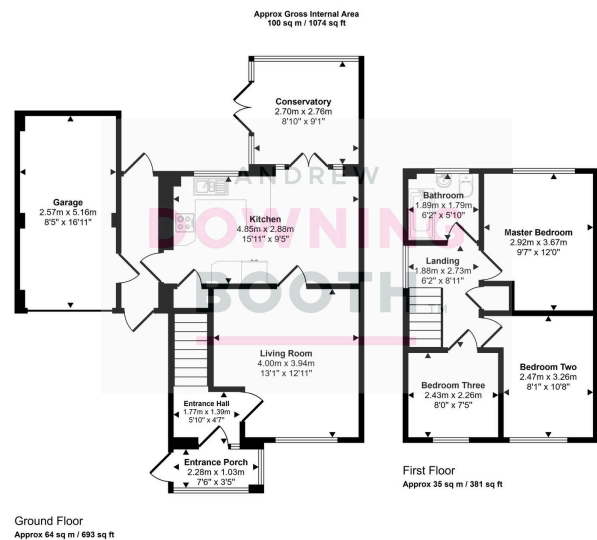

- Three Bedroom Detached Family Home
- Beautifully Presented Throughout
- Contemporary Style Kitchen/ Diner
- Spacious & Attractive Plot With Driveway
- Private Rear Garden
- Three Well-Portioned Bedrooms
- Conservatory
- Side Garage
- EPC Rating: TBC
- Council Tax Band:

