



Dale Road, KT12

£650,000

Dexters are delighted to present a two-bedroom detached bungalow set within a plot of circa 5,722 sq. ft. (531.6 sqm).

The property has been in the same family for 100 years being passed through several generations.

The property has an internal area of circa 838 sq. ft. (77.9 sqm) and features an entrance hallway, through dining room/reception room with access to the private garden, separate kitchen, two-bedrooms, a family bathroom and separate WC and includes a separate garage/workshop of circa 330 sq. ft. (30.7 sqm).

Offered with no onward chain the property has the potential for redevelopment subject to securing the necessary planning consent.

Located on a no through road, the property is within 300 meters of The Heart Shopping Centre, featuring a plethora of local shops, coffee shops, restaurants, public houses and supermarkets including Waterstones Book Shop, Caffe Nero, Wagamama, ALDI and Sainsbury's. There are numerous river walks and bike rides along the Thames which is within 200 meters. Walton-On-Thames train station is within 1.7 kilometres providing direct trains to London Waterloo.

Tenure - Freehold HM Land Registry Title Number SY871306

Features

- Freehold
- Detached bungalow
- Prior planning consent granted for new detached house
- Large garden at rear
- Off-street parking and two driveways
- No onward chain

3 Dale Road, Walton-on-Thames, Surrey KT12 2PY

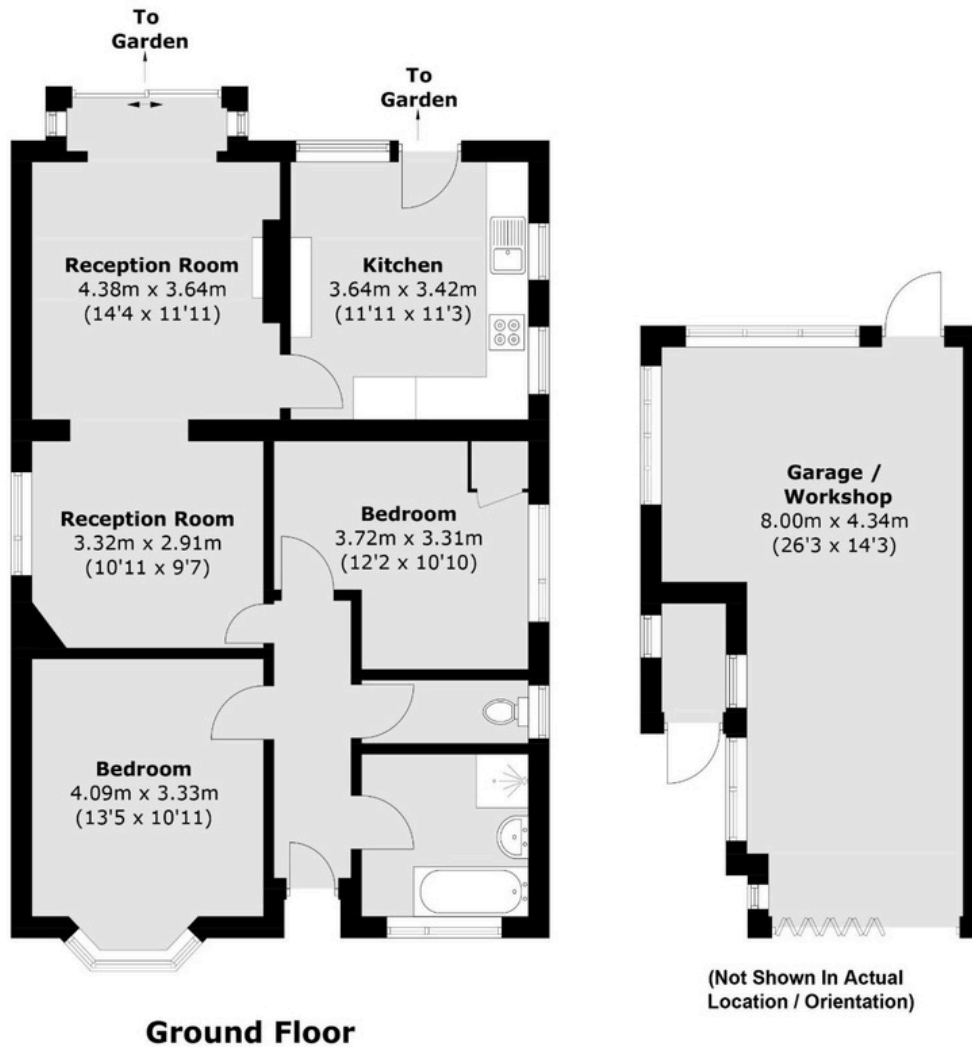

Total area (approx.): 77.9 sq. m (838.5 sq. ft)
Outbuilding: 30.7 sq. m (330.4 sq. ft)



Registered office: Mayfair Showroom, 66 Grosvenor Street, London, W1K 3JL.
Dexters London Limited, Company Registration Number 04160511

Property sales, lettings and management. Development and investment advisors. Specialist residential Chartered Surveyors.

dexters.co.uk