



5 Agra Place, Dorchester, DT1 1DZ

£190,000

- Terrace Bungalow
- Freehold
- Gas Central Heating
- Well Presented Throughout
- Heart of Dorchester
- Double Glazed
- Own Private Garden
- Two Double Bedrooms
- Vacant, No Forward Chain

5 Agra Place, Dorchester DT1 1DZ

A super opportunity to purchase a FREEHOLD two double bedroom terraced bungalow situated in a very convenient location just yards from the heart of Dorchester town centre. The property has a gated entrance through to its own courtyard garden, with front door and double opening French doors to through to the property. Well presented throughout with two double bedrooms, good size bathroom, and a large lounge/kitchen that leads out to the garden. Perfect as a first time buy or for someone that is downsizing who wants to be close to all amenities.

 2  1  1  C Council Tax Band: C



Property Details

Area

Dorchester town centre is a vibrant, historic market town in Dorset that seamlessly blends ancient Roman roots with a bustling modern high street. Characterised by its elegant Georgian architecture, leafy avenues, and pedestrian-friendly walks, the centre serves as a thriving hub for shopping, dining, and culture. The historic High Street and Cornhill feature a unique mix of independent boutiques and national brands. The town maintains its centuries-old trading tradition with a weekly market. The centre is uniquely bordered by the gorgeous, tree-lined pedestrian avenues built along the original lines of the Roman town walls—offering a quick escape into nature.

Description

Front Door through to ENTRANCE HALL, window over courtyard, doors to all rooms
LOUNGE/KITCHEN, Kitchen area with Shaker style units, built in

electric oven and hob, part tiled, space for appliances.
Lounge, with built in cupboard housing hot water boiler, French double opening with glazed side panels leading to courtyard garden.
BEDROOM ONE, double room, high ceiling with skylight
BEDROOM TWO, double room, high ceiling with skylight
SHOWER ROOM, shower cubicle, wash hand basin with vanity cupboard under, low level w.c. part tiled
OUTSIDE, own courtyard garden which is mainly decked, storage shed, outside tap.

Tenure

Freehold



Area Map

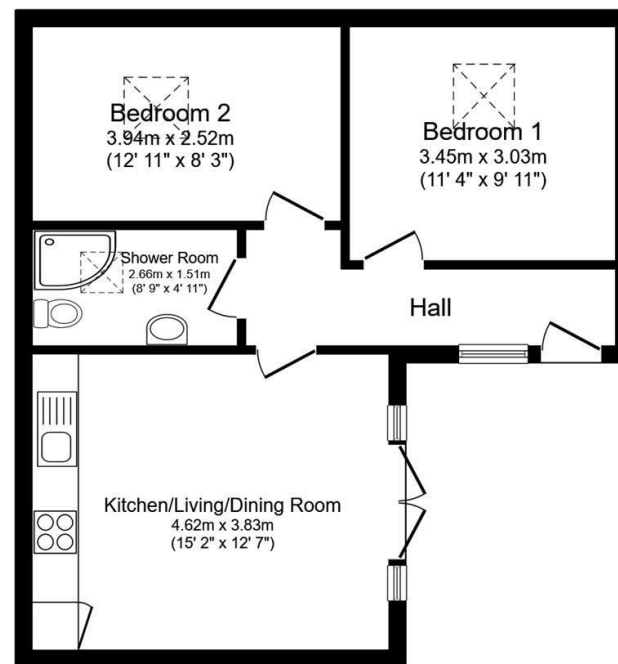
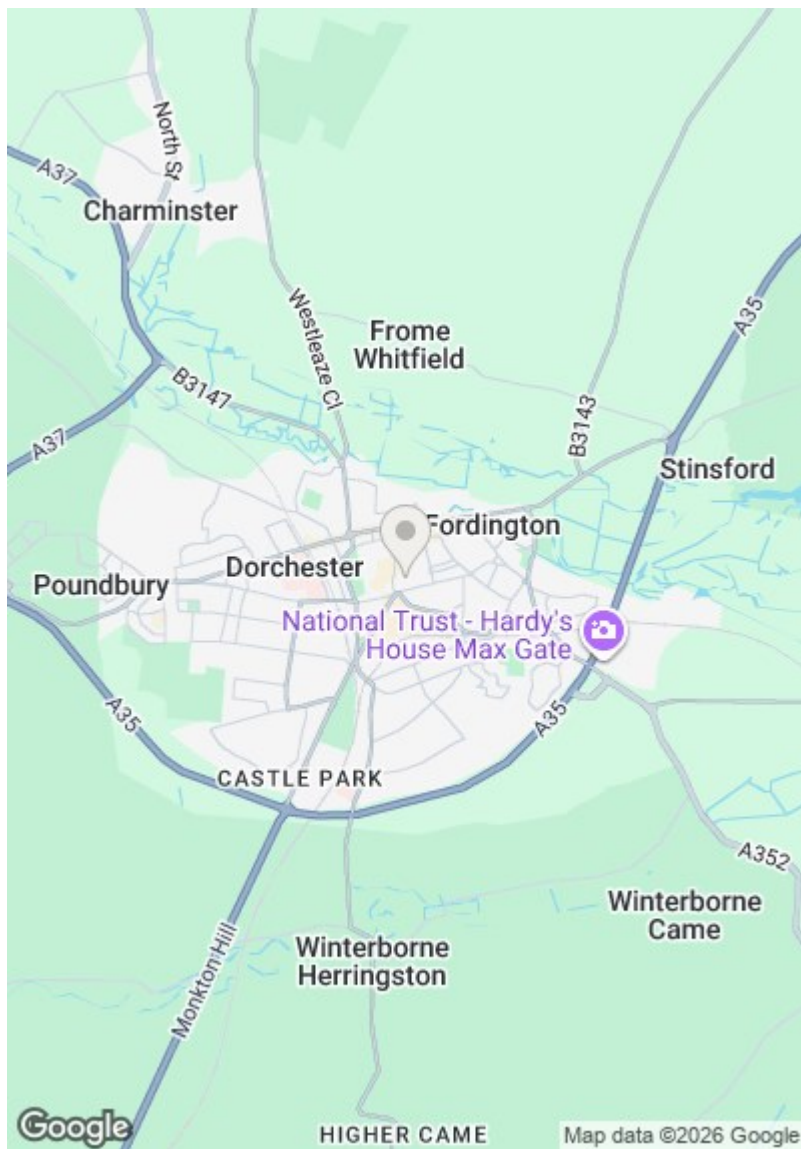

Floor Plan

Total floor area: 49.3 sq.m. (531 sq.ft.)

This floor plan is for illustrative purposes only. It is not drawn to scale. Any measurements, floor areas (including any total floor area), openings and orientations are approximate. No details are guaranteed, they cannot be relied upon for any purpose and do not form any part of any agreement. No liability is taken for any error, omission or misstatement. A party must rely upon its own inspection(s). Powered by www.Propertybox.io