



## Buckingham Gate, SW1E

£325,000

A well proportioned one bedroom flat featuring a generous reception room with a balcony, set within a secure, portered building with lift access.

Buckingham Gate is a wonderful location with St James's Park tube station and Victoria Station nearby and close to St James's Park, Green Park and Buckingham Palace.

### Features

- Short Lease 31 years
- One Bedroom
- One Bathroom
- Lift Access
- Parking
- Porter

# Buckingham Gate, London, SW1E

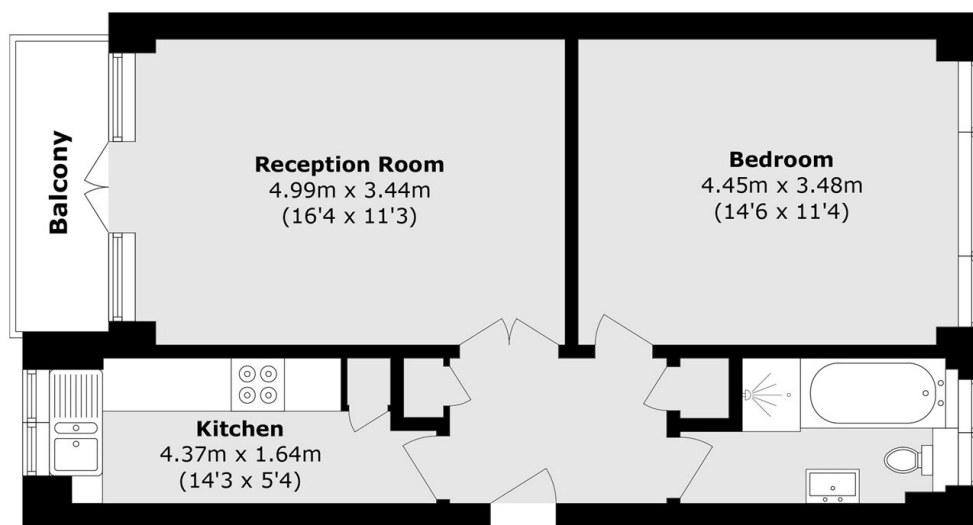

Total area (approx.): 49.7 sq. m (534.9 sq. ft)

Balcony area (approx.): 3.4 sq. m (36.6 sq. ft)