



East of 
ESTATE AGENTS

Follett Road
Topsham £375,000

Follett Road

Topsham £375,000

Nestled in a highly sought-after location in the heart of Topsham, this mid-terraced Grade 2 character cottage offers the perfect blend of period charm and modern convenience. A short stroll from the river and a range of excellent local amenities, this beautifully presented home is ideal for those downsizing, investment or first-time buyers. The property features 2 well-proportioned bedrooms, a modern kitchen, and a cosy living space enhanced by exposed beams. Outside is a private rear courtyard with useful side access to the front.

Terraced Grade 2 Listed Cottage | Two Bedrooms |
Plenty Of Character | Large Sitting/Dining Room |
Kitchen | Family Bathroom | Rear Courtyard | Side
Access | Sought After Location |

APPROACH

Part glazed front door to living/dining room.

LIVING/DINING ROOM

A welcoming, characterful room with a front-facing window set into a deep sill, with inset storage. Exposed ceiling timbers add charm and warmth, complimented by soft wall lighting. The stripped wooden floor brings a rustic feel, while the beautiful feature fireplace with its wood-burning stove set on a granite hearth creates a cosy heart to the room. A handy corner cupboard provides storage, and glass-panelled doors lead through to the kitchen and stairway, enhancing the cottage character.

KITCHEN

A bright and inviting kitchen designed with both charm and practicality in mind. Fitted with a good range of Shaker-style units in a soft cream finish, the space is complemented by sleek granite work surfaces and a solid wood breakfast bar that adds warmth and rustic character. Integrated appliances include a Bosch combi oven/microwave, with further provision for a gas hob, electric oven, under-counter fridge, and washing machine. Natural light pours in through the large Velux ceiling



window and glazed French doors, which open directly onto the garden and create an airy, cottage-style feel. The wood flooring completes the space with a touch of country elegance.

FIRST FLOOR LANDING

A charming landing area beautifully blends character and practicality, showcasing exposed wooden floorboards and rustic original doors that add warmth and period appeal. A window to the rear allows natural light to flood the stairwell, complimented by a window seat creating a welcoming and homely touch. The landing provides access to the bedrooms and shower room.

BEDROOM 1

This characterful double bedroom exudes charm with its exposed timber beams, vaulted ceiling and warm wooden flooring. A feature window with deep recess brings natural light, creating a bright and inviting atmosphere. The room is well-proportioned, comfortably accommodating a double bed alongside additional furnishings, while maintaining a cosy and homely feel.

BEDROOM 2

This elegant double bedroom combines period character with a calm, neutral decor. A feature fireplace provides a charming focal point. The room is filled with natural light from the front window. Warm wooden flooring and tasteful finishing touches complete this inviting space.

SHOWER ROOM

A modern shower room with a modern white suite comprising; a low level w.c., pedestal hand wash basin and glass sliding doors lead to a tiled corner shower enclosure with a mixer shower. The walls and floor are fully tiled. There is a window to the rear with a deep sill and obscure glass, and a modern chrome ladder style radiator.

REAR COURTYARD

The french doors from the kitchen lead out to a small courtyard garden area with a fitted timber storage shed and covered path with gate leading to front access.



AGENTS NOTES:

To the best of the Vendors knowledge, they have advised the following: -

Tenure: Freehold

Council Tax Band: Non Domestic Rates Bill 25/26

Council: Exeter City Council

Parking: Permit On Street Parking

Garden: Rear Courtyard

Electricity: Mains

Gas: Mains

Heating: To Be Confirmed

Water supply: Mains

Sewerage: Mains

Broadband: Full Fibre Broadband with up to 1600mps download and 115mps upload

Mobile Signal: Several networks currently showing as available at the property including EE and Vodafone

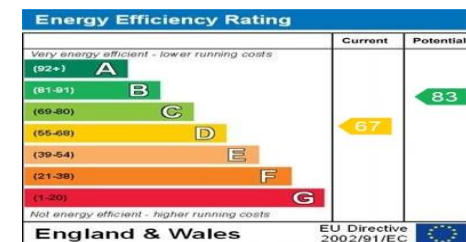
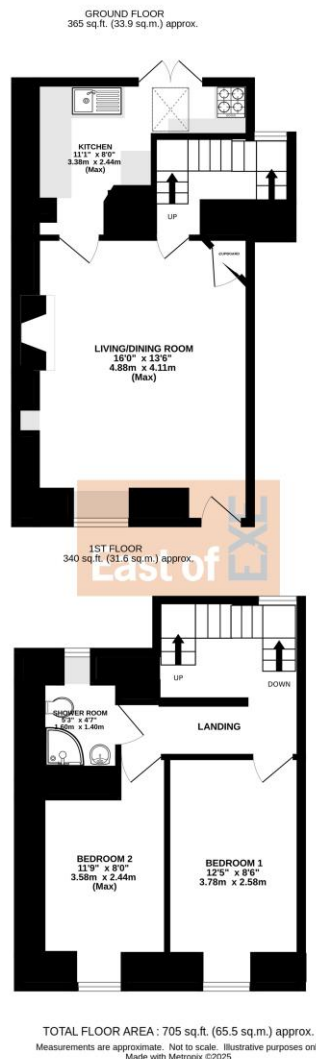

Agents Note: Whilst every care has been taken in the preparation of these sales particulars, they are for general guidance only. All measurements, descriptions and other details are approximate and should not be relied upon as statements of fact. Prospective purchasers must satisfy themselves, as to the accuracy of the information by inspection, measurement or otherwise. If inadvertently omitted or inaccurate details come to light after distribution, East and West of Exe reserves the right to withdraw, amend and reissue this brochure without notice or liability for any financial loss prior to exchange of contracts. East and West of Exe has no authority to make legal representations or warranties in relation to the property, including but not limited to boundaries, environmental matters, planning, building regulations and title matters, and cannot enter into any contract on behalf of the Vendor. All offers are subject to contract and the Vendor reserves the right to refuse any offer without giving reason. We do not accept responsibility for any expenses incurred by prospective purchasers at any stage of the transaction, in relation to properties that have been sold, let, or withdrawn. These particulars are prepared in accordance with the Consumer Protection from Unfair Trading Regulations (2008) and the Business Protection from Misleading Marketing Regulations (2008). Any material information known to the agent has been disclosed; however, buyers must make their own enquiries to confirm any details that are material to their purchasing decision.



EXETER OFFICE

18 Southernhay West Exeter EX1 1PJ

Tel: 01392 833999

enquiries@eastofexe.co.uk

www.eastofexe.co.uk

EAST DEVON OFFICE

61 Fore Street Topsham Exeter EX3 0HL

Tel: 01392 345070

enquiries@eastofexe.co.uk

www.eastofexe.co.uk

WEST OF EXE OFFICE

Main Road Exminster EX6 8DB

Tel: 01392 833999

enquiries@westofexe.co.uk

www.westofexe.co.uk

Registered in England no. 07121967