



Railway Close, Sawston Cambridge  
**£450,000** **Freehold**

**Sharman  
Quinney**

# Key Features



- Built in 2021 by award winning Hill Residential
- Modern open-plan kitchen and living space
- Principal bedroom with stylish en-suite
- Landscaped rear garden with patio area
- Off road parking with EV charging point
- Energy efficient solar panels
- Popular village location close to Whittlesford Parkway station

The property comprises an entrance hall, ground floor WC, and a contemporary fitted kitchen opening into a spacious living/dining area, with patio doors leading out to the rear garden.

Upstairs, there are three well-proportioned bedrooms, including a modern en-suite to the principal bedroom, along with a stylish family bathroom.



Outside, the rear garden is mainly laid to lawn with a patio seating area and convenient side access. The property also benefits from off-road parking, an EV charging point, and solar panels fitted to the roof.

Situated in the ever-popular village of Sawston, the area is ideal for families and commuters alike, offering a wide range of local amenities. Nearby Whittlesford Parkway railway station provides excellent transport links to Cambridge and London.



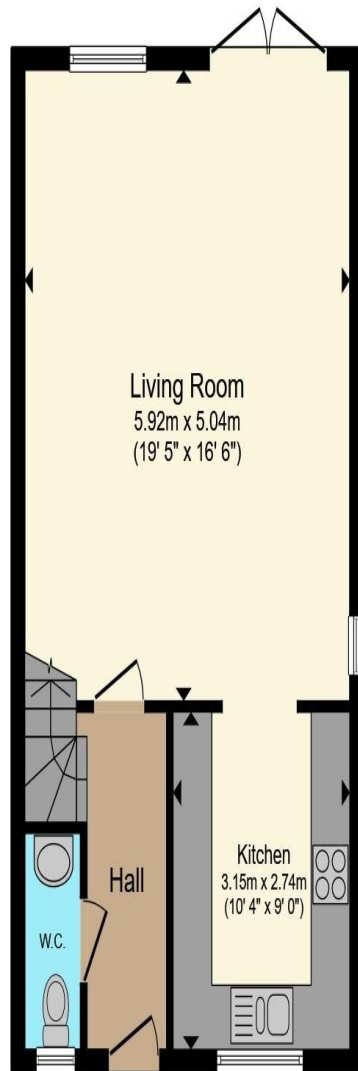

**Ground Floor**

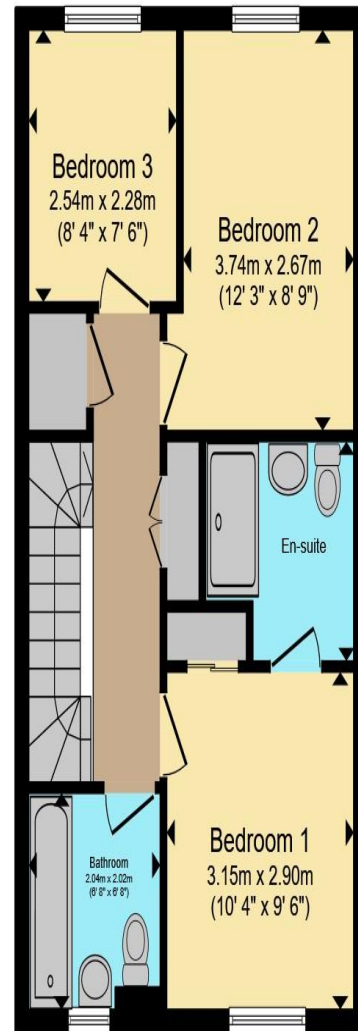

**First Floor**

Total floor area 92.1 m<sup>2</sup> (992 sq.ft.) approx

This floor plan is for illustrative purposes only. It is not drawn to scale. Any measurements, floor areas (including any total floor area), openings and orientation are approximate. No details are guaranteed, they cannot be relied upon for any purpose and they do not form part of any agreement. No liability is taken for any error, omission or misstatement. A party must rely upon its own inspection(s). Powered by [www.propertybox.io](http://www.propertybox.io)

**Sharman  
Quinney**

To view this property call Sharman Quinney on:  
**01223 844760**

# Selling your property?

Contact us to arrange a **FREE** home valuation.

 01223 844760

 49 Woollards Lane, Great Shelford, CAMBRIDGE,  
Cambridgeshire, CB22 5LZ

 [greatshelford@sharmanquinney.co.uk](mailto:greatshelford@sharmanquinney.co.uk)

 [www.sharmanquinney.co.uk](http://www.sharmanquinney.co.uk)



 SCAN ME



Sharman Quinney Holdings Limited is registered in England and Wales under company number 4174227, Registered Office is Cumbria House, 16-20 Hockliffe Street, Leighton Buzzard, Bedfordshire, LU7 1GN. VAT Registration Number is 500 2481 05.

1: These particulars do not constitute part or all of an offer or contract. 2: The measurements indicated are supplied for guidance only and as such must be considered incorrect. 3: Potential buyers are advised to recheck the measurements before committing to any expense. 4: Sharman Quinney has not tested any apparatus, equipment, fixtures, fittings or services and it is the buyers interests to check the working condition of any appliances. 5: Sharman Quinney has not sought to verify the legal title of the property and buyers must obtain verification from their legal representative. 6: Intending purchasers will be asked to produce identification documentation at a later stage and we would ask your co-operation in order that there will be no delay in agreeing the sale. Ref: GTS103188 - 0001

