



Taylor Close, TW3

£250,000

A purpose built two bedroom apartment situated on the ground floor of a highly popular development. The property benefits from allocated parking, communal gardens and no onward chain.

Conveniently situated for local amenities, schools and parks. Both Osterley (tube) and Isleworth train stations are within short walking distance and offer excellent transport links in and out of London.

Features

Ground Floor Apartment
Two Bedrooms
Allocated Parking
Communal Gardens
No Onward Chain
Close To Amenities

Taylor Close, Hounslow, TW3

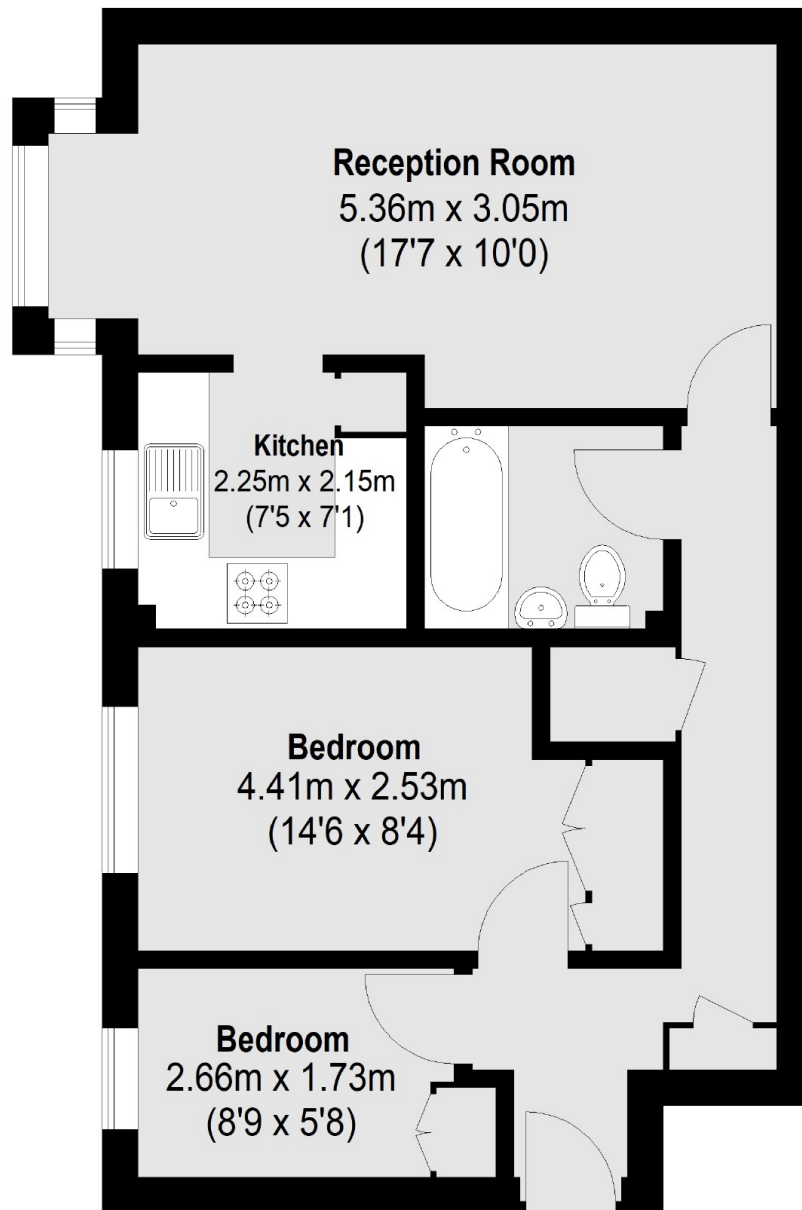

Ground Floor

Total area (approx.): 51.03 sq. m (549 Sq. ft)