



**DavidJames**  
the estate agent

**First Avenue, Carlton, Nottingham, NG4 1PD**

**£1,300 Per Calendar Month**

## About This Property

Located in the popular area of Carlton is this spacious detached family home, with excellent access to local amenities and transport links. The property features a generous living room, while the kitchen diner is well-equipped with appliances and provides ample room for dining. Upstairs, there are three well-proportioned bedrooms, with bedrooms one and two benefiting from built-in storage, alongside a 3 piece suite bathroom fitted with an electric shower over the bath. Externally, the home enjoys a large, low-maintenance rear garden complete with a decking area, as well as a separate garage and private driveway offering off-road parking.

### TENANCY DETAILS

Available From: Now

Tenancy Term: Minimum 6 months (12 months preferred)

Furnishing: Unfurnished

EPC Rating: D

Council Band: C

Pets: Considered

- Spacious detached house in Carlton
- Large living room
- Kitchen diner with appliances
- Three well-proportioned bedrooms
- Built-in storage to bedrooms one and two
- Bathroom with electric shower over bath
- Full double glazing and gas central heating
- Large, low-maintenance rear garden
- Separate garage and private driveway
- Close to Carlton Hill amenities and public transport







**Entrance Hall**  
1.30 x 1.36 m  
4'3" x 4'5"

Floor 0 Building 1

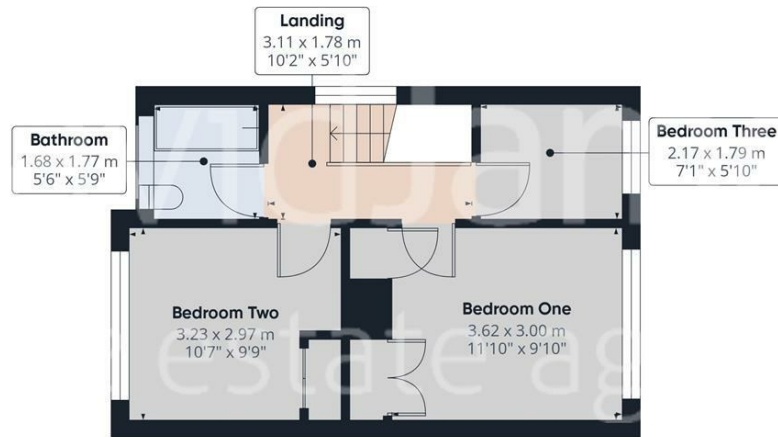

Floor 1 Building 1



**Approximate total area<sup>(1)</sup>**

68.8 m<sup>2</sup>  
741 ft<sup>2</sup>

**Reduced headroom**

1.1 m<sup>2</sup>  
12 ft<sup>2</sup>

(1) Excluding balconies and terraces

**Reduced headroom:**

Below 1.5 m/5 ft

Calculations reference the RICS IPMS 3C standard. Measurements are approximate and not to scale. This floor plan is intended for illustration only.

GIRAFFE360

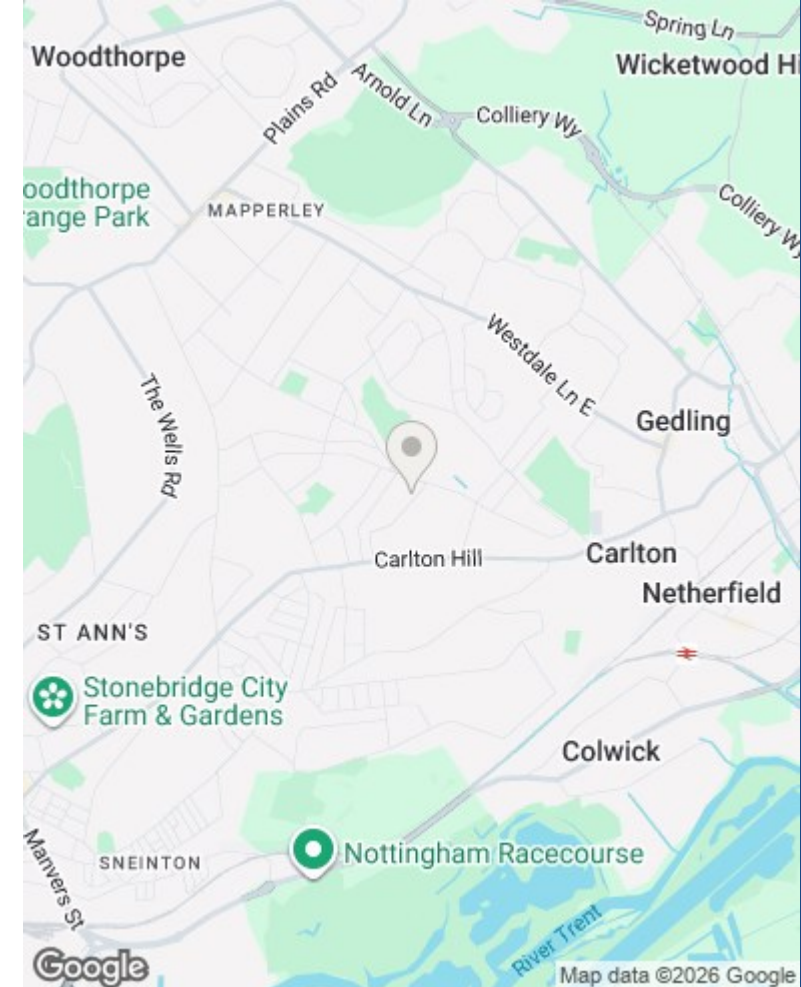

**Council Tax Band: C**  
**Gedling Borough Council**

These particulars are produced in good faith, are set out as a general guide only and do not constitute any part of a contract. No person in the employment of David James Estate Agents Ltd has any authority to make any representation whatsoever in relation to the property. All services, together with electrical fittings or fitted appliances have NOT been tested. All the measurements given in the details are approximate. Floor plans are for illustrative purposes only and are not drawn to scale. The position and size of doors, windows, appliances and other features are approximate only. The photographs of this property have been taken with a 10mm wide-angle lens. No responsibility can be accepted for any loss or expense incurred in viewing. If you have a property to sell you may wish to take advantage of our free valuation service. David James Estate Agents have established professional relationships with third-party suppliers for the provision of services to Clients. As remuneration for this professional relationship, the agent receives referral commission from the third-party company. David James Estate Agents receives the following commission from each third party supplier on a per referral basis: W A Barnes Ltd: £60 including VAT. All Moves UK Ltd: 18% including VAT of the invoice total (£107 including VAT average). MoveWithUs Limited: £188 including VAT (average).

**DavidJames**  
the estate agent

David James Estate Agents  
45b Plains Road, Mapperley, Nottingham, NG3 5JU  
t: 0115 962 4213 e: lettings@david-james.com

naea | propertymark  
**PROTECTED**

