

TAYLOR
MICHAEL

SALES & LETTINGS

2 Bed
Flat
located in

£1,550 Per month



TAYLOR
MICHAEL

Portland Avenue, Hove BN3 5NG

Approximate Gross Internal Area = 61.3 sq m / 660 sq ft

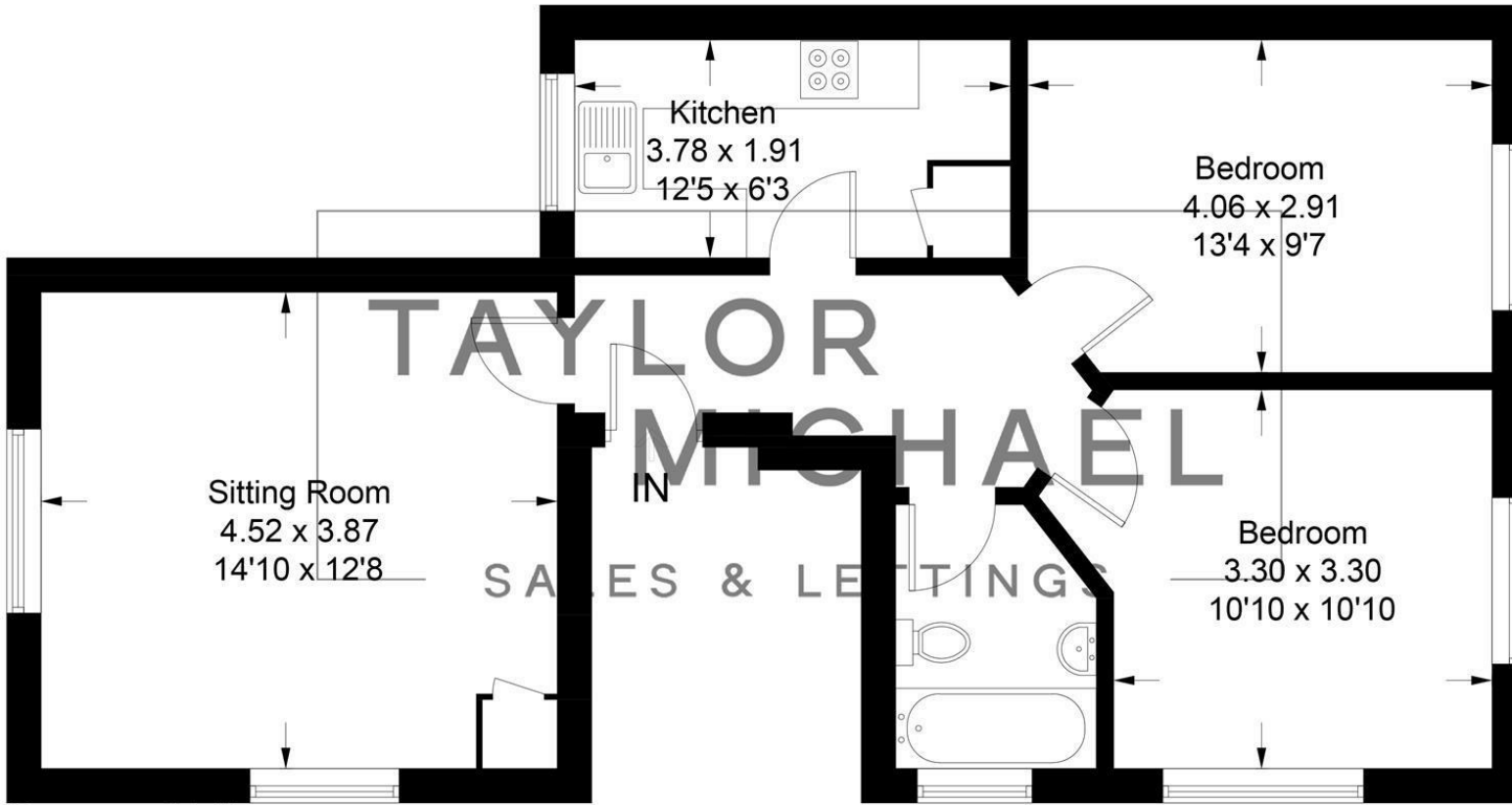

Second Floor

Illustration for identification purposes only, measurements are approximate, not to scale.
Imageplansurveys @ 2026

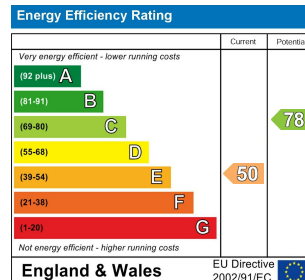

DIRECTIONS

CONTACT

62 Church Road
Hove
East Sussex
BN3 2FP

E: lettings@taylormichael.agency
T: 01273 600100
<https://taylormichael.agency/>

TAYLOR MICHAEL