



24 Laleham Green, Bramhall - SK7 3LJ
£1,200 PCM

mosley jarman 

24 Laleham Green

Bramhall, Stockport

Semi-detached home in a cul-de-sac with conservatory, two double bedrooms, driveway, front and rear gardens. Part furnished. Ideal for couples or young families. Available immediately.

Set in a cul-de-sac location and providing accommodation which would suit a professional couple or young family alike, is this semi-detached property with the added benefit of a conservatory. An internal inspection will briefly reveal: Entrance hall, living room, fitted kitchen and the added benefit of a conservatory, which could be used for a wide range of things, such as a dining room, additional entertaining room or playroom. On the first floor, a landing provides access to two DOUBLE bedrooms and bathroom with a three piece suite and a shower over the bath with glazed shower screen. Outside a driveway is provided to the front for private off road parking. There is also a small lawned area. To the rear, a lawned garden leads up to a raised decked area. PART FURNISHED. AVAILABLE: IMMEDIATELY





24 Laleham Green

Bramhall, Stockport

- Parking - Driveway providing off road parking
 - Heating - Gas central heating
 - Mains - Gas, electric, water and drainage
 - EPC rating - C (71/75)
 - Council Tax band - B (Stockport).
 - Refuse - Stockport Council operate a chargeable garden waste disposal service. For full details please visit www.stockport.gov.uk/garden-waste
 - **Flood Risk - There is a very low flood risk for this property.
 - *Broadband providers - Openreach. You may also be able to obtain broadband service from these Fixed Wireless Access providers covering your area for Virgin Media
 - *Mobile providers- Mobile coverage at the property available with all main providers
 - * From Ofcom checker & isn't guaranteed. Mosley Jarman take no responsibility for inaccuracies & advise tenants do their own checks before committing to renting. **
- Information provided by GOV.UK





GROUND FLOOR

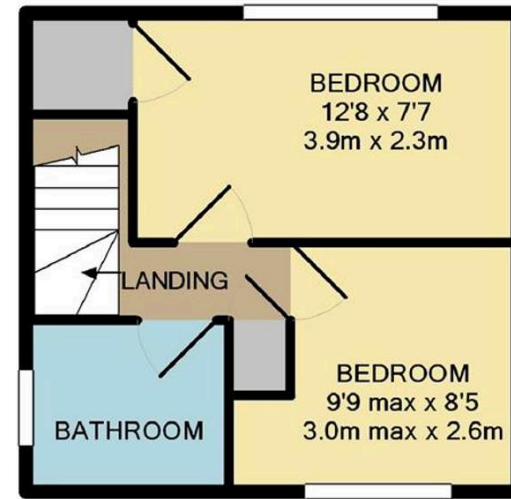

1ST FLOOR

Whilst every attempt has been made to ensure the accuracy of the floor plan contained here, measurements of doors, windows, rooms and any other items are approximate and no responsibility is taken for any error, omission, or mis-statement. This plan is for illustrative purposes only and should be used as such by any prospective purchaser. The services, systems and appliances shown have not been tested and no guarantee as to their operability or efficiency can be given
Made with Metropix ©2018

Mosley Jarman

Mosley Jarman, 226 Moss Lane - SK7 1BD

01614395658 • bramhall@mosleyjarman.co.uk • www.mosleyjarman.co.uk/

PROPERTY MISDESCRIPTIONS ACT 1991: The Agents has not tested any apparatus, equipment, fixtures and fittings, or services, so cannot verify that they are in working order or fit for the purpose. The buyer is advised to obtain verification from his or her Professional Buyer. References to the Tenure of the property are based on information supplied by the Vendor. The agents have not had sight of the title documents. The buyer is advised to obtain verification from their Solicitor. You are advised to check the availability of any property before travelling any distance to view.