



211 Milton Road

, Southsea, PO4 8PH

Offers in excess of £265,000



211 Milton Road

, Southsea, PO4 8PH

Offers in excess of £265,000



Welcome to Milton Road...

Offered with NO FORWARD CHAIN, we are delighted to bring to the market, this excellent three bedroom bay & forecourt home, situated in the sought after area of Milton. Boasting two reception room, a modern kitchen, two bathrooms, and being within close proximity to many local amenities, good schools, Milton common and Southsea seafront - this is an excellent purchase.

This charming and well presented property seamlessly blends timeless period features with contemporary touches, offering a warm and welcoming home.

On the ground floor, the accommodation begins with a bright and airy bay fronted lounge, flooded with natural light and centred around a beautiful open fireplace, perfect for cosy evenings.

Adjacent to the lounge is a generously sized dining room, which flows effortlessly into a stylish and modern kitchen. There is ample space for a family dining table, sofas and other furnishings. The kitchen itself is complete with a range of wall and floor mounted units, integrated oven and grill, hob with extractor and there is plumbing for washing facilities.

Also located on the ground floor is a convenient shower room and a separate toilet, providing flexibility for busy households and added practicality for guests.

Upstairs, the property continues to impress, offering three well proportioned double bedrooms, all offering

space for large beds and other furnishings.

The tiled family bathroom features a bath, toilet, sink and towel radiator.

Outside, the property boasts a generously sized rear garden, with patioed and decking areas great for garden furniture. It also benefits from rear access to Bonchurch Road.

Additional benefits of the property is gas central heating and double glazing throughout.

Situated on Milton Road, you are within close proximity to Milton common and park, as well as a range of local amenities including good schools, cafes and shops.

With its blend of period charm, modern updates, and practical living spaces, this beautifully maintained property offers a great property opportunity.

Please contact the office to arrange your viewing.

- THREE BEDROOMS
- BAY & FORECOURT HOME
- TWO RECEPTION ROOMS
- BATHROOM & DOWNSTAIRS SHOWER ROOM
- PERIOD FEATURES
- CLOSE TO MILTON COMMON & SOUTHSEA



Road Map

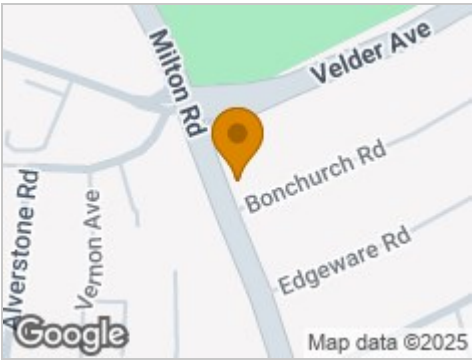

Hybrid Map



Terrain Map



Floor Plan

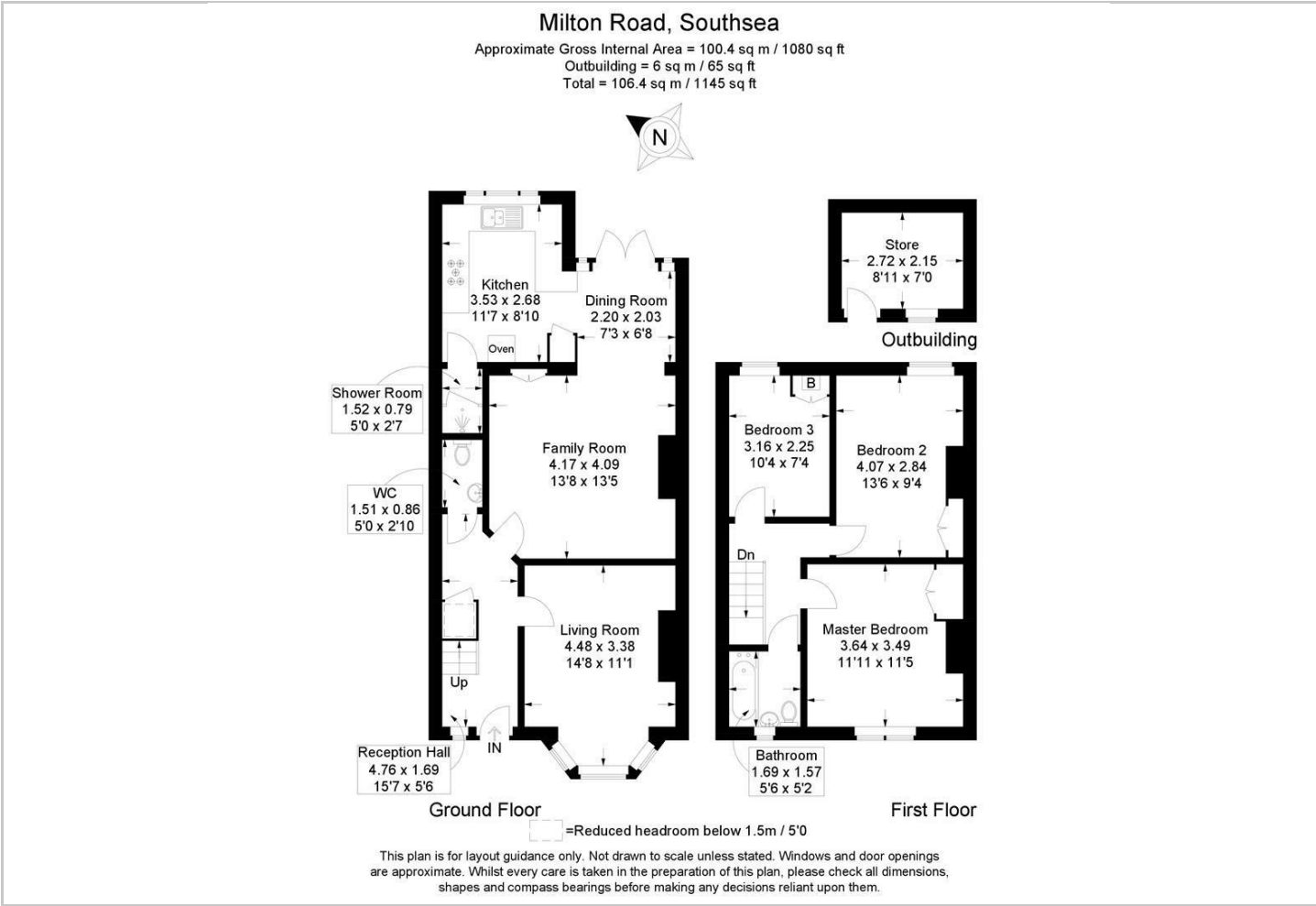

Viewing

Please contact our Central Office on 02394 217317 if you wish to arrange a viewing appointment for this property or require further information.

Energy Efficiency Graph

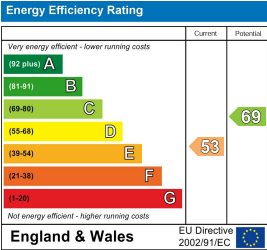

These particulars, whilst believed to be accurate are set out as a general outline only for guidance and do not constitute any part of an offer or contract. Intending purchasers should not rely on them as statements of representation of fact, but must satisfy themselves by inspection or otherwise as to their accuracy. No person in this firm's employment has the authority to make or give any representation or warranty in respect of the property.