

Old Road, Clacton On Sea CO15

£600 pcm | £7,200 PA

Priory Estates are delighted to offer this commercial unit located just on the outskirts of Clacton town centre. At approximately 484 Sq Ft, this retail unit benefits from ample footfall, especially during the summer months and is available now.

Services: All services to be transferred into the ingoing tenants' name.

Current Usage: Planning will need to be sought for change of usage via Tendring District Council.

Business Rates: Tendring District Council will provide this information

Old Road, Clacton

Approximate Gross Internal Area
484 sq ft - 45 sq m

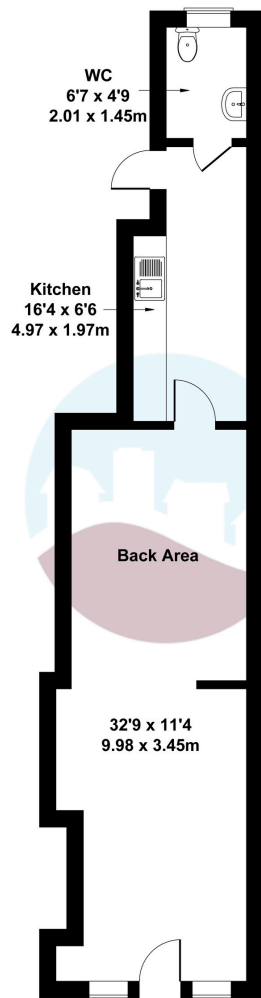

GROUND FLAT SHOP

Not to Scale. Produced by The Plan Portal 2026
For Illustrative Purposes Only.

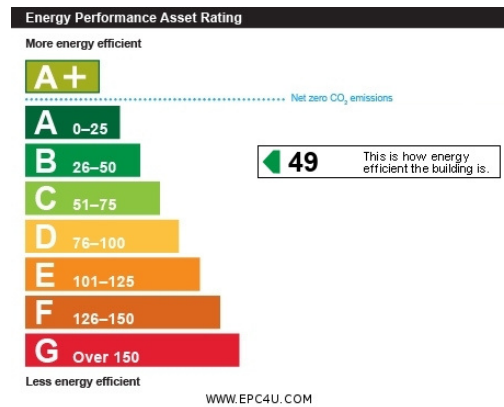

Financial Requirements: A deposit equivalent to 3 months' rent is required in cleared funds prior to the commencement of the lease. Legal and Administration Fee: £300.00 plus VAT

Agents Note: Whilst every care has been taken to prepare these particulars, they are for guidance purposes only. All measurements are approximate, are for general guidance purposes only and whilst every care has been taken to ensure their accuracy they should not be relied upon and potential tenants are advised to recheck the measurements.