



Vanessa Newman
Property Agents

Tel: 01480 260 944
27a New Street, St. Neots,
Cambridgeshire, PE19 1AE
info@vnpa.uk



ALAMEIN COURT, EATON FORD, PE19 7JL

GUIDE PRICE £330,000

A beautifully presented three-bedroom semi-detached family home, ideally situated in the highly sought-after area of Eaton Ford. The property falls within the catchment area for Crosshall Junior School and is just a short walk from the town centre and picturesque riverside park.

Lovingly maintained by the current owner, this exceptional home offers generous and versatile living accommodation, perfectly suited to modern family life.

The ground floor comprises an inviting entrance porch leading into a contemporary open-plan lounge/dining room. Large sliding patio doors provide an abundance of natural light and open onto the beautifully landscaped private rear garden, creating an ideal space for both relaxing and entertaining.

The refitted kitchen is well-appointed with a range of high- and low-level soft-close units, an electric hob and oven, and space for a washing machine, dishwasher, and fridge freezer.

The first floor offers three well-proportioned bedrooms, along with a stylishly refitted family bathroom.

Further benefits include modern double glazing throughout and a replacement combination boiler serving the gas central heating system.

Externally, the property enjoys a private driveway providing off-road parking for up to two vehicles together with a garage offering valuable additional storage space.

This is a fantastic opportunity to acquire a superb family home in one of Eaton Ford's most desirable locations.

Early viewing is highly recommended.









Alamein Ct Eaton Ford, St. Neots, PE19 7JL

Approximate Gross Internal Area
69.7 sq m / 750 sq ft

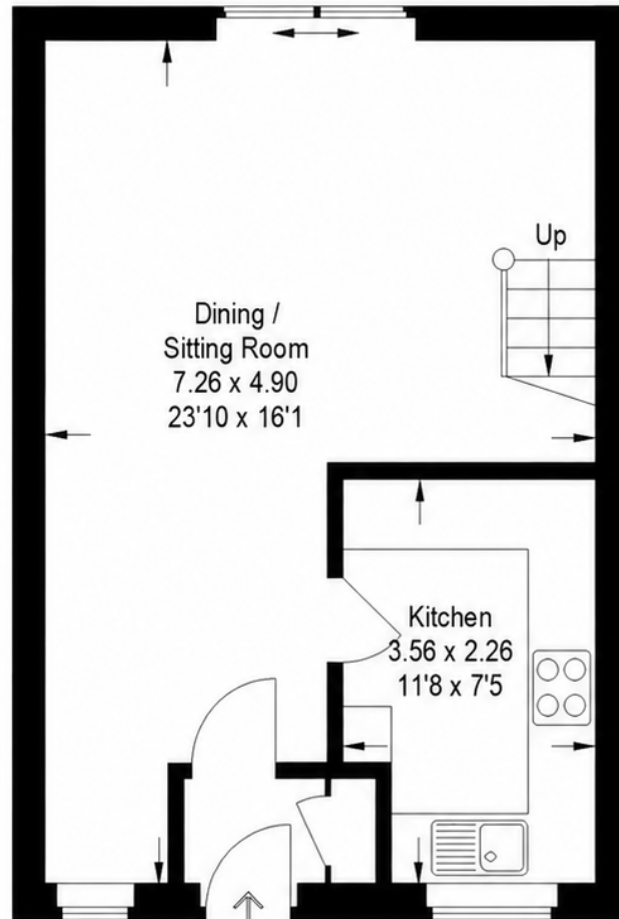

Ground Floor

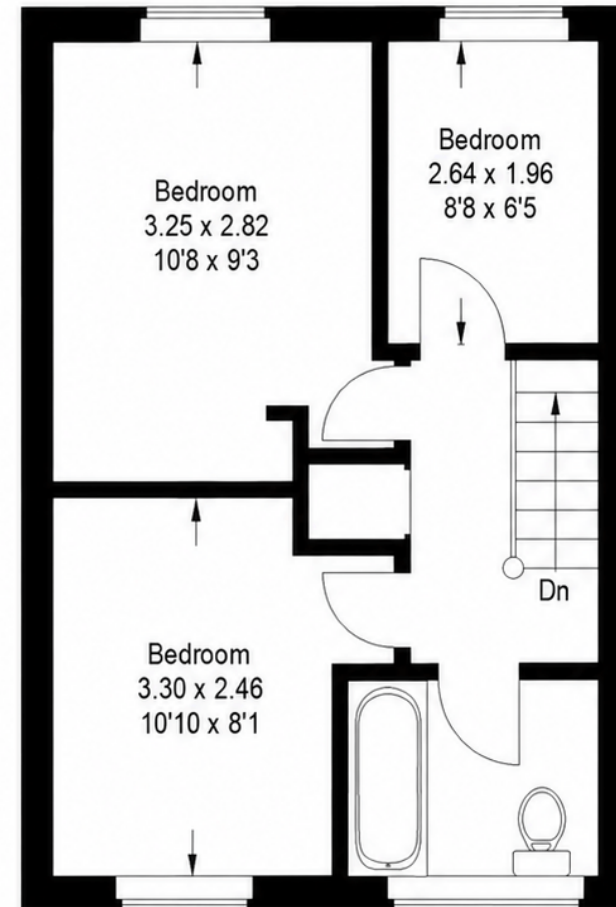

First Floor

This plan is for layout guidance only. Not drawn to scale unless stated. Windows and door openings are approximate. Whilst every care is taken in the preparation of this plan, please check all dimensions, shapes and compass bearings before making any decisions reliant upon them. (ID 836694)

