



Mcmillan Street, SE8

£250,000

A well-presented studio apartment set within a modern development in a highly sought-after location. Finished to a high standard, this property further benefits from no onwards chain.

Turner House is perfectly located a short walk from Deptford Bridge DLR, giving access to Canary Wharf in 15 minutes and Bank under 30 minutes. Deptford high street is close by with its array of shops, restaurants and amenities, as well as both Greenwich and Blackheath.

Features

Sought After Location
Chain Free
Ideal First Purchase
Modern
Studio Flat

Mcmillan Street, London, SE8

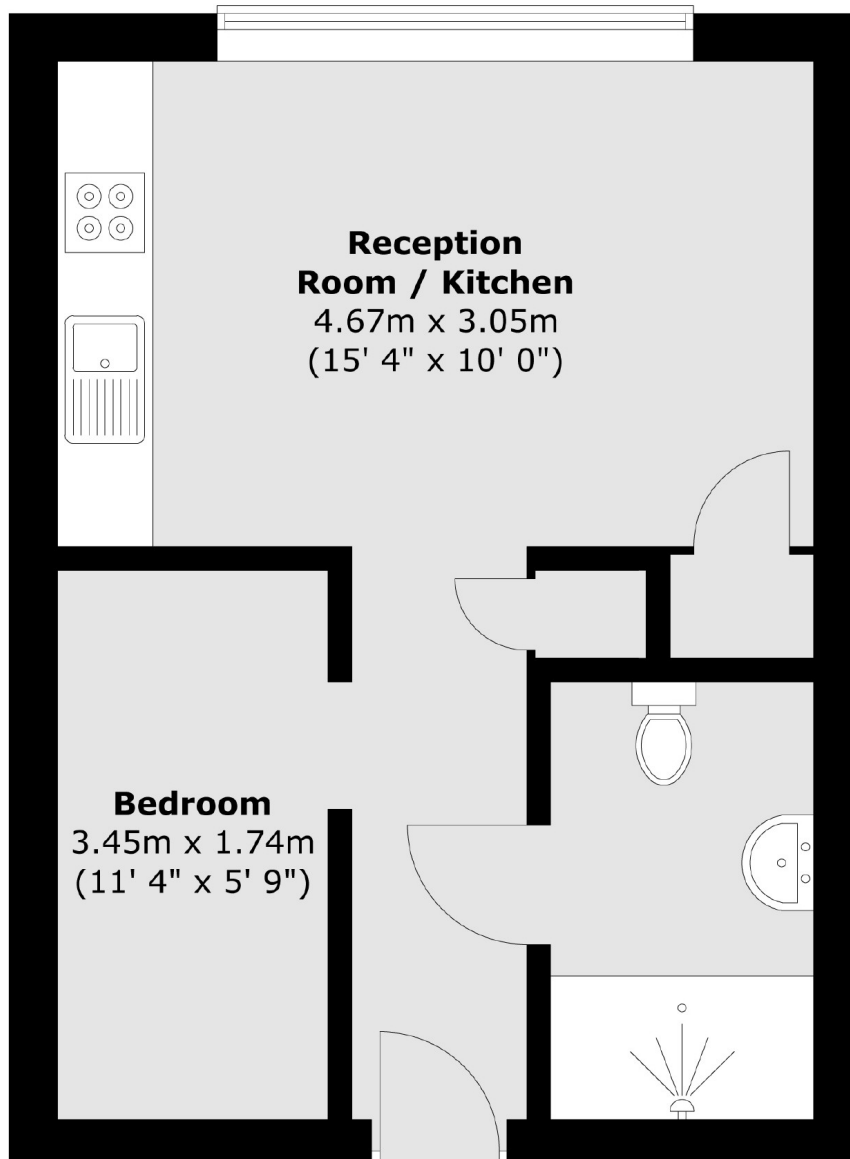

Total area (approx.) : 31.7 sq. m (341 sq. ft)