



## Berrymead Gardens, W3

£299,950

A newly converted one bedroom ground floor apartment in immaculate condition with a private entrance and access to a low maintenance terrace. The property has lots of natural light and will be sold with a new lease and no onwards chain.

Half a mile from Acton Central and South Acton stations (Overground) and under three quarters of a mile from Acton Town tube station (District and Picadilly lines).

### Features

- One Double Bedroom
- Private Entrance
- Long Lease
- Newly Converted
- Terrace
- No Onwards Chain

# Berrymead Gardens, London, W3

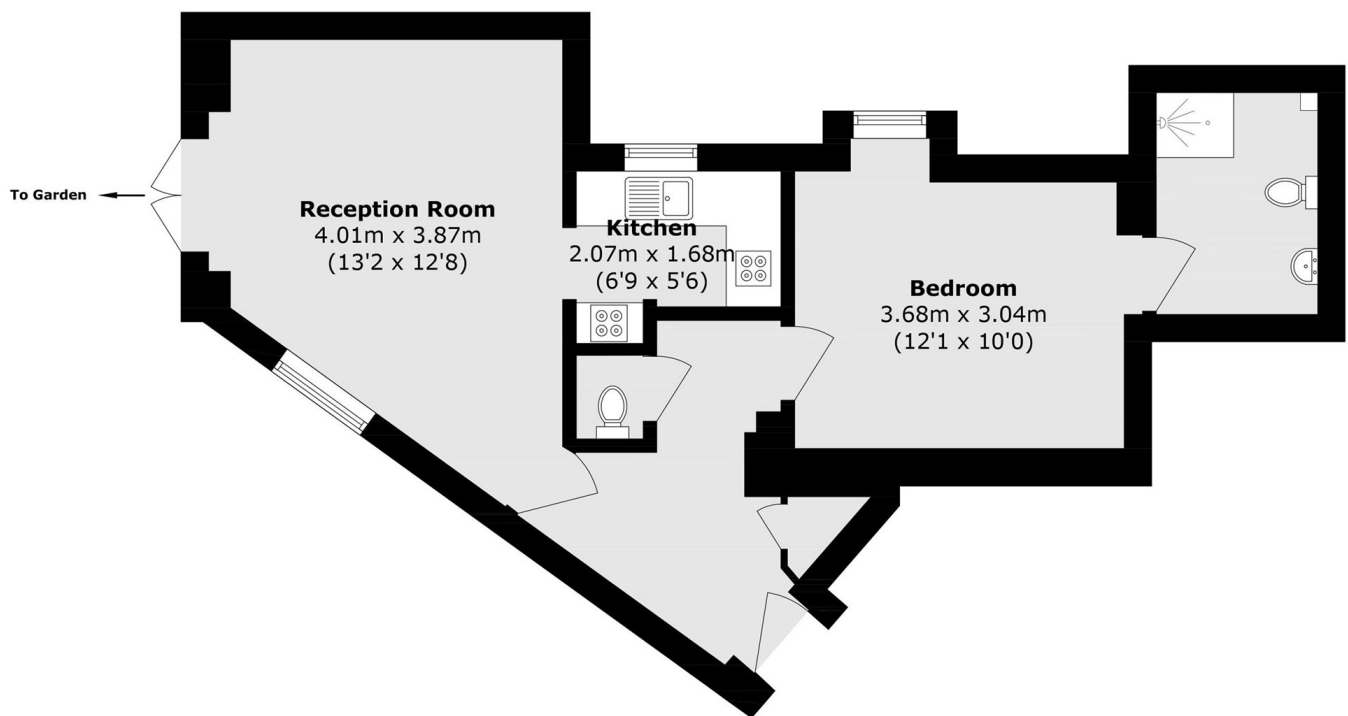

Total area (approx.): 45.4 sq. m (488.6 sq. ft)