



## Wharncliffe Mews, SW4

£410,000

Set within a peaceful and secluded mews, this superbly refurbished ground-floor apartment offers stylish, contemporary living along with the added advantage of a spacious private garden. The accommodation comprises a bright and well-sized reception room opening directly onto the garden, perfect for indoor-outdoor living. The kitchen is fully integrated and thoughtfully designed with a modern finish. The property also benefits from a generous double bedroom with fitted wardrobes, alongside a sleek, newly fitted bathroom. Additional features include a long lease and no onward chain.

Wharncliffe Mews is ideally situated for the many local boutique shops, restaurants and bars of Abbeville Village, the green open spaces of Clapham Common & Clapham South station are also just a short walk away.

### Features

- Modern Apartment
- South West Facing Garden
- Large Reception Room
- Modern Kitchen
- Double Bedroom
- Long Lease

# Wharncliffe Mews, London, SW4

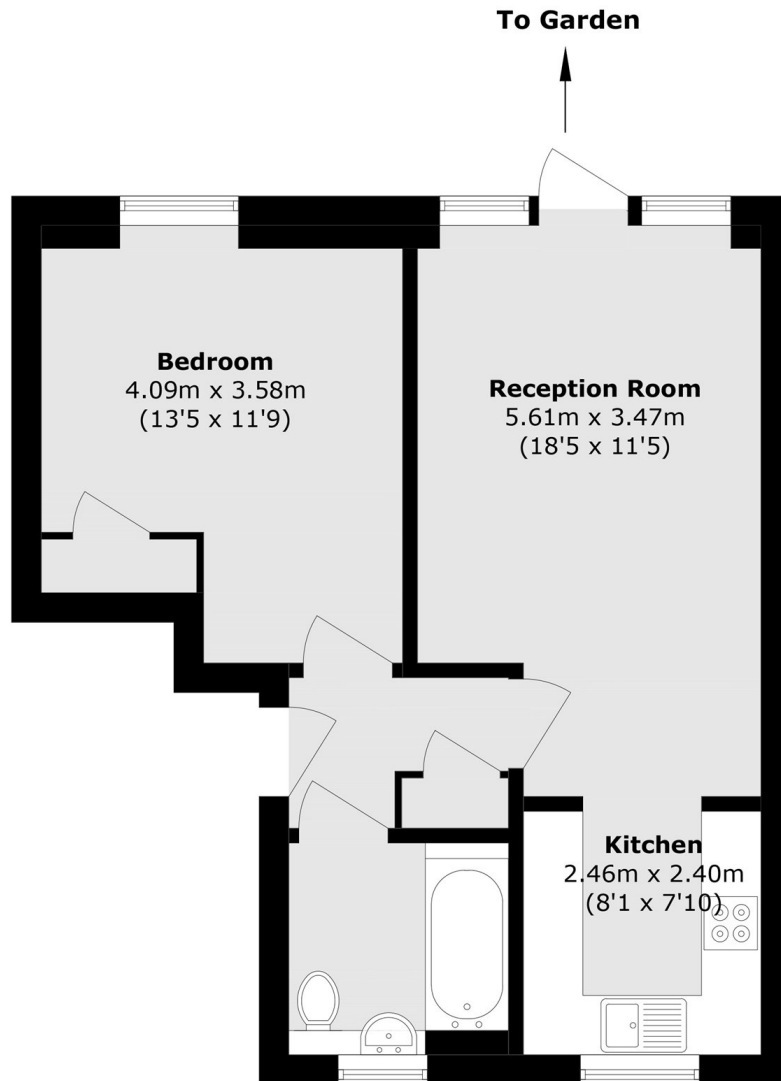

Total area (approx.): 49.8 sq. m (536.0 sq. ft)