

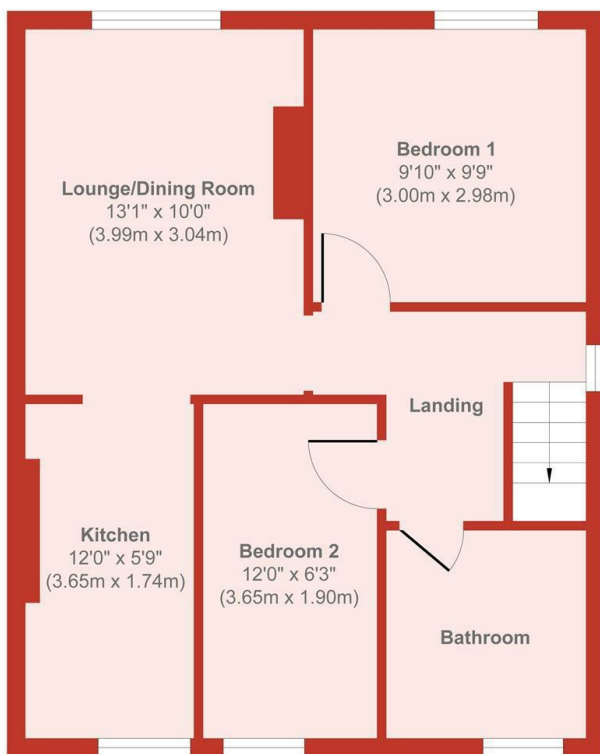

Cynthia Road, Poole, BH12 3JE

£235,000

- Two Bedrooms
- Good Size Private Rear Garden
- Share Of Freehold
- No Forward Chain
- First Floor Maisonette
- UPVC Double Glazing
- Allocated Off Road Parking
- Well Presented
- Gas Central Heating
- Ideal First Time Buy



Floor Plan
 Approx. Gross Internal Floor Area 509 sq. ft / 47.36 sq. m
 Produced by Elements Property

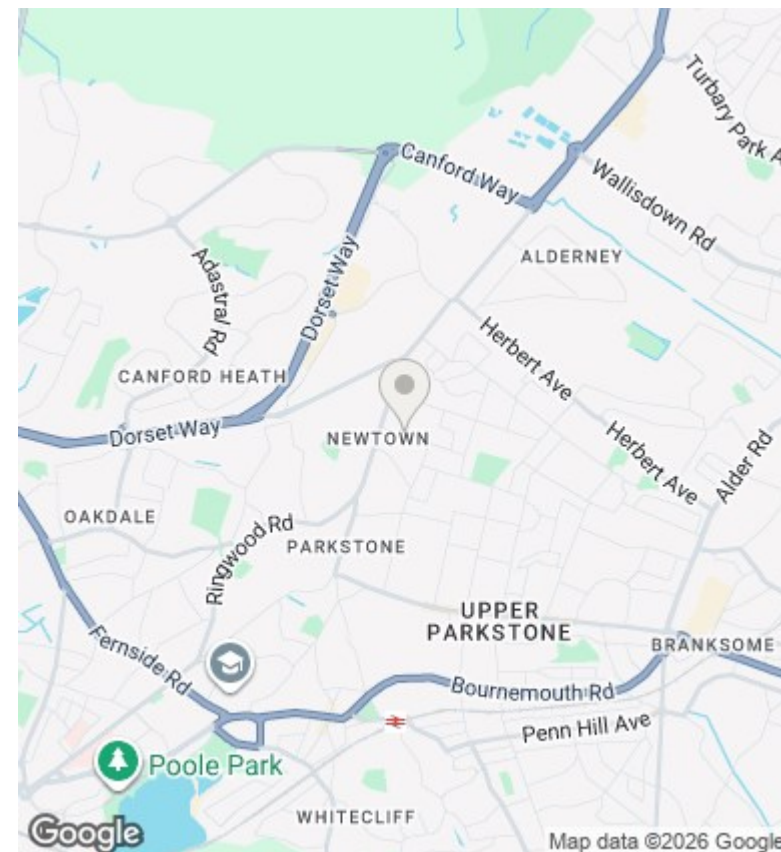

Directions

Viewings

Viewings by arrangement only. Call 01202 749390 to make an appointment.

Council Tax Band

A

EPC Rating:

Energy Efficiency Rating		
	Current	Potential
<i>Very energy efficient - lower running costs</i>		
(92 plus) A		
(81-91) B		
(69-80) C		
(55-68) D		
(39-54) E		
(21-38) F		
(1-20) G		
<i>Not energy efficient - higher running costs</i>		
England & Wales	EU Directive 2002/91/EC	