



Room 3, 103 Hazelwood Close, Cambridge, CB4 3SP

£600 Per month

- Milton Science Park
- Easy access to A14, A10 & M11

Room 3, 103 Hazelwood Close, Cambridge CB4 3SP

Spacious, furnished room on the ground floor of a shared house, licensed for up to six residents.



Council Tax Band: C



Bedroom

11' x 8'

Good size room on the ground floor- part furnished to include, Single bed & mattress, wardrobe

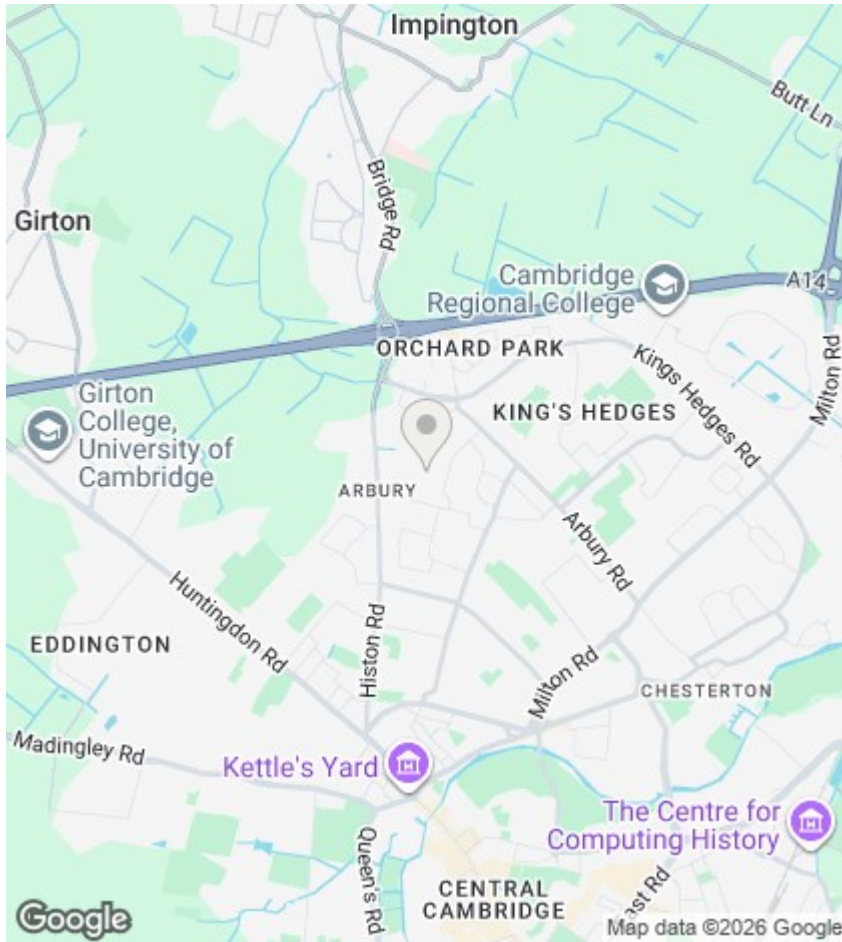

Directions

Viewings

Viewings by arrangement only. Call 07398313902 to make an appointment.

EPC Rating:

C

Energy Efficiency Rating		
	Current	Potential
Very energy efficient - lower running costs		
(92 plus) A		
(81-91) B		
(69-80) C	71	
(55-68) D		
(39-54) E		
(21-38) F		
(1-20) G		
Not energy efficient - higher running costs		
England & Wales		EU Directive 2002/91/EC

Ground Floor
Approx. 62.2 sq. metres (669.3 sq. feet)

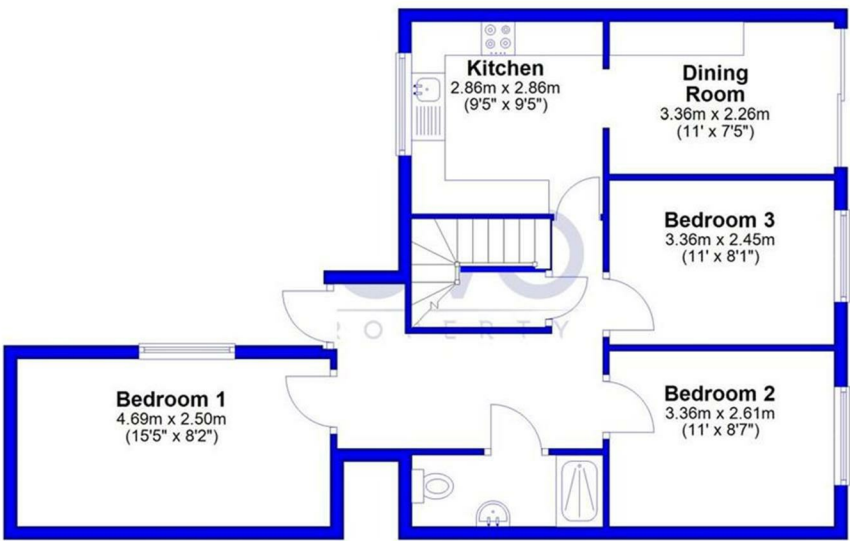

First Floor
Approx. 47.1 sq. metres (507.5 sq. feet)

