



Bakers Cottage, Madderty, Crieff, PH7 3PJ

Offers Over £180,000



NEXTHOME

ESTATE & LETTING AGENTS

Buying with Next Home

Bakers Cottage, Madderty, Crieff, PH7 3PJ

Many thanks for your interest with Bakers Cottage, Madderty, Crieff, PH7 3PJ.

Next Home Estate Agents dedicate themselves to be available when you are, offering an unbeatable service 7 days a week until 9pm.

We have the largest sales team in Perthshire, operating from our 5 offices throughout Perthshire and delivering more sales than any other estate agent.

Not only are we Perthshire's Number 1 choice but we are also local. One of the reasons we know the local markets so well is because we live here. So let us guide you through the selling and buying process.

If you're a first time buyer we have incentives to help get you onto the property ladder - our consultants can advise you through the whole process.

We offer free, no obligation mortgage advice to all our buyers.

If you have a property to sell, contact us to arrange a valuation. We are renowned in getting our customers moving quicker and at a higher price than our competitors. Put us to the test and get your free valuation today, call 01738 444342.

If you would like to be kept informed of other great properties like this one please register on our hot buyers list, where we will email you of new property listings and property open days.

Next Home your number 1 choice for property sales



FREE Valuations



We're open 7 days a week until 9pm



Registered Buyers



No obligation mortgage advice



Conveyancing Quotations



First Time Buyer with No Deposit



Next Home's Buying Guide



Next Home Open Days

About the Area

Situated within the picturesque rural village of Madderty, Bakers Cottage enjoys a peaceful countryside setting while remaining conveniently accessible to nearby towns and amenities.

The surrounding area offers beautiful open countryside, scenic walking routes and a tranquil lifestyle, ideal for those seeking a quieter pace of life. The village is well positioned for access to Crieff, Perth and Auchterarder, where a wide range of shops, supermarkets, restaurants, schools and leisure facilities can be found.

The world-renowned Gleneagles Hotel and Golf Resort is also within easy reach, offering exceptional leisure and dining opportunities. With excellent road links to Perth, Stirling and the central belt, Madderty provides the perfect balance of rural living and modern convenience, making it a highly desirable location for commuters and those looking to enjoy the best of Perthshire's countryside.





NEXTHOME

ESTATE & LETTING AGENTS

Get to know about our newly listed properties 1st by
signing up to our Hot Buyers lists!

Visit www.nexthomeonline.com/buying

Property Summary

Bakers Cottage is a charming semi-detached traditional cottage offering spacious accommodation, character features and beautifully maintained garden grounds in a picturesque rural setting.

The accommodation begins with an entrance porch leading into the welcoming hallway. The lounge is a particularly attractive space, centred around a cosy woodburning stove which creates a warm and inviting focal point. The galley-style kitchen is fitted with a range of units and is complemented by a rear hallway which serves as a practical utility area. Completing the ground floor is a stylish modern shower room featuring attractive tiling, a walk-in shower with waterfall rain feature, wash hand basin and WC.

On the first floor there are two double bedrooms, both benefitting from built-in storage. One of the bedrooms enjoys an attractive bay window overlooking the beautifully maintained garden. A separate WC completes the upper accommodation.

Externally, the property is set within substantial garden grounds which have been lovingly cultivated and planted to a high standard, featuring a variety of mature shrubs, plants and colourful borders. There are several useful outbuildings providing excellent storage and workshop potential, while a large driveway offers ample off-street parking for approximately four vehicles.

This delightful cottage successfully combines traditional charm with modern comforts, creating an ideal home for those seeking a peaceful countryside lifestyle.



Key property features

- ✓ Rare to the market
- ✓ Large private garden
- ✓ Sought after area
- ✓ Ample off-street parking
- ✓ Wood-burning stove
- ✓ Mature garden
- ✓ Modern shower
- ✓ 2 double bedrooms
- ✓ Traditional stone-built cottage
- ✓ Bay window feature













Have a property to sell?

An expert from our local branch will provide you with the most accurate valuation.



NEXTHOME

ESTATE & LETTING AGENTS

Floorplans

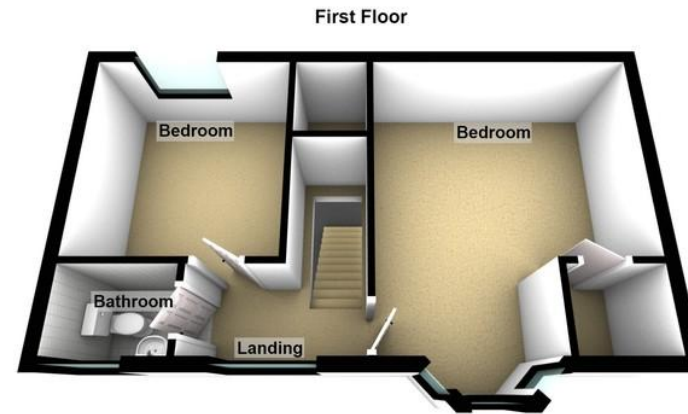
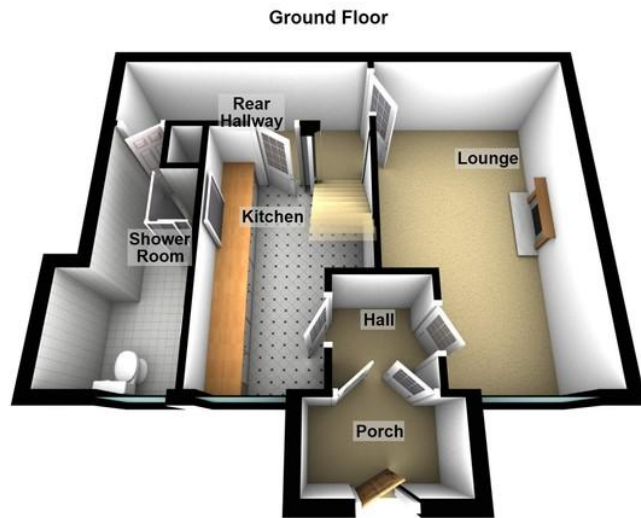



Property Room Sizes

ENTRANCE HALL

ENTRANCE PORCH

LOUNGE

15' 4" x 11' 6" (4.67m x 3.51m)

KITCHEN

11' 10" x 6' 10" (3.61m x 2.08m)

REAR HALL

10' 9" x 3' 5" (3.28m x 1.04m)

SHOWER ROOM

11' 7" x 5' 5" (3.53m x 1.65m)

BEDROOM

15' 5" x 11' 9" (4.7m x 3.58m)

BEDROOM

9' 3" x 8' 6" (2.82m x 2.59m)

W/C

6' 2" x 4' 11" (1.88m x 1.5m)

PLEASE NOTE: These particulars whilst believed to be accurate are set out as a general outline only for guidance and do not constitute any part of an offer or contract intending, purchasers should not rely on them as statements or representations of fact, but must satisfy themselves by inspection or otherwise as to their accuracy. No person in this firm's employment has the authority to make or give representation or warranty in respect of the property. All room sizes are approximate and for general guidance only. They cannot be relied upon for fitting carpets, furniture etc.



NEXTHOME
ESTATE & LETTING AGENTS

TO ARRANGE A VIEWING OF THIS PROPERTY PLEASE TELEPHONE YOUR LOCAL BRANCH BELOW:

63 – 65 George Street, Perth 01738 44 43 42

41 - 43 Allan Street, Blairgowrie..... 01250 39 80 02

47a Atholl Road, Pitlochry..... 01796 54 80 14

1a James Square, Crieff.....01764 65 00 44

211 High Street, Auchterarder.....01764 66 36 66

Email sales@nexthomeonline.co.uk

For more information about Next Home and our services please visit www.nexthomeonline.co.uk

The only Perthshire estate agent available 7 days until 9pm

PLEASE NOTE: These particulars whilst believed to be accurate are set out as a general outline only for guidance and do not constitute any part of an offer or contract intending, purchasers should not rely on them as statements or representations of fact, but must satisfy themselves by inspection or otherwise as to their accuracy. No person in this firm's employment has the authority to make or give representation or warranty in respect of the property. All room sizes are approximate and for general guidance only. They cannot be relied upon for fitting carpets, furniture etc.

Registered Office Argyll House, Quarrywood Court, Livingston, West Lothian EH54 6AX. Registered in Scotland No. SC264812. NEXTHOME (Scotland) Ltd is an appointed representative of Kinggate Law Limited, which is authorised and regulated by the Financial Conduct Authority for advising on and arranging mortgages and insurance, broking and debt counselling of consumer credit agreements.



Next Home are proud to be members of the Property Ombudsman Scheme