





Two-bedroom house is now available for sale, offered with the added benefit of no upward chain. This property presents an excellent opportunity for first-time buyers or those looking to downsize.

The double glazed and gas centrally heated accommodation comprises of lounge, dining room, kitchen and ground floor bathroom with two good sized first floor bedrooms.

Outside, the property boasts off-road parking and garden offers a private outdoor space.



ABODE
SALES & LETTINGS

Lounge
13.8 x 12.1

Dining Room
13.0 x 12.3

Kitchen
10.6 x 7.5

Bathroom
9.2 x 8.1

Bedroom One
13.8 x 12.3

Bedroom Two
12.1 x 12.2



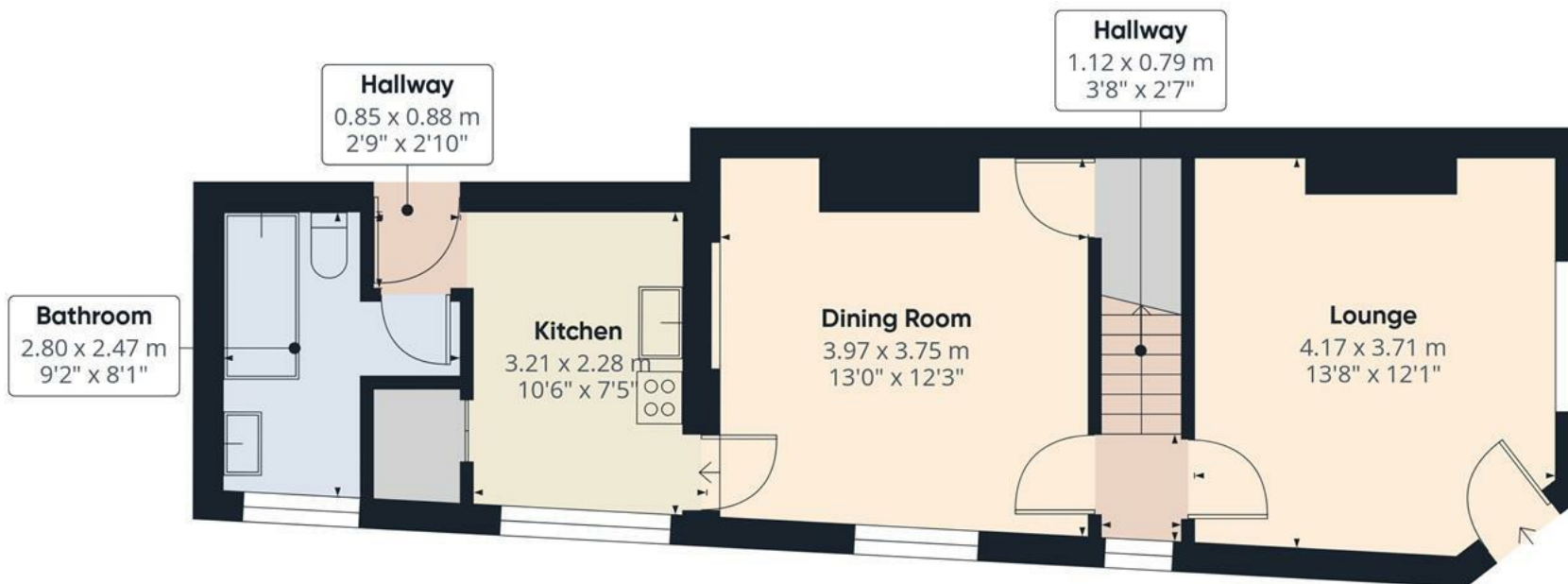

Floor 0

Approximate total area⁽¹⁾

75.9 m²

817 ft²

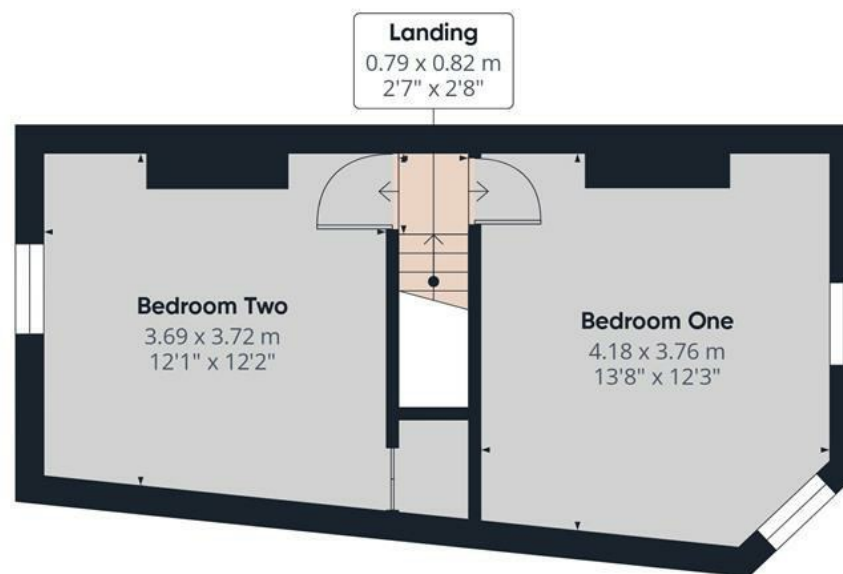

Floor 1

(1) Excluding balconies and terraces

Calculations reference the RICS IPMS 3C standard. Measurements are approximate and not to scale. This floor plan is intended for illustration only.

GIRAFFE360



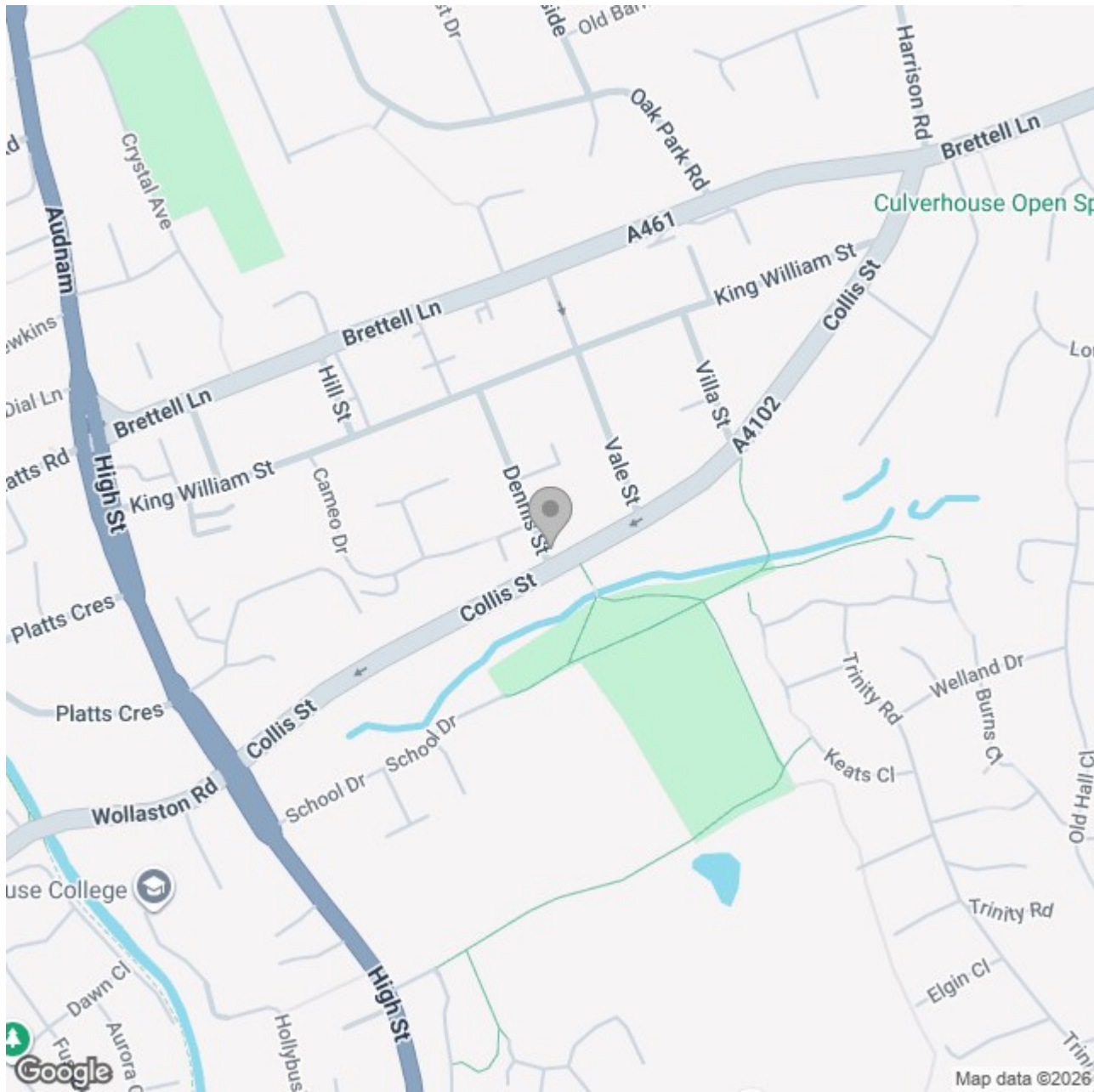

Energy Efficiency Rating

	Current	Potential
Very energy efficient - lower running costs		
(92 plus) A		
(81-91) B		
(69-80) C		
(55-68) D		
(39-54) E		
(21-38) F		
(1-20) G		
Not energy efficient - higher running costs		

England & Wales

EU Directive
2002/91/EC
 