



## Duckett Street, E1

### £300,000

A spacious one bedroom apartment in a sought after location. This one bedroom apartment provides an open plan living room with space to dine and a fully integrated kitchen, leading to a full length private balcony. This apartment benefits from a double bedroom with ample storage and further storage in the hallway, along with a family bathroom.

Ideally located for easy transport throughout the City and beyond via Stepney Green (District, Hammersmith&City) and Whitechapel (Elizabeth, Windrush), as well as multiple bus routes, and Limehouse for the DLR. Nearby Mile End Park and Stepney City Park Farm offer open green spaces.

### Features

- One Double Bedroom
- Top Floor
- Good Transport Links
- Private Full Length Balcony
- Long Lease
- Open Plan Living

# Duckett Street, London, E1

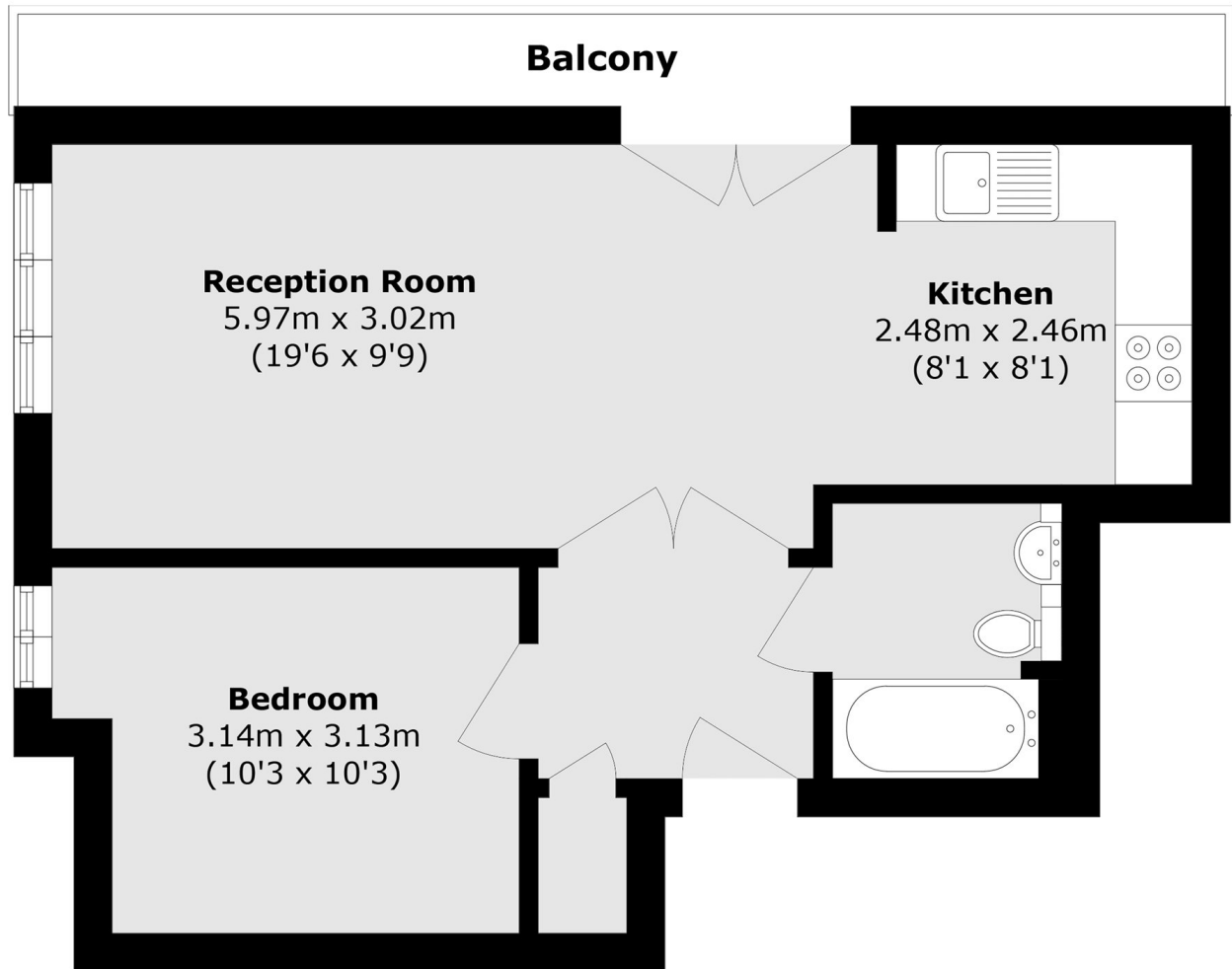

Total area (approx.): 46.5 sq. m (500.5 sq. ft)