



HADYN PARK ROAD, W12

£410,000

This beautifully refurbished lower ground floor flat forms part of an elegant Victorian conversion, offering a perfect blend of period charm and modern living. Benefiting from its own private entrance, the property

Lower ground floor flat with
Private entrance
Victorian conversion

Refurbished
Askew Village
Good transport links

STEP INSIDE HADYN PARK ROAD

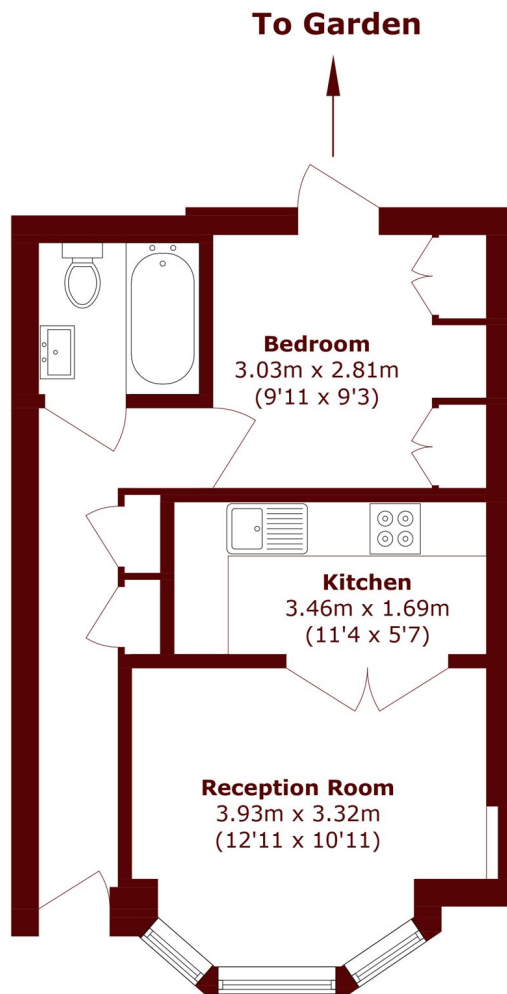

Total area (approx.): 37.9 sq. m (407.9 sq. ft)

Askew Road
020 8102 0123

Energy Rating: D We aim to make our particulars both accurate and reliable. However, they are not guaranteed; nor do they form part of an offer or contract. If you require clarification on any points then please contact us, especially if you're traveling some distance to view. Please note that appliances and heating systems have not been tested and therefore no warranties can be given as to their good working order

MARSH &
PARSONS