



New Crane Place, E1W

£305,000

 0  1  1  D

- Studio Apartment
- Warehouse Conversion
- 0.1 Miles From Wapping Station

- 24 Hour Portage Service
- Character Features
- Allocated Parking Space



Ea2 are pleased to present this Studio Apartment in New Crane Wharf. Originally built in 1873, this Warehouse converted apartment benefits from exposed brick work and a Juliet balcony. The property comes with an allocated parking space and a 24 hour portorage service.

Located approximately 0.1 miles from Wapping Overground station offering access to the City, Canary Wharf & Shoreditch. Wapping Lane offers a selection of shops including a Sainsburys Local, butchers, post office and pharmacy. Picturesque St Katharine's Docks offers plenty of dining options, bars and cafes.



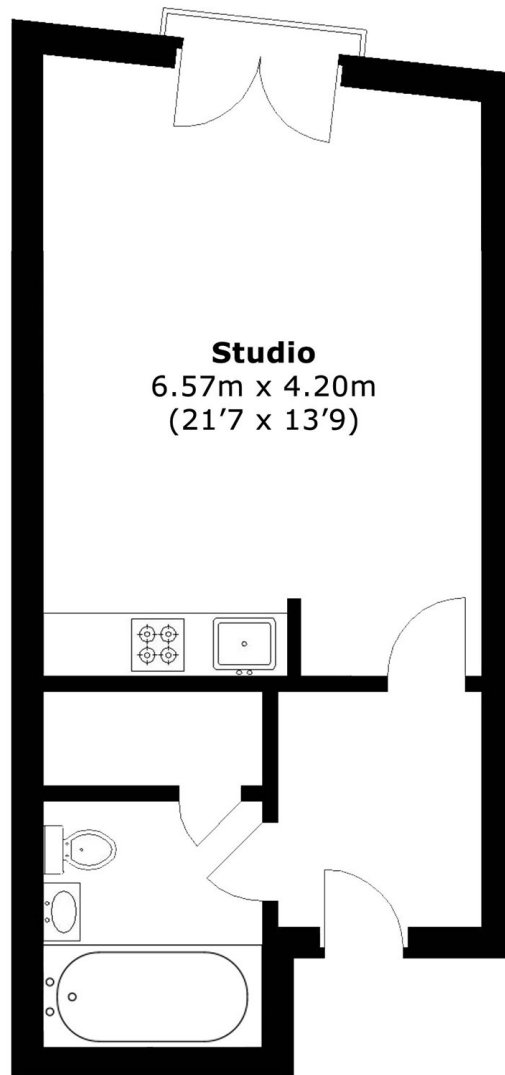

Total Area (approx.): 39.3 sq. m (423.0 sq ft.)

35A Wapping High Street,
London, E1W 1NR
020 7665 5589
ea2group.com