



Flat

**SW18 2AE**

Per Calendar Month

**£2,100**

FEATURES

- Modern two-bedroom apartment with private outdoor space and lift access
- Gas central heating and high-speed broadband
- Separate living room, kitchen and WC
- Built-in storage throughout
- Prime location near stations, shops and Ram Quarter entertainment



# 2 Bedroom Flat located in London

This bright, modern two-bedroom apartment in sought-after Wandsworth Town offers elevator access and private outdoor space. The well-proportioned interior features two double bedrooms, a full bathroom with separate WC, a separate living room and kitchen, plus built-in storage throughout. The property benefits from gas central heating, high-speed broadband connectivity, and double glazing throughout.

Located moments from Wandsworth Town station and Southside Shopping Centre, the property sits in the heart of this thriving district. The nearby Ram Quarter hosts popular venues like Schooners, Boom Battle Bar, and Strike, while residents benefit from abundant green spaces, excellent transport connections, and some of London's lowest council tax rates – making Wandsworth an increasingly desirable choice in South West London.

Property is let unfurnished.

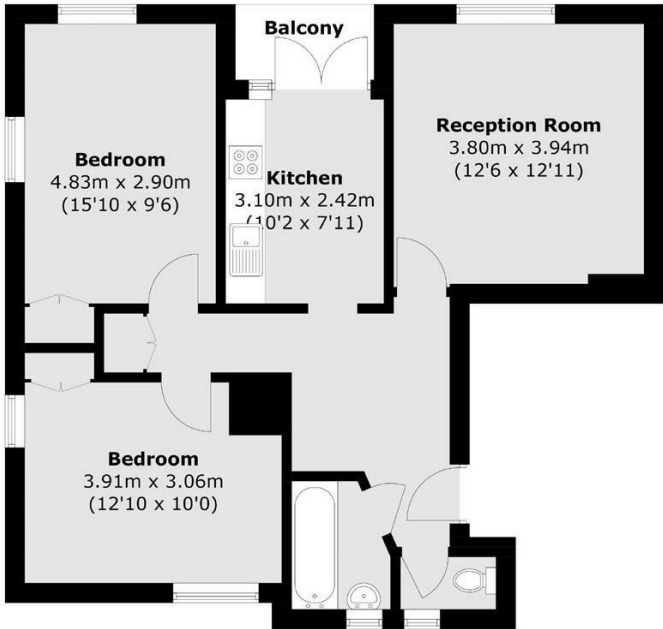

Total area (approx.): 65.2 sq. m (701.8 sq. ft)  
Balcony (approx.): 2.4 sq. m (25.8 sq. ft)

Call us on  
**020 8396 7171**  
[hello@newbrix.co.uk](mailto:hello@newbrix.co.uk)

**Council Tax Band**  
**C**

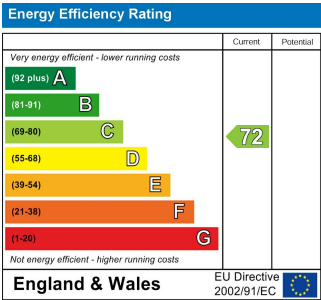

Agents Note: Whilst every care has been taken to prepare these particulars, they are for guidance purposes only. All measurements are approximate and are for general guidance purposes only and whilst every care has been taken to ensure their accuracy, they should not be relied upon and potential buyers are advised to recheck the measurements.

