



Total Area: 213.9 m<sup>2</sup> ... 2302 ft<sup>2</sup> (excluding double garage)  
All measurements are approximate and for display purposes only



First Floor



Ground Floor

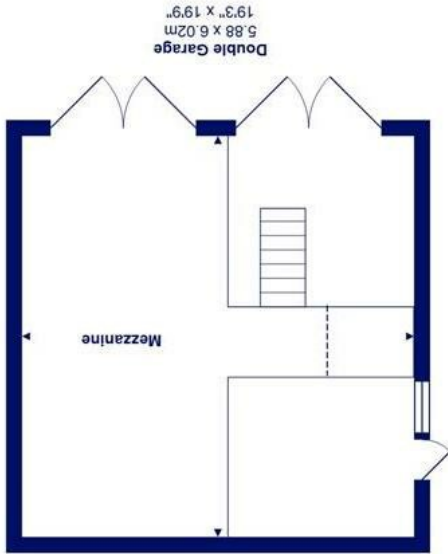
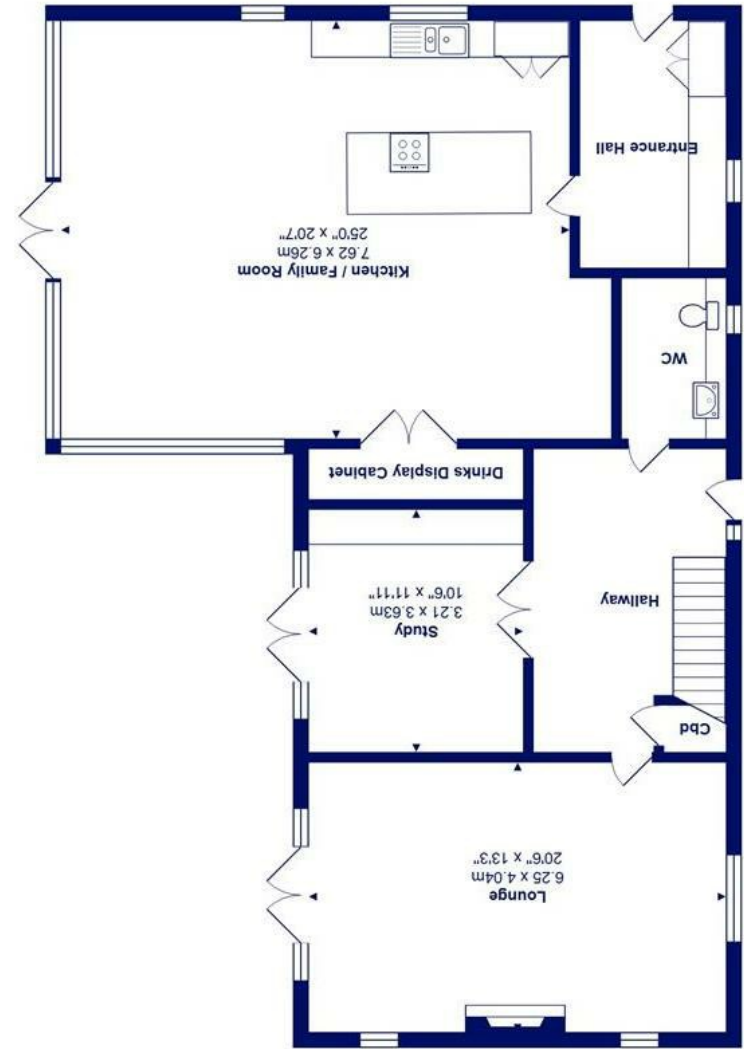

5 Homestead Close, Burton, BH23 7BW £995,000

Mitchells  
1963 — TODAY

\*NO CHAIN\* An outstanding detached, freehold home set in nearly 1 ACRE of land, comprising of about 2300sqft, and built by Bayview Developments in 2019 with generous gardens and wonderful views over the surrounding fields. Homestead Close is a select Close of just six homes, all unique in design and is quietly situated in a rural, but not remote setting and within a short stroll of Burton Village Green and the local shop/pub. An absolute 'one-off'.

- Gorgeous barn style home with the balance of the 10 year new home warranty
- Double garage with mezzanine floor, gated driveway parking
- Nearly 1 acre of land, including generous garden and gated paddock
- Fabulous galleried reception hall with vaulted ceiling and imposing oak/glass staircase
- Stylish open plan kitchen/living room with bespoke kitchen, stone/oak worktops and built in table, Amtico flooring and views over the gardens and fields
- Spacious sitting room with feature log burner, French doors to the garden
- Illuminated, walk in drinks display/cabinet and large laundry room
- Master bedroom with extensive fitted wardrobes and designer en-suite shower room
- Three further bedrooms and a stylish family bathroom
- Maintenance fee £600pa (reserved fund £12,000 in credit)

EPC Rating Band: B  
Council Tax Band: G  
Freehold

