

chris hamriding

lettings & estate agents



20 The Mews, Barclay Hall Hall Lane, Mobberley, WA16 7DZ

Offers In The Region Of £210,000

Take a few moments to admire this wonderful home via our guided video tour!

A wonderful lifestyle for the over 55's awaits you at Barclay Hall! Once a grand country residence, the property has been sympathetically developed into a highly regarded and often sought after range of apartments that enjoy the grandeur of the original Manor House along with easy apartment living all within stunning grounds just a short journey to the affluent Cheshire village of Mobberley! Apartment number 20 is a first floor property (served by a useful lift) in the more modern extended part of the building thus affording great efficiency and, in our opinion, more privacy than those apartments situated in the older section of the main house. There are two useful bedrooms, a spacious four piece bathrooms suite, a tasteful kitchen and a beautiful bay fronted living/dining area overlooking the most fabulous manicured gardens that are yours to enjoy any time of day! With residents parking and immaculately kept grounds as standard - there are also useful residents areas such as a lounge, laundry and a guest suite for your visitors!

A short journey to Mobberley will find you amongst great shops and amenities whilst a little further will find you in Wilmslow, Alderley Edge, Knutsford and beyond!

This wonderful apartment really will tick all of your boxes so please watch our guided video tour then call us here at Chris Hamriding Estate Agents to book yourself that all important viewing!

Accommodation

Open-Plan Living Room/Dining Room 20'2" x 14'2" (6.16 x 4.34)

Kitchen 8'10" x 7'1" (2.71 x 2.17)

Utility/Store 5'6" x 4'10" (1.68 x 1.48)

Bedroom One 12'1" x 9'9" (3.69 x 2.98)

Bathroom

Bedroom Two 9'8" x 8'9" (2.95 x 2.67)

Floor Plan

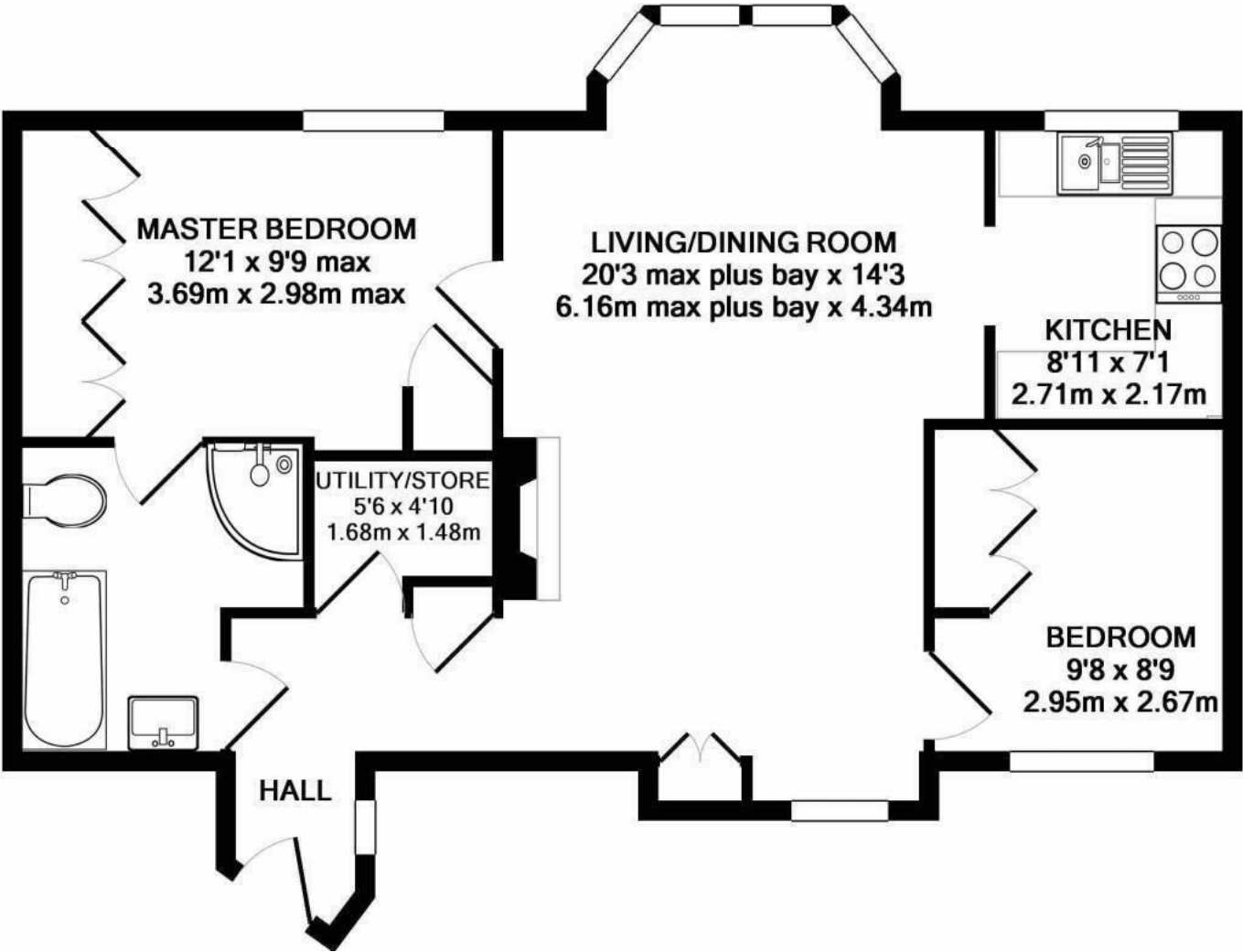

Area Map

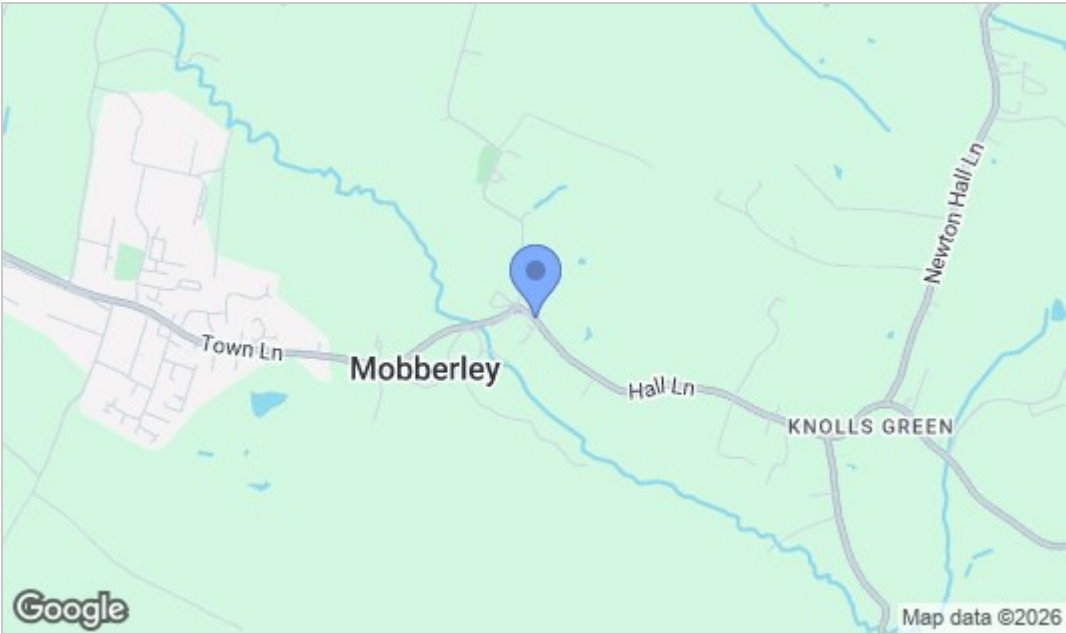

Energy Efficiency Graph

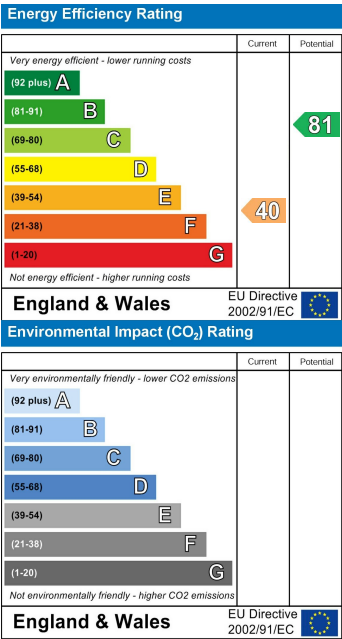

NOTICE Chris Hamriding Lettings & Estate Agents for themselves and for the vendor or lessors of this property whose agents they are given notice that: (i) the particulars are set out as a general outline only for the guidance of intending purchasers or lessees, and do not constitute, nor constitute part of, an offer of contract, (ii), all descriptions, dimensions, references to condition and necessary permissions for use and occupation, and other details are given in good faith and are believed to be correct but any intending purchasers or tenants should not rely on them as statement or representation of fact but must satisfy themselves by inspection or otherwise as to the correctness of each of them, (iii) no person in the employment of Chris Hamriding Lettings & Estate Agents has any authority to make or give any representation or warranty whatever in relation to this property.