



PEABODY ESTATE, W6

£485,000

A well-presented two double bedroom flat on the third floor of this red-brick mansion block. The property benefits from a modern kitchen and large reception room. Built in the 1920s, the Peabody Estate is now a

Two double bedrooms
Hammersmith Broadway
Excellent transport links

Thames riverside
Separate kitchen
Long lease

STEP INSIDE PEABODY ESTATE

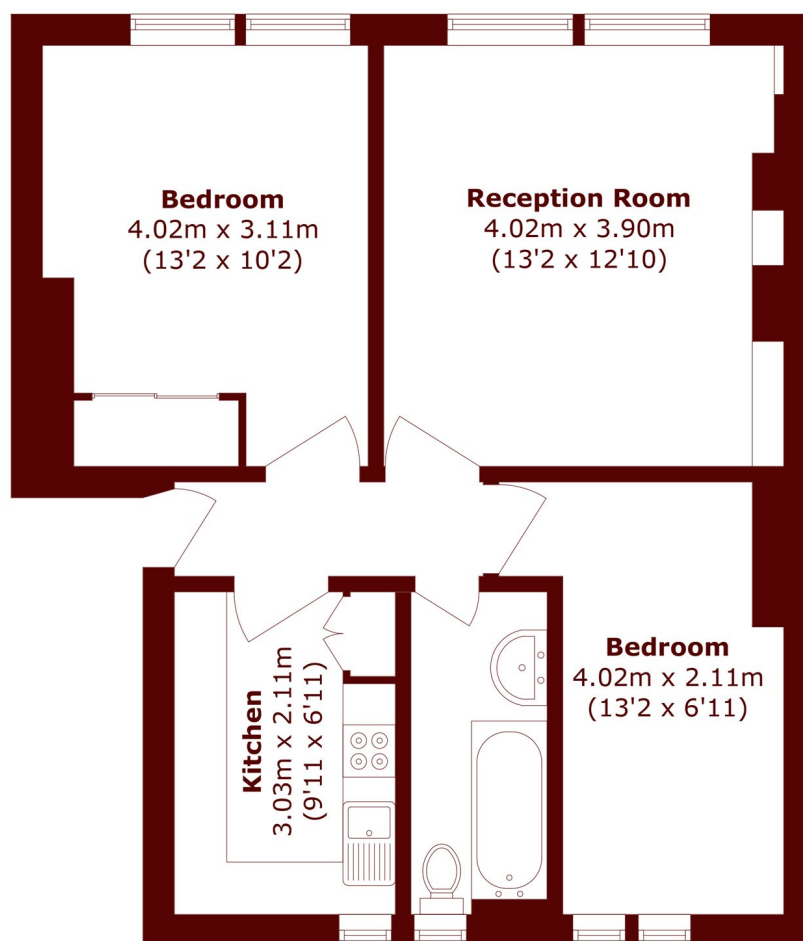

Total area (approx.): 53.3 sq. m (573.7 sq. ft)

Bishops Park
020 7993 9888

Energy Rating: C We aim to make our particulars both accurate and reliable. However, they are not guaranteed; nor do they form part of an offer or contract. If you require clarification on any points then please contact us, especially if you're traveling some distance to view. Please note that appliances and heating systems have not been tested and therefore no warranties can be given as to their good working order

**MARSH &
PARSONS**