

Tann Road
Finedon
Wellingborough
NN9 5JA

£1,150 Per Month



OSCAR JAMES

...expect excellence

FLOOR PLANS

GROUND FLOOR
679 sq.ft. (63.1 sq.m.) approx.

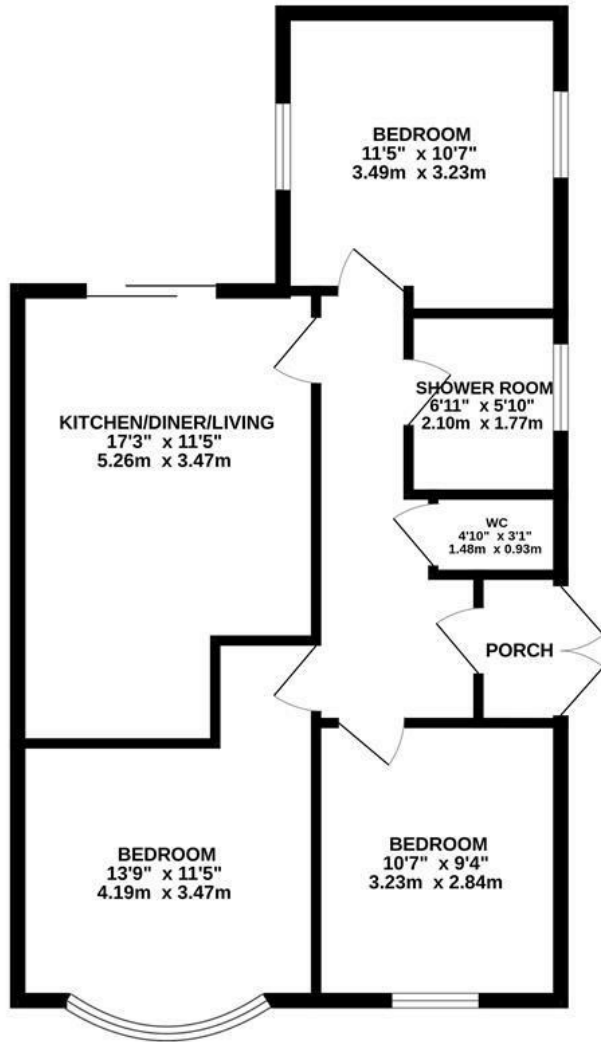

TOTAL FLOOR AREA : 679 sq.ft. (63.1 sq.m.) approx.

Whilst every attempt has been made to ensure the accuracy of the floorplan contained here, measurements of doors, windows, rooms and any other items are approximate and no responsibility is taken for any error, omission or mis-statement. This plan is for illustrative purposes only and should be used as such by any prospective purchaser. The services, systems and appliances shown have not been tested and no guarantee as to their operability or efficiency can be given.
Made with Metropix 6/2025



AT A GLANCE...



custom text 1



custom text 4



custom text 2



custom text 5



custom text 3



custom text 6



WHAT'S GREAT?

Situated in the charming village of Finedon, Wellingborough, this newly renovated bungalow offers a delightful blend of modern living and serene surroundings. Situated in a desirable location, this home benefits from excellent transport links to nearby towns and villages, making it an ideal choice for those seeking both tranquillity and accessibility.

This property features an inviting open plan kitchen and lounge area, perfect for both relaxation and entertaining. The patio doors seamlessly connect the indoor space to a lovely secluded garden, primarily laid to lawn, which boasts a patio area ideal for summer gatherings.

This bungalow comprises three generously sized double bedrooms, providing ample space for family or guests. The family bathroom is thoughtfully designed with a separate w/c, ensuring convenience for all.

Additionally, off-road parking for one vehicle adds to the practicality of this delightful

residence.

*** AVAILALE NOW ***

Council Tax Band: B

EPC Rating: D

...expect excellence



SELLER'S SECRET



Why we like it....

OSCAR JAMES

1 Newland Street | Kettering | NN16 8JH
01536 415777
www.oscar-james.com

To buy or not to buy....
