



Mornington Crescent
Hounslow, TW5 9SU

REDUCED £700,000

EPC Rating 'TBC'

- 6-bedroom main house needing full refurbishment
- 2-bedroom rear annexe with separate council tax
- 3 shower rooms & spacious kitchen/diner
- Driveway to front & excellent location near Heathrow





Property Description

Investment Project with Huge Potential – 6-Bed Main House + 2-Bed Rear Annexe

This is a rare opportunity to acquire a 6-bedroom main house requiring full refurbishment throughout, paired with a 2-bedroom rear annexe that has separate council tax-perfect for additional income or flexible living arrangements. The property includes 3 shower rooms, a large kitchen/diner, and a driveway to the front.

Ideal for an HMO conversion or further extension and development (STPP), this project offers fantastic scope to add value. Located just steps from Heathrow Airport, with excellent transport links to Central London and major motorways, it's a prime spot for commuters and investors alike.

Priced for quick sale, this is a brilliant investment opportunity not to be missed.

Call NOW for further details or to book a viewing!

GROUND FLOOR
1464 sq.ft. (136.1 sq.m.) approx.

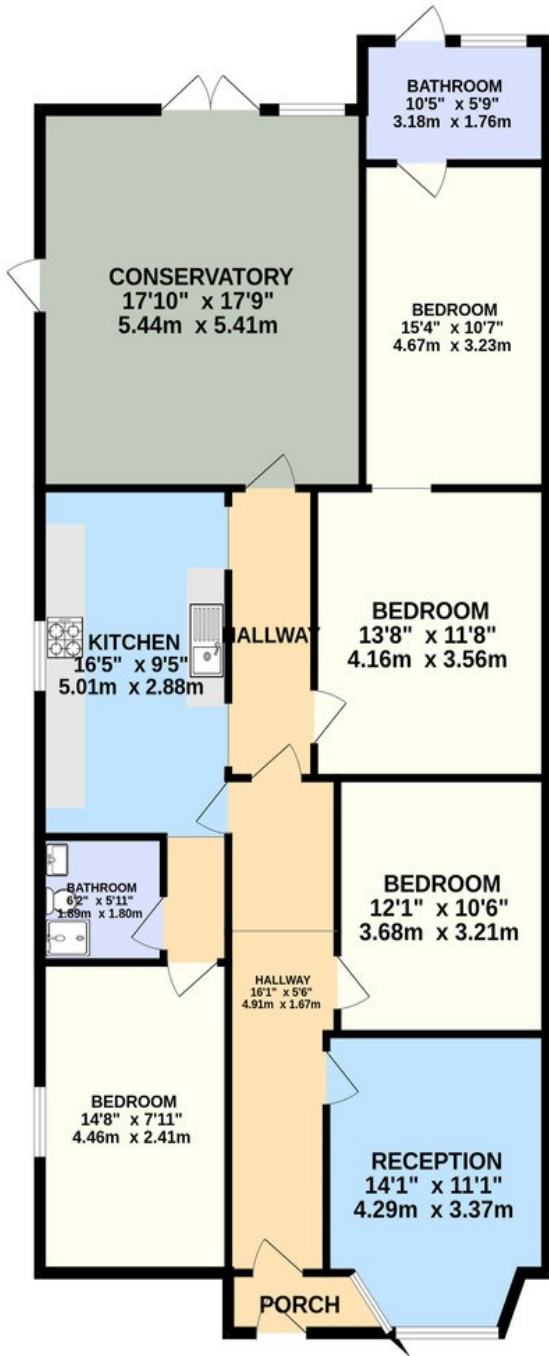

1ST FLOOR
409 sq.ft. (38.0 sq.m.) approx.

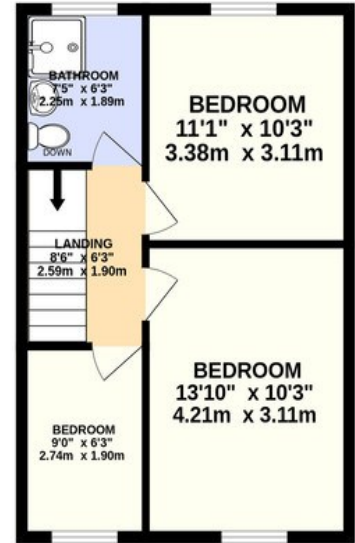

GROUND FLOOR
704 sq.ft. (65.4 sq.m.) approx.

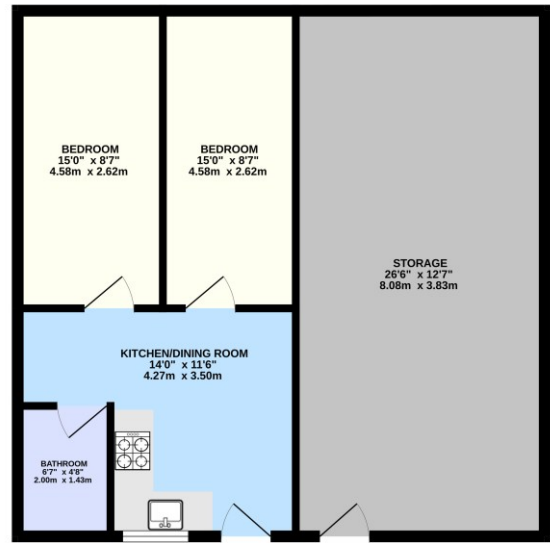

TOTAL FLOOR AREA: 704 sq.ft. (65.4 sq.m.) approx.
Whilst every attempt has been made to ensure the accuracy of the floorplan contained here, measurements of doors, windows, rooms and any other items are approximate and no responsibility is taken for any error, omission or mis-statement. This plan is for illustrative purposes only and should be used as such by any prospective purchaser. The services, systems and appliances shown have not been tested and no guarantee as to their operability or efficiency can be given.
Made with Metropix ©2025

TOTAL FLOOR AREA: 1873 sq.ft. (174.0 sq.m.) approx.

Whilst every attempt has been made to ensure the accuracy of the floorplan contained here, measurements of doors, windows, rooms and any other items are approximate and no responsibility is taken for any error, omission or mis-statement. This plan is for illustrative purposes only and should be used as such by any prospective purchaser. The services, systems and appliances shown have not been tested and no guarantee as to their operability or efficiency can be given.
Made with Metropix ©2025

243 The Broadway
Southall
Middlesex
UB1 1NF

www.hiltons-estates.com
Rajneev@hiltons-estates.com
02085 741 999

Agents Note: Whilst every care has been taken to prepare these sales particulars, they are for guidance purposes only. All measurements are approximate and for general guidance purposes only and whilst every care has been taken to ensure their accuracy, they should not be relied upon and potential buyers are advised to recheck the measurements