



Nicholls Court Nicholls Lane
BRISTOL BS36 1NX

Price:
£1,300 PCM

Property Features

- Top Floor Apartment
- Two Double Bedrooms
- En-Suite Shower Room
- Available 1st May
- Lounge/Dining Room
- White Goods Included
- Garage
- Communal Gardens
- Well Presented Throughout
- Early Viewing Recommended



Full Description

HALLWAY

LOUNGE AREA

17'2" x 11'7"

DINING AREA

6'7" x 13'0"

KITCHEN

9'11" x 10'2"

White Goods included, washing machine, fridge freezer and cooker.

MASTER BEDROOM

9'11" x 9'8"

ENSUITE

BEDROOM TWO

10'0" x 9'11"

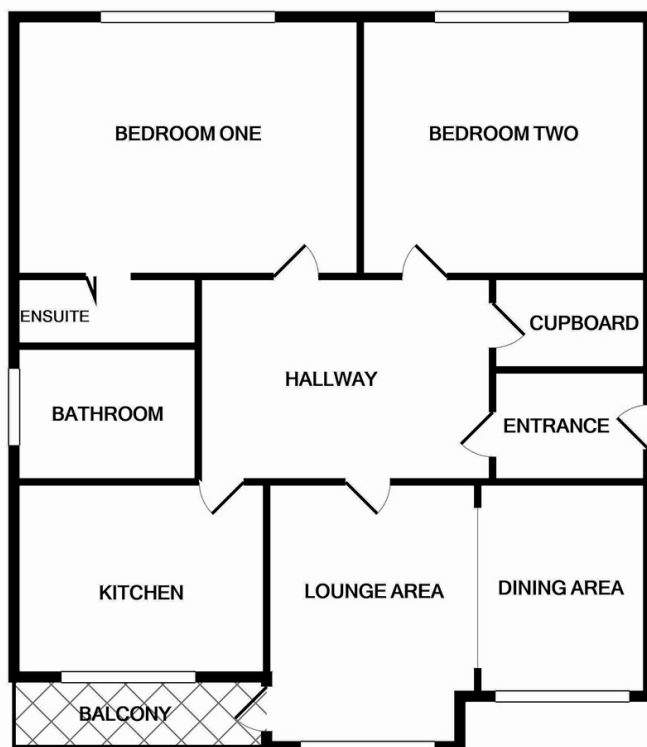

Measurements are approximate. Not to scale. Illustrative purposes only
Made with Metropix ©2021

4 Flaxpits Lane
Winterbourne
Bristol
BS36 1JX

www.aj-homes.co.uk
info@aj-homes.co.uk
01454 252140

Agents Note: Whilst every care has been taken to prepare these sales particulars, they are for guidance purposes only. All measurements are approximate are for general guidance purposes only and whilst every care has been taken to ensure their accuracy, they should not be relied upon and potential buyers are advised to recheck the measurements