



8C Lime Tree Crescent

Rossington, Doncaster, DN11 0BT

Asking Price **£162,500**

Positioned on a small private cul de sac, close to a host of local facilities, a larger style 3 bedroom mid town house, offering ideal accommodation for the young family or first time buyer. Briefly comprising of; well proportioned lounge, rear dining kitchen with integrated appliances, 'French' doors to the rear patio. Cloaks / WC.

First floor; master bedroom with en suite shower room, 2 further bedrooms and family bathroom.

Outside; enclosed, mainly lawned rear garden, with private patio area.

Off road parking for 2 vehicles.

- good sized 3 bedroom mid town house of around 900 sq ft
- situated on a small private cul de sac
- en suite shower room to master bedroom
- local facilities within walking distance
- wider ranging shops in nearby towns of Tickhill and Bawtry
- off road parking for 2 cars
- well enclosed lawned gardens

Viewing

Please contact our Office on 01302 751616 if you wish to arrange a viewing appointment for this property or require further information.



Floor Plan

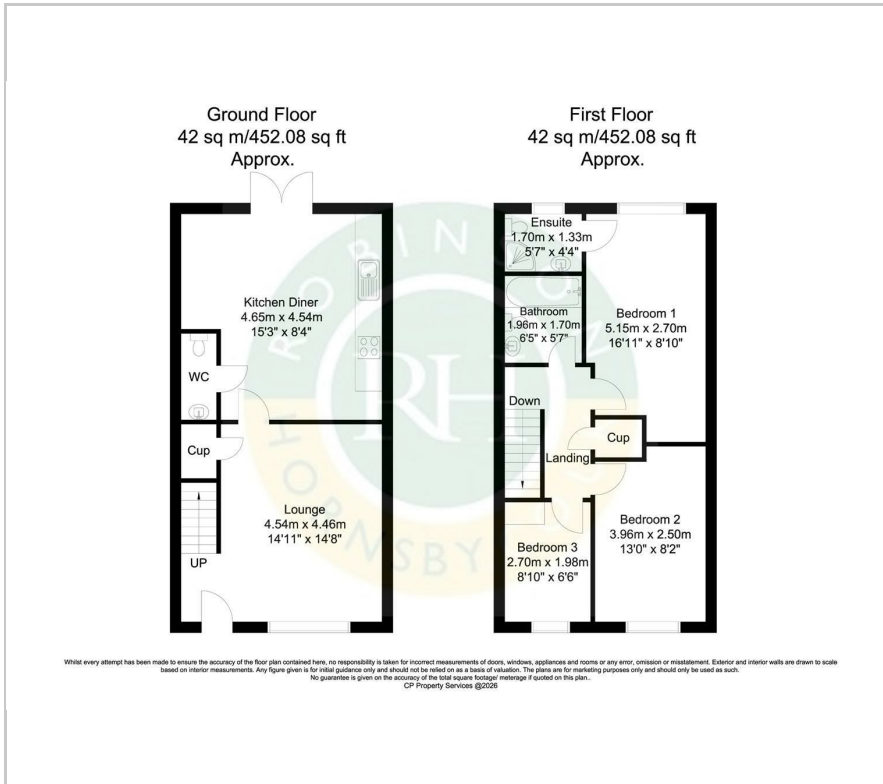

Area Map



Energy Efficiency Graph

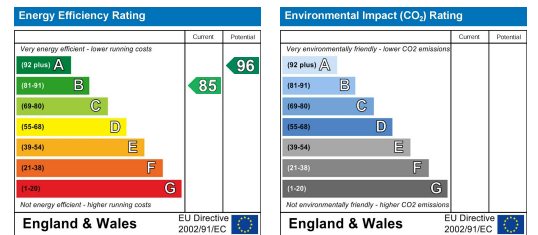

These particulars, whilst believed to be accurate are set out as a general outline only for guidance and do not constitute any part of an offer or contract. Intending purchasers should not rely on them as statements of representation of fact, but must satisfy themselves by inspection or otherwise as to their accuracy. No person in this firm's employment has the authority to make or give any representation or warranty in respect of the property.