



**HALE OFFICE:**

212 ASHLEY ROAD, HALE,  
CHESHIRE WA15 9SN  
TEL: 0161 941 6633  
FAX: 0161 941 6622

Email: hale@watersons.net

**SALE OFFICE:**

91-93 SCHOOL ROAD, SALE,  
CHESHIRE M33 7XA  
TEL: 0161 973 6688  
FAX: 0161 976 3355

Email: sale@watersons.net



INDEPENDENT ESTATE AGENTS  
PROPERTY SALES AND RENTALS



WATERSONS

INDEPENDENT ESTATE AGENTS

# 58 Derbyshire Road

Sale, Greater Manchester, M33 3EE



£495,000





**HALE OFFICE:**  
 212 ASHLEY ROAD, HALE,  
 CHESHIRE WA15 9SN  
 TEL: 0161 941 6633  
 FAX: 0161 941 6622  
 Email: hale@watersons.net

**SALE OFFICE:**  
 91-93 SCHOOL ROAD, SALE,  
 CHESHIRE M33 7XA  
 TEL: 0161 973 6688  
 FAX: 0161 976 3355  
 Email: sale@watersons.net



INDEPENDENT ESTATE AGENTS



## energy efficiency

In line with Government Legislation, we are able to provide an Energy Performance Certificate (EPC) rating (see below)

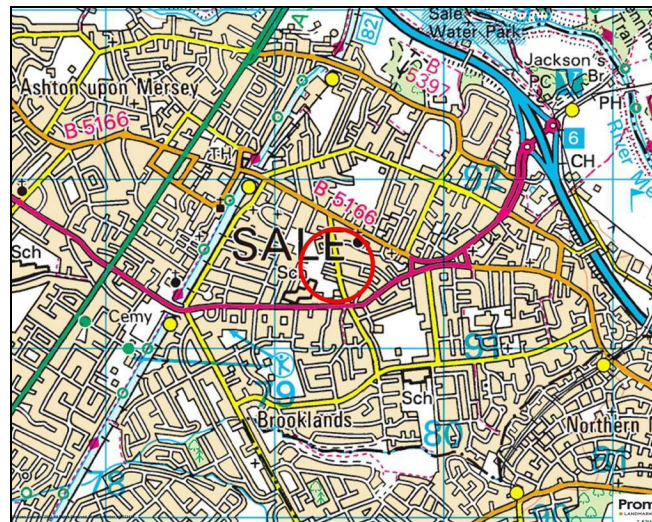
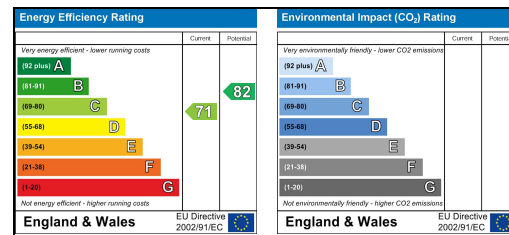

# Overview

AN IMPRESSIVE END TOWNHOUSE LOCATED ON THIS LOVELY ROAD PERFECT FOR THE TOWN CENTRE AND SCHOOLS. SUPERB ESTABLISHED GARDENS TO THREE SIDES. APPROX 1400 SQFT OVER FOUR FLOORS PLUS CONVERTED LOFT SPACE. AMPLE DRIVEWAY PARKING

GF. Hall. Study. Sitting Room. Bedroom 4. Shower Room. FF. Large Lounge. Dining Kitchen. SF Three futher Bedrooms and Bathroom. Useful Converted Loft. Ample Parking. Established Private Gardens.

CONTACT SALE 0161 973 6688



**AGENTS NOTES** Please note that we have not tested any apparatus, equipment, fixtures, fittings or services and so cannot verify they are in working order or fit for their purpose. Furthermore solicitors should confirm moveable items described in the sales particulars are in fact included in the sale since circumstances do change during marketing or negotiations. A final inspection is recommended prior to the exchange of contracts. Although we try to ensure accuracy, measurements used in this brochure may be approximate. Therefore if intending purchasers need accurate measurements in order to have carpets fitted or ensure that existing furniture will fit they should take the measurements themselves.

# in detail

An impressive Four Bedroomed End Townhouse, located on this ever popular road and offering ample living space over three floors plus converted loft space.

The location is ideal being a short distance to the Town Centre, Sale Moor Village and several of the local schools.

Internally, there are modern Kitchen and Bathroom fittings and in keeping with the age of the property there are large rooms and oversized wide windows.

In addition to the Accommodation, there is ample Driveway Parking, Garage storage area and a beautiful established gardens to both the rear and the side.

An internal inspection will reveal:

**Entrance Hall.** Having opaque uPVC double glazed front door and window to one side. Staircase rising to the First Floor with large useful understairs storage space which also has space and plumbing for a washing machine. Doors then provide access Study, Sitting Room, Bedroom Four and Shower Room.

**Study.** Having a uPVC double glazed window to the side elevation. Wall mounted gas central heating boiler.

**Sitting Room.** A set of uPVC double glazed French doors opening out onto the Rear Garden.

**Bedroom Four.** A lovely double room having a door with adjacent window opening out to the paved side Garden.

**Shower Room.** Fitted with a suite comprising of enclosed shower cubicle with thermostatic shower over. Wash hand basin. WC. Opaque uPVC double glazed window to the rear elevation.

**First Floor Landing.** Having a large opening into the Dining Kitchen and door through to the Lounge.

**Lounge.** A wonderful large Reception Room a virtually full width uPVC double glazed window to the front elevation. Staircase rising to the First Floor. Fireplace feature to one wall. Coved ceiling. Window facing into the Dining Kitchen.

**Dining Kitchen.** A good sized room with plenty of space for a table. The Kitchen itself is fitted with an extensive range of handleless base style of units with worktops over with inset one and a half bowl sink unit with mixer tap. Built in double oven with ceramic hob and a stainless steel and glass extractor over. Ample space for a range of freestanding appliances. Useful Breakfast Bar area. Two uPVC double glazed windows to the rear elevation overlooking the Gardens.

**First Floor Landing.** Having a spindle balustrade returning to the staircase opening. Doors then provide access to Three Bedrooms and Family Bathroom. Timber space saver staircase provides access to the useful Loft space.

**Bedroom One.** An excellent sized bedroom having a uPVC double glazed window to the rear elevation overlooking the Gardens. Beautiful built in wardrobes. Painted stripped wooden floors.

**Bedroom Two.** Another good double room having a uPVC double glazed window to the rear and side elevation. Painted stripped wooden floors.

**Bedroom Three.** A great single bedroom having a uPVC double glazed window to the front elevation. Painted stripped wooden floors.

**Family Bathroom.** A fitted suite comprising of panel bath with thermostatic shower over. WC. Wash hand basin. Opaque uPVC double glazed window to the rear elevation.

**Loft Room.** The loft space has been converted and has a skylight velux window.

Outside there is a long driveway providing ample parking, this then leads to the Garage storage space.

The gardens are a lovely feature of this property, having a paved rear garden with established borders whilst to the side there is an excellent sized garden with large paved patio area with lawned area and again beautifully stocked borders. The gardens enjoys a backdrop of trees making it feel really private.

Lots of space to offer and in a great location!



Loft Space

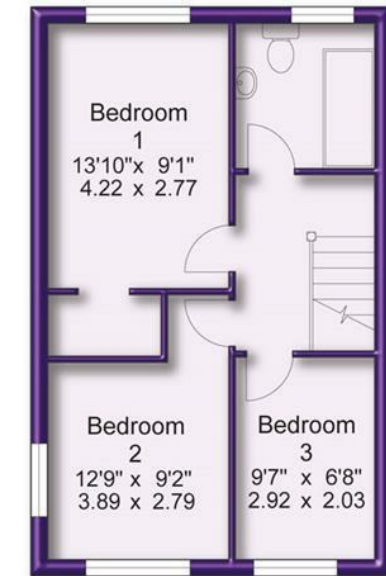

Second Floor

Approx Gross Floor Area = 1389 Sq. Feet  
= 128.76 Sq. Metres

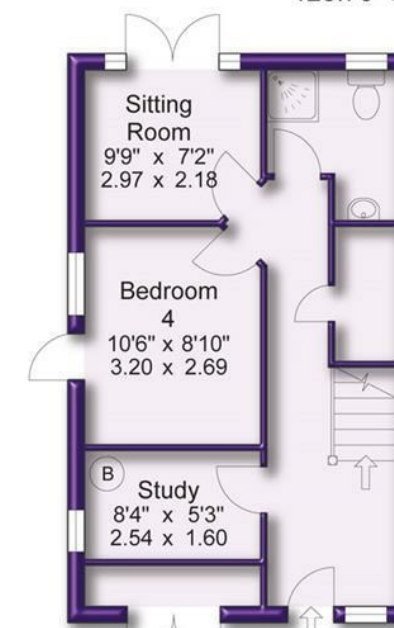

Ground Floor

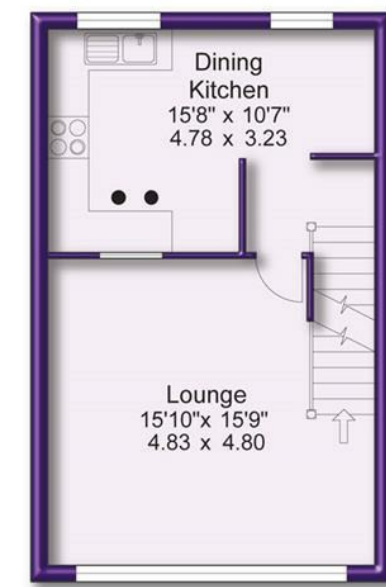

First Floor