



Mansell Street, E1

£2,100 Per calendar month

A large one double bedroom apartment in Londinium Tower. This property comes with a separate kitchen, private balcony and wood flooring throughout. An ideal property for single professional or couple looking to be in the heart of the City.

Mansell Street is between Tower Hill and Aldgate and benefits from having everything on its door step, from transport links to local gyms and supermarkets.

Features

- One Double Bedroom
- Large Reception
- Separate Kitchen
- Balcony
- Porter Service
- Lift Access

Mansell Street, London, E1

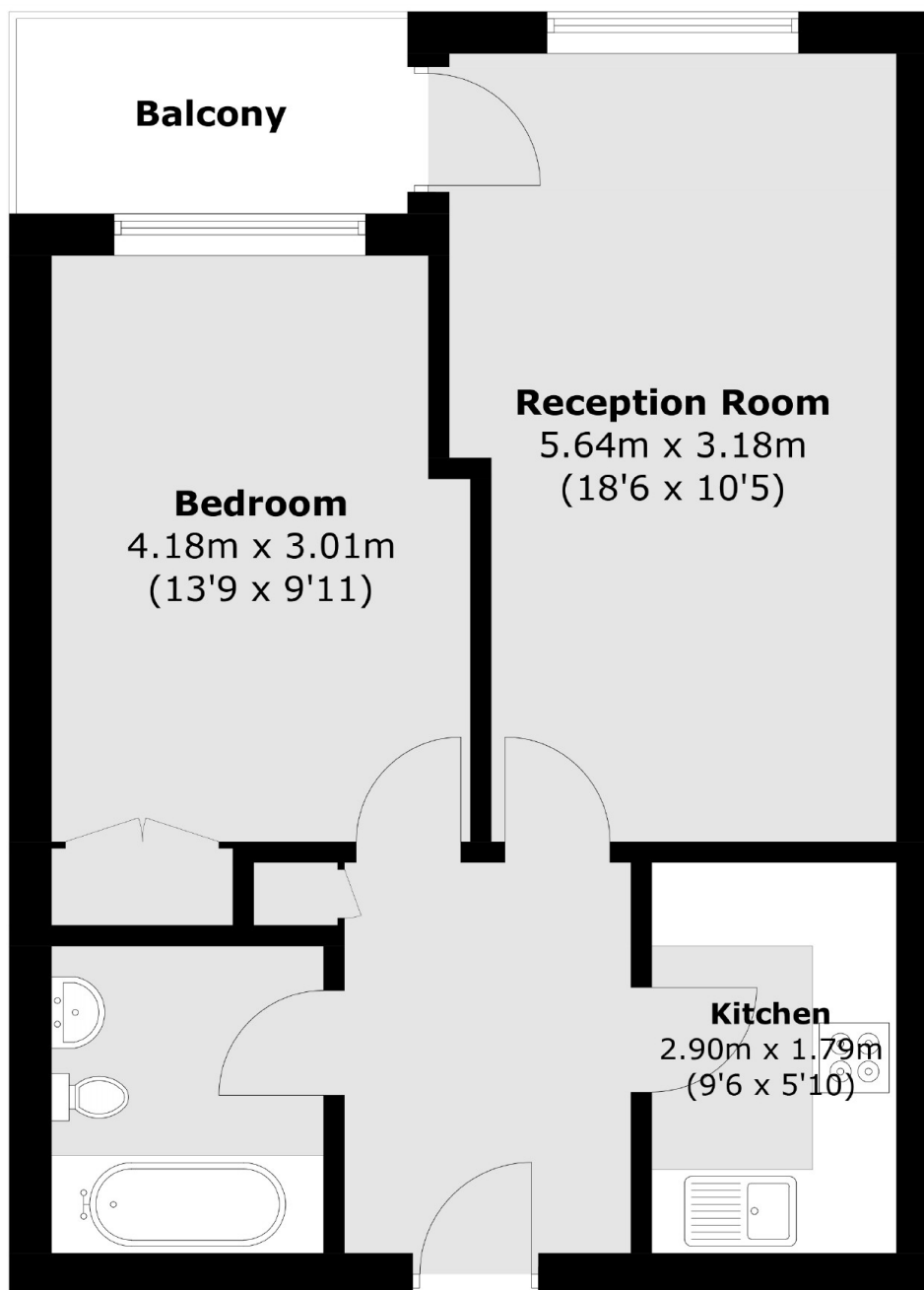

Sixth Floor

Total area (approx.): 48.2 sq. m (518.8 sq. ft)
Balcony: 3.9 sq. m (42.0 sq. ft)