



Eastern Avenue, Peterborough PE1 4PZ

welcome to

Eastern Avenue, Peterborough

This beautifully presented 3-bedroom semi-detached house on Eastern Avenue, Peterborough, offers a wonderful living space for families or professionals. With a driveway providing off-street parking, this property is both practical and convenient. The large garden is a fantastic feature, providing ample outdoor space for relaxation and entertainment. The well-maintained interior and exterior of the property reflect a high level of care and attention, making it a desirable place to call home.



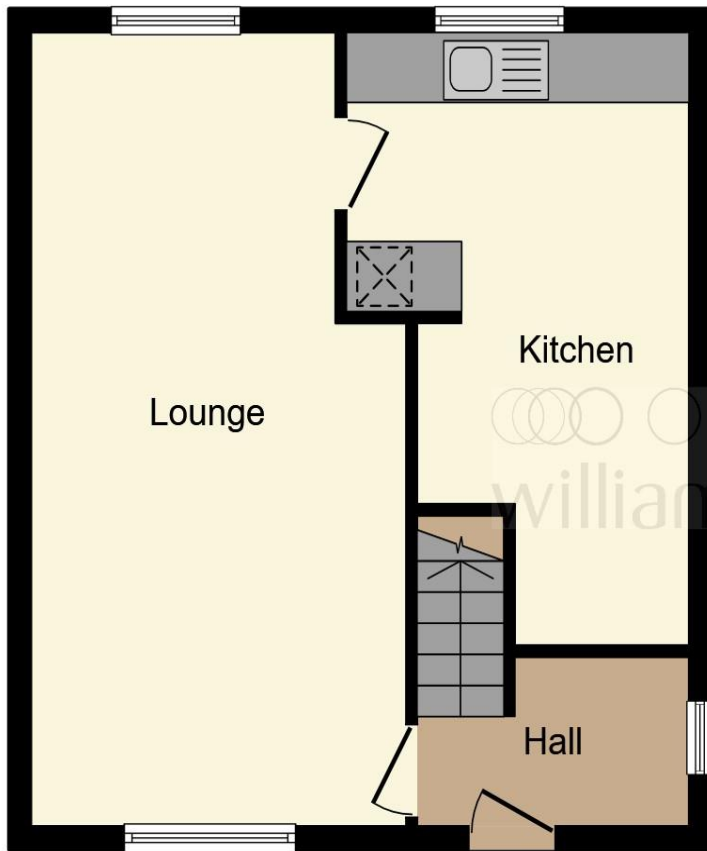

Ground Floor

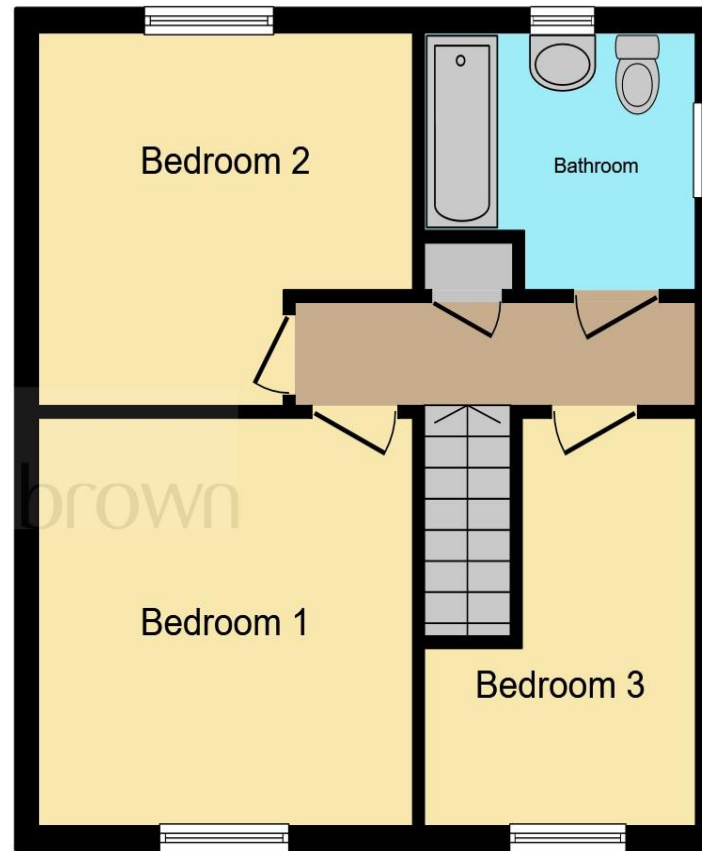

First Floor

Lounge

22' 3" x 11' 4" (6.78m x 3.45m)

Kitchen

17' 3" x 10' 2" (5.26m x 3.10m)

First Floor And Landing

Bedroom One

11' 6" x 10' 3" (3.51m x 3.12m)

Bedroom Two

11' 4" x 8' 3" (3.45m x 2.51m)

Bedroom Three

11' 7" x 11' 4" (3.53m x 3.45m)

Family Bathroom

This floor plan is for illustrative purposes only. It is not drawn to scale. Any measurements, floor areas (including any total floor area), openings and orientation are approximate. No details are guaranteed, they cannot be relied upon for any purpose and they do not form part of any agreement. No liability is taken for any error, omission or misstatement. A party must rely upon its own inspection(s). Powered by www.focalagent.com

welcome to

Eastern Avenue, Peterborough

- THREE BEDROOMS
- LARGE GARDEN
- DRIVEWAY
- THREE-PIECE BATHROOM
- OFFERED WITH NO ONWARD CHAIN

Tenure: Freehold EPC Rating: C

Council Tax Band: B

offers in excess of

£235,000



Please note the marker reflects the postcode not the actual property

view this property online williamhbrown.co.uk/Property/PCG122450



Property Ref:
PCG122450 - 0007

1. MONEY LAUNDERING REGULATIONS Intending purchasers will be asked to produce identification documentation at a later stage and we would ask for your co-operation in order that there is no delay in agreeing the sale. 2. These particulars do not constitute part or all of an offer or contract. 3. The measurements indicated are supplied for guidance only and as such must be considered incorrect. Potential buyers are advised to recheck measurements before committing to any expense. 4. We have not tested any apparatus, equipment, fixtures or services and it is in the buyers interest to check the working condition of any appliances. 5. Where an EPC, or a Home Report (Scotland only) is held for this property, it is available for inspection at the branch by appointment. If you require a printed version of a Home Report, you will need to pay a reasonable production charge reflecting printing and other costs. 6. We are not able to offer an opinion either written or verbal on the content of these reports and this must be obtained from your legal representative. 7. Whilst we take care in preparing these reports, a buyer should ensure that his/her legal representative confirms as soon as possible all matters relating to title including the extent and boundaries of the property and other important matters before exchange of contracts.

William H Brown is a trading name of Sequence (UK) Limited which is registered in England and Wales under company number 4268443, Registered Office is Cumbria House, 16-20 Hockliffe Street, Leighton Buzzard, Bedfordshire, LU7 1GN. VAT Registration Number is 500 2481 05.



william h brown



01733 311022



Peterborough@williamhbrown.co.uk



6-9 Fortune Buildings Cowgate,
PETERBOROUGH, Cambridgeshire, PE1 1LR



williamhbrown.co.uk