



1 Bed
Apartment
located in

£1,150 Per month



SMART STREET
THE PROPERTY PEOPLE

GROUND FLOOR
528 sq.ft. (49.0 sq.m.) approx.

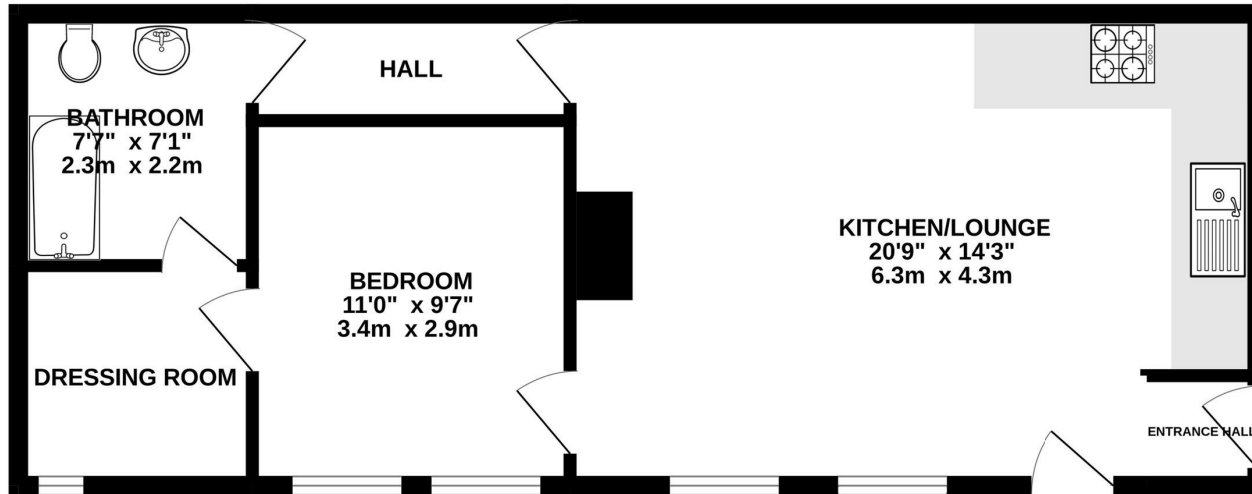

[DIRECTIONS](#)

[CONTACT](#)

14 Withambrook Park
Grantham
NG31 9ST

E: info@smartstreetproperty.com
T: 01476 247107

GROUND FLOOR, 1 BEDROOM APARTMENT

TOTAL FLOOR AREA : 528 sq.ft. (49.0 sq.m.) approx.

Whilst every attempt has been made to ensure the accuracy of the floorplan contained here, measurements of doors, windows, rooms and any other items are approximate and no responsibility is taken for any error, omission or mis-statement. This plan is for illustrative purposes only and should be used as such by any prospective purchaser. The services, systems and appliances shown have not been tested and no guarantee as to their operability or efficiency can be given.
Made with Metropix ©2026

Energy Efficiency Rating		
	Current	Potential
Very energy efficient - lower running costs		
(92 plus) A		
(81-91) B		
(69-80) C		
(55-68) D		
(39-54) E		
(21-38) F		
(1-20) G		
Not energy efficient - higher running costs		
EU Directive 2002/91/EC 		
England & Wales		



SMART STREET
THE PROPERTY PEOPLE