



£525,000

Brompton Close

Hounslow, TW4 5HP

PROPERTY SUMMARY

A beautifully presented three bedroom mid terrace family home, Ideally situated in Brompton Close, Hounslow.

This well maintained property has been a cherished home for many years and offers spacious and practical living accommodation throughout. The ground floor comprises a welcoming entrance , a bright and comfortable reception room, fitted kitchen and the added convenience of a downstairs WC.

To the first floor, there are three well proportioned bedrooms along with a family bathroom, making it ideal for growing families. Externally, the property benefits from both front & rear gardens, providing excellent outdoor space. A key feature is the private garage, along with rear access via a back alley leading directly to the garden offering both convenience and additional accessibility.

Located within easy reach of local amenities, schools and excellent transport links. There is also easy access to neighbouring areas of Whitton and Isleworth.

Viewings are Highly Recommended.

3



2



1





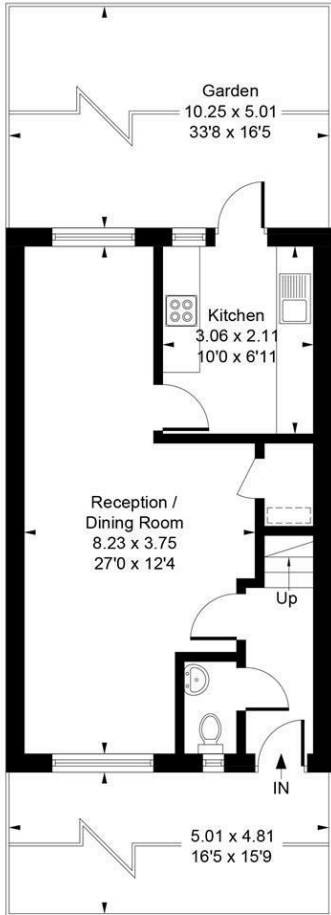

Ground Floor

Approximate Gross Internal Area = 77.88 sq m / 838 sq ft
 Garage = 12.73 sq m / 137 sq ft
 Total = 90.61 sq m / 975 sq ft

= Reduced headroom below 1.5m / 5'0"

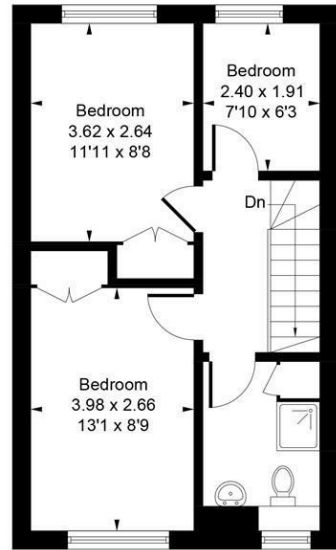

First Floor

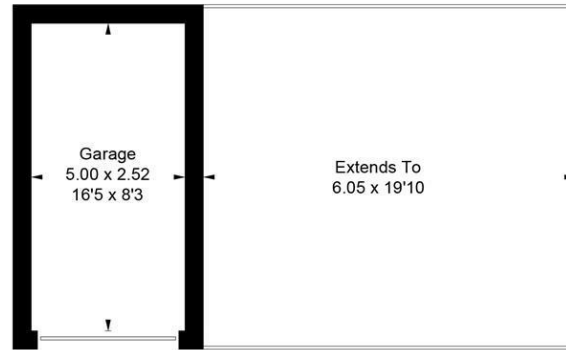

(Not Shown In Actual Location / Orientation)



LOCAL AUTHORITY

Hounslow

TENURE

Freehold

COUNCIL TAX BAND

D

VIEWINGS

By prior appointment only

Energy Efficiency Rating		Current	Potential
Very energy efficient - lower running costs			
(92 plus) A			
(81-91) B			81
(69-80) C			
(55-68) D		64	
(39-54) E			
(21-38) F			
(1-20) G			
Not energy efficient - higher running costs			
England & Wales		EU Directive 2002/91/EC	



Whilst every attempt has been made to ensure the accuracy of the floor plan contained here, measurements of doors, windows, rooms and any other items are approximate and no responsibility is taken for any error, omission, or mis-statement. This plan is for illustrative purposes only and should be used as such by any prospective purchase.

© Vizion Property Marketing Produced for Shaw & Co.

Agents Note: Whilst every care has been taken to prepare these particulars, they are for guidance purposes only. All measurements are approximate and are for general guidance purposes only and whilst every care has been taken to ensure their accuracy, they should not be relied upon and potential buyers/tenants are advised to recheck the measurements

Shaw & Co
ESTATE AGENTS

OFFICE ADDRESS
 10 Central Parade
 New Heston Road
 Heston
 Middlesex
 TW5 0LJ

OFFICE DETAILS
 0208 570 7258
 heston@shawandcoestates.com