



42 Eton Avenue, Wembley, HA0 3AX

AN EXTENDED THREE BEDROOM, TWO BATHROOM, DETACHED FAMILY HOME We are delighted to bring to the market this spacious three bedroom detached family home located in Sudbury, close to shops & transport links. The property is being sold chain free and boasts an extremely wide side plot offering fantastic potential for a huge extension, subject to the usual consents being obtained.

Internally the property briefly comprises of a welcoming entrance hall, and additional inner hallway, a fitted kitchen, a front reception room, a large extended through lounge, a ground floor shower room, three first floor bedrooms and a family bathroom.

Externally you will benefit from off street parking leading to the garage and a nice size garden to the rear.

- THREE BEDROOMS
- DETACHED FAMILY HOME
- FAMILY BATHROOM & DOWNSTAIRS SHOWER ROOM
- LARGE EXTENDED THROUGH LOUNGE
- SEPARATE FRONT RECEPTION ROOM
- GAS CENTRAL HEATING
- DOUBLE GLAZING
- SPACE FOR LARGE SIDE EXTENSION STPP
- GARAGE VIA YOUR OWN DRIVE
- CHAIN FREE SALE

£620,000

Floor Plan

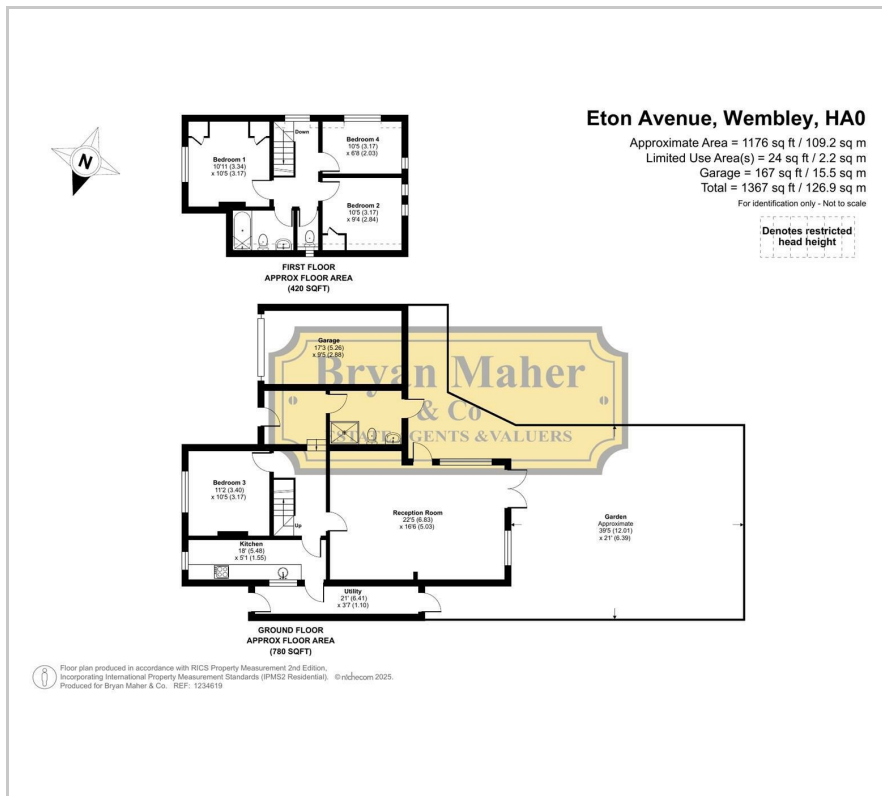

Area Map



Energy Efficiency Graph

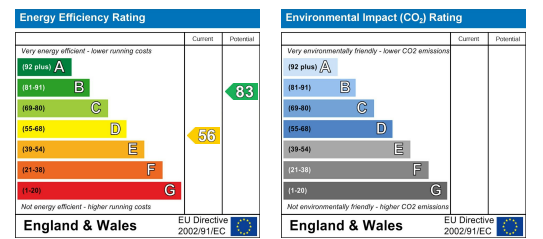

These particulars, whilst believed to be accurate are set out as a general outline only for guidance and do not constitute any part of an offer or contract. Intending purchasers should not rely on them as statements of representation of fact, but must satisfy themselves by inspection or otherwise as to their accuracy. No person in this firm's employment has the authority to make or give any representation or warranty in respect of the property.

