



Crofton Way, Enfield, EN2 8HS

welcome to
Crofton Way, Enfield

Barnfields are delighted to offer for sale the bright and spacious two bedroom top floor flat in this most sought after development just off Enfield Ridgeway with views overlooking the Greenbelt Countryside.

The property is offered in good condition throughout and benefits from a long lease, garage and will be chain free - ideal for a First Time Buyer or a Buy To Let Investor!





Communal Front Door

Opens to communal entrance hall with stairs leading to Second (Top) Floor.

Flat Door Opens To:-

Hallway

Laminate flooring, large storage cupboard, loft hatch opening to loft storage space.

Lounge

17' 4" x 11' 11" (5.28m x 3.63m)

Laminate flooring, radiator, double glazed windows to rear.

Kitchen

10' x 8' 5" (3.05m x 2.57m)

Range of fitted wall and base units with toning worktops, sink and drainer, gas hob with extractor above and oven below and tiled splashback, built-in fridge and freezer, plumbing for washing machine, double glazed windows to rear, laminate flooring, wall mounted boiler, spotlights.

Bedroom One

13' 7" x 11' 11" (4.14m x 3.63m)

Laminate flooring, double glazed windows to front, radiator.

Bedroom Two

10' 3" x 6' 10" (3.12m x 2.08m)

Laminate flooring, radiator, double glazed window to front.

Bathroom

Panelled bath with shower over and glass screen, pedestal wash hand basin, low level WC, part tiled walls, tiled floor.

Outside

Garage

Single garage en bloc with up and over door.



view this property online barnfields.co.uk/Property/ENF105411



welcome to Crofton Way, Enfield

- Two Bedrooms
- Top Floor (Second Floor)
- Bright & Spacious Lounge
- Modern Fitted Kitchen & Bathroom
- Views Over Greenbelt Countryside

Tenure: Leasehold EPC Rating: D

Council Tax Band: D Service Charge: 2,999.45

Ground Rent: 35.00

This is a Leasehold property with details as follows; Term of Lease 160 years from 15 Dec 2009. Should you require further information please contact the branch. Please Note additional fees could be incurred for items such as Leasehold packs.

Offers In Excess Of

£320,000



Please note the marker reflects the postcode not the actual property



Crofton Way, Enfield, EN2

Approximate Area = 590 sq ft / 54.8 sq m

For identification only - Not to scale

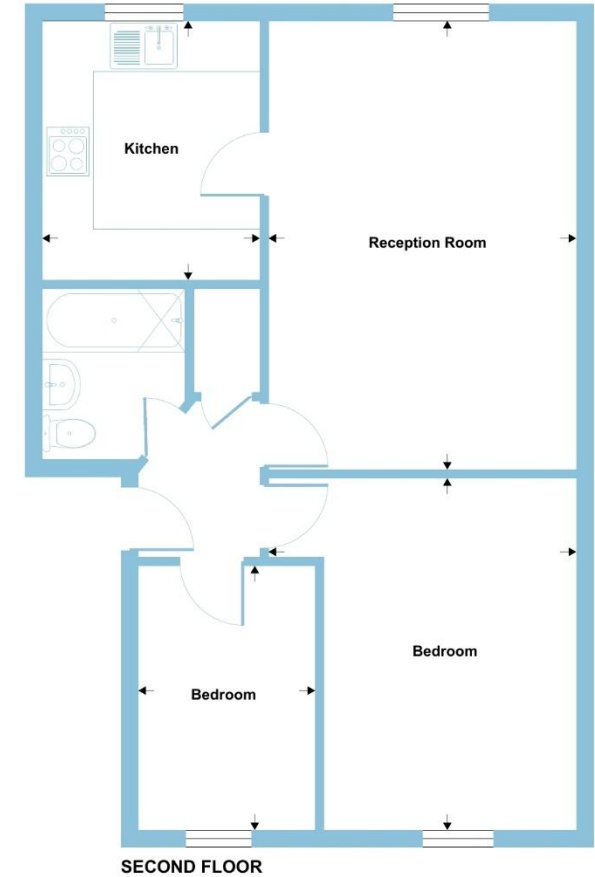

Floor plan produced in accordance with RICS Property Measurement 2nd Edition, incorporating International Property Measurement Standards (IPMS2 Residential). © nichecom 2025. Produced for Barnfield Marcus. REF: 1361742



check out more properties at [barnfields.co.uk](https://www.barnfields.co.uk)



Property Ref:
ENF105411 - 0004

1. MONEY LAUNDERING REGULATIONS Intending purchasers will be asked to produce identification documentation at a later stage and we would ask for your co-operation in order that there is no delay in agreeing the sale. 2. These particulars do not constitute part or all of an offer or contract. 3. The measurements indicated are supplied for guidance only and as such must be considered incorrect. Potential buyers are advised to recheck measurements before committing to any expense. 4. We have not tested any apparatus, equipment, fixtures or services and it is in the buyers interest to check the working condition of any appliances. 5. Where an EPC, or a Home Report (Scotland only) is held for this property, it is available for inspection at the branch by appointment. If you require a printed version of a Home Report, you will need to pay a reasonable production charge reflecting printing and other costs. 6. We are not able to offer an opinion either written or verbal on the content of these reports and this must be obtained from your legal representative. 7. Whilst we take care in preparing these reports, a buyer should ensure that his/her legal representative confirms as soon as possible all matters relating to title including the extent and boundaries of the property and other important matters before exchange of contracts.

Barnfields is a trading name of Sequence (UK) Limited which is registered in England and Wales under company number 4268443, Registered Office is Cumbria House, 16-20 Hockliffe Street, Leighton Buzzard, Bedfordshire, LU7 1GN. VAT Registration Number is 500 2481 05.



020 8363 3394



info@barnfields.com



1a Windmill Hill, Enfield, Middlesex, EN2 6SE



[barnfields.co.uk](https://www.barnfields.co.uk)