

16 Manor Wood Road,
Purley, Surrey, CR8
4LE



NO CHAIN

Located on the highly sought-after Manor Wood Road, this beautifully presented detached family home offers three spacious double bedrooms and spans approximately 1,345 sq. ft. With its charming and welcoming atmosphere, the property provides ample living space for both entertaining and day-to-day family life.

Step inside to a bright and airy living room, perfect for cosy family evenings or entertaining guests. The open-plan kitchen and dining area serves as the heart of the home, featuring an integrated dishwasher and electric hob, along with plenty of storage. Bifold doors open onto the garden, bringing the outdoors in. The space is perfect for family meals or weekend gatherings. Just off the kitchen, a utility

Floorplan

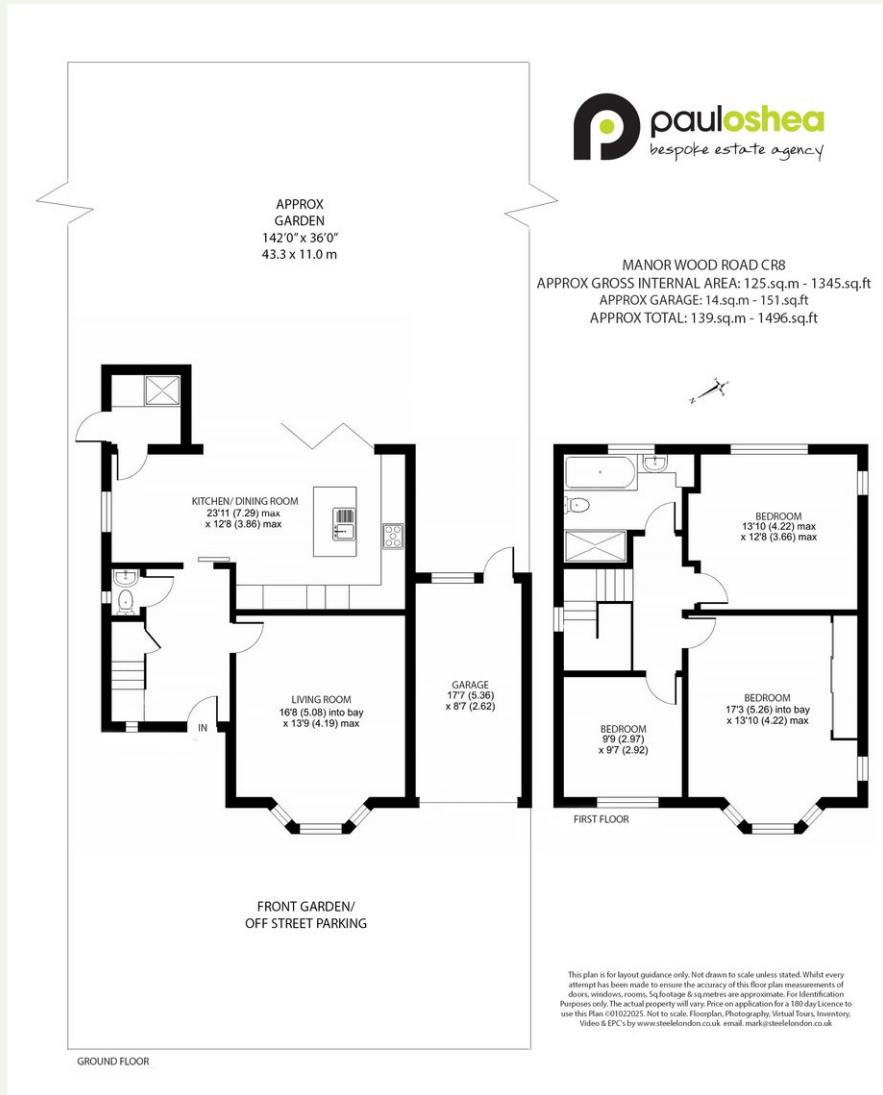

EPC

Current	Potential
63	82

Features

- No Chain- Ready for immediate move-in with no onward chain.
- 1,345 sq. ft. of beautifully presented living space, perfect for families.
- Sunny south-east facing garden, ideal for relaxing and outdoor dining.
- Three spacious double bedrooms, filled with natural light.