



Kent House Road, SE26

£350,000

This charming ground floor flat offers one spacious bedroom, a private garden and the benefit of a share of freehold. Situated within a desirable location close to excellent local amenities and transport links, the property is offered chain free.

Kent House Road enjoys a convenient location, with Kent House station just moments away, providing excellent links into Central London, alongside nearby Penge East and Sydenham stations. Residents benefit from a great selection of local shops, cafés and restaurants nearby, including independent eateries and everyday amenities along Sydenham and Penge high streets. The area also offers easy access to nearby green spaces, making it a well-connected and popular residential setting.

Features

- Ground Floor Flat
- One Bedroom
- Share Of Freehold
- Private Garden
- Desirable Location
- Chain Free

Kent House Road,
LONDON, SE26

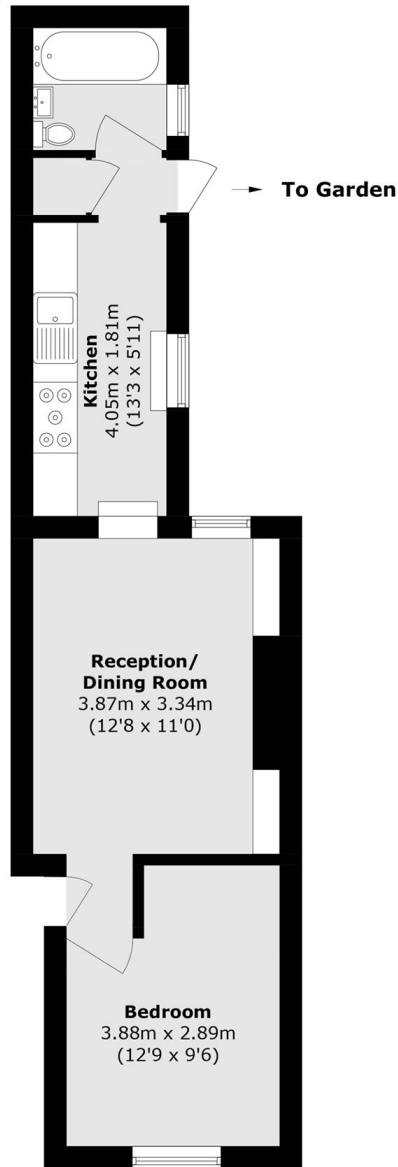

Total area (approx.): 38.2 sq. m (411.1 sq. ft)