



Chapel Close, £375,000

- Superb location with good views
- Set towards end of cul-de-sac
- Versatile ground floor living area
- Conservatory overlooking pretty garden
- Driveway and Garage
- EPC Rating: D



 4  1  2



About the property

Enjoying popular location on the edge of Town with countryside views to front aspect. Extensive ground floor accommodation with Dining Room leading through to Conservatory overlooking landscaped garden with sun terrace. Driveway and Garage.

Desirable location within established area, enjoying mature surroundings and superb countryside views to front, extending along the Wye Valley.. Modernised four Bedroom home benefitting from delightful well stocked rear garden with attractive terrace seating areas. Internally the property comprises; Reception Hall with fitted Cloakroom and doors to principal rooms. Sitting Room overlooking the front garden and distant views. Dining Room leading through to Conservatory, which opens out to the rear garden. Stylish fitted Kitchen with extensive range of units, appliances including oven, hob and fridge. Door to outside. On the first floor, there are once again excellent views to front aspect. Four well proportioned Bedrooms and a Bathroom. Outside, set to the front; lawned area with attractive low level boundary brick wall, with well maintained driveway leading to the Garage. A gate leads around the side to the rear garden. With delightful paved patio providing an ideal entertaining space, with glass covered area and feature pergola, (garden furniture available by separate negotiation). Steps lead up to an ornate tiered level overlooking the garden, which is well stocked with a number of plants and shrubs, creating much interest.





Accommodation

Reception Hall

Cloakroom

Sitting Room

14' 3" x 11' (4.34m x 3.35m)

Kitchen

10' 7" x 8' 9" (3.23m x 2.67m)

Dining Room

11' 2" x 9' 2" (3.40m x 2.79m)

Conservatory

9' 4" x 6' 10" (2.84m x 2.08m)

On The First Floor

Bedroom One

11' 5" x 11' 1" (3.48m x 3.38m)

Bedroom Two

11' 5" x 9' 4" (3.48m x 2.84m)

Bedroom Three

8' 9" x 6' 6" (2.67m x 1.98m)

Bedroom Four

8' 10" x 8' 1" (2.69m x 2.46m)

Bathroom

Garage

17' x 8' 6" (5.18m x 2.59m)

Floorplan

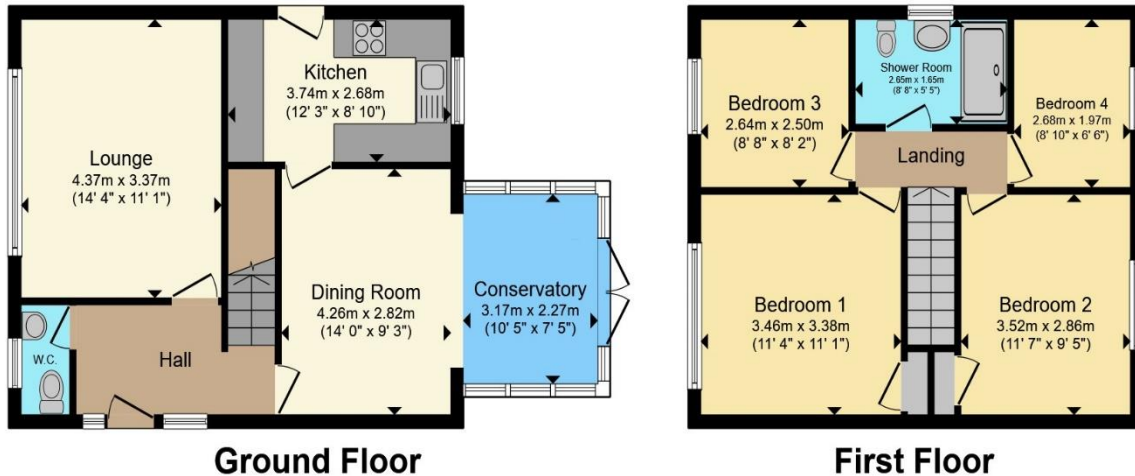

Total floor area 97.1 m² (1,045 sq.ft.) approx

This floor plan is for illustrative purposes only. It is not drawn to scale. Any measurements, floor areas (including any total floor area), openings and orientation are approximate. No details are guaranteed, they cannot be relied upon for any purpose and they do not form part of any agreement. No liability is taken for any error, omission or misstatement. A party must rely upon its own inspection(s). Powered by www.propertybox.io

Important Information

Note while we endeavour to make our sales details accurate and reliable, if there is any point which is of particular interest to you, please contact the office and we will be pleased to confirm the position for you. We have not personally tested any apparatus, equipment, fixtures, fittings or services and cannot verify they are in working order or fit for their purposes. Nothing in these particulars is intended to indicate that carpets or curtains, furnishings or fittings, electrical goods (whether wired or not). Gas fires or light fittings or any other fixtures not expressly included form part of the property offered for sale. This computer generated Floorplan, if applicable, is intended as a general guide to the layout and design of the property. It is not to scale and should not be relied upon for dimensions. Tenure: We cannot confirm the tenure of the property as we have not had access to the legal documents. The buyer is advised to obtain verification from their solicitor or surveyor.