



Station Parade, SW12

£1,800 Per calendar month

A spacious first floor flat in the heart of Balham, which has been recently refurbished and offers wooden flooring throughout. Ideal for a professional couple or single occupant.

Balham High Road is ideally located for Balham mainline/ underground stations, as well as all of the shops, bars and restaurants local to the area.

Features

- One Double Bedroom
- First Floor Flat
- Modern Interior
- Wooden Flooring
- Newly Refurbished
- Close To Transport

Station Parade, London, SW12

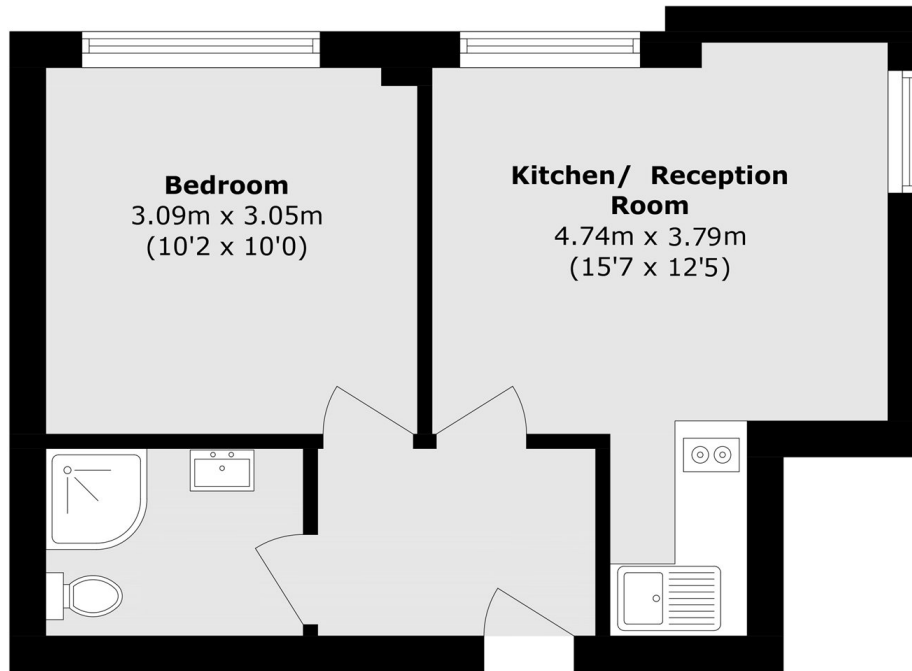

Total area (approx.): 31.3 sq. m (336.9 sq. ft)