

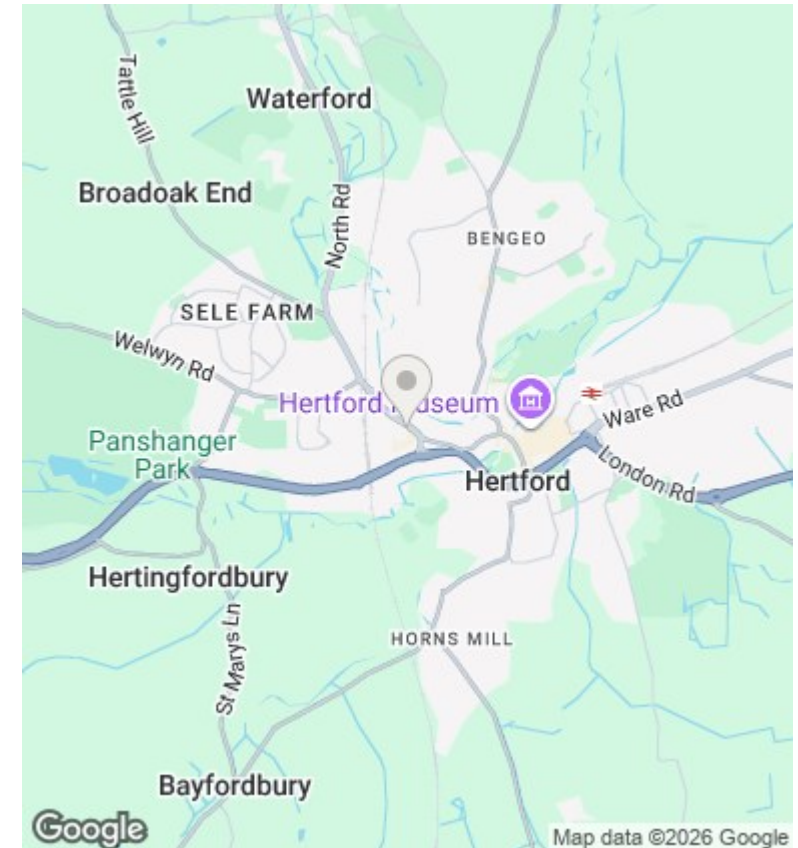

## 21 Sele Mill, North Road, Hertford, SG14 1LD

£1,150 PCM

- ONE BED APARTMENT
- CLOSE TO TRAIN STATION - HERTFORD NORTH
- PARKING SPACE
- RIVER VIEWS / BALCONY
- AVAILABLE NOW
- GATED DEVELOPMENT
- CLOSE TOWN CENTRE

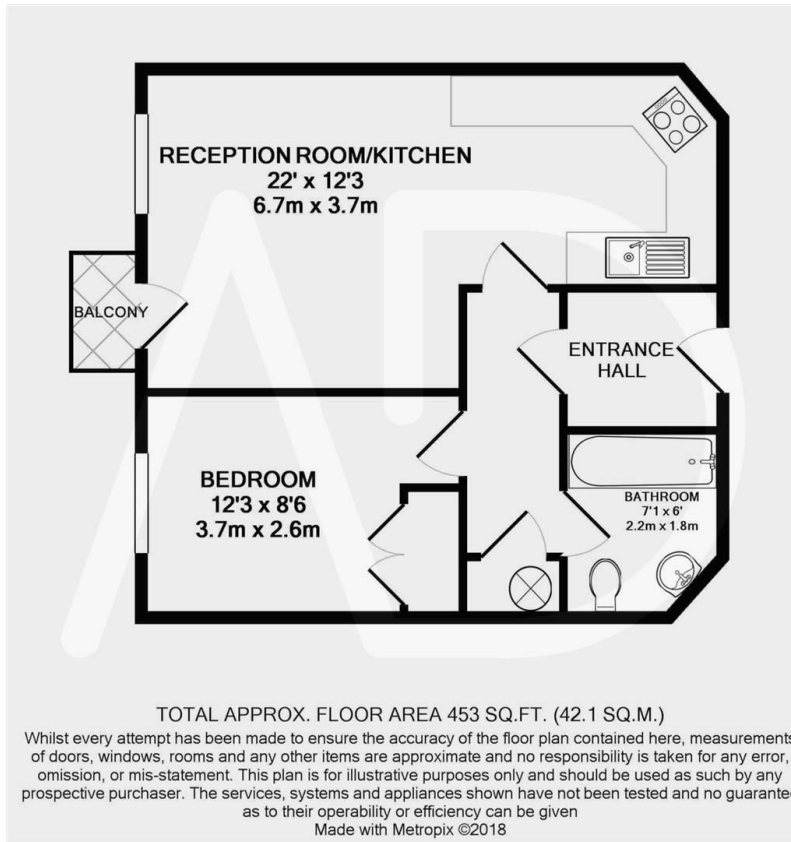

## Directions

## Viewings

Viewings by arrangement only. Call 01992 470335 to make an appointment.

## Council Tax Band

B

## EPC Rating:

C

Energy Efficiency Rating		Current	Potential
Very energy efficient - lower running costs			
(92 plus)	A		
(81-91)	B		
(69-80)	C	79	83
(55-68)	D		
(39-54)	E		
(21-38)	F		
(1-20)	G		
Not energy efficient - higher running costs			
England & Wales		EU Directive 2002/91/EC	