

HUNTERS[®]

HERE TO GET *you* THERE



Clere Street

Shoreditch, London, EC2A 4LL

£588,000



Positioned on the fourth floor of the sought-after Vetro Building on Clere Street, this beautifully presented one-bedroom apartment offers bright, contemporary living in one of London's most vibrant neighbourhoods.

The property features a spacious open-plan lounge/diner, enhanced by large windows that flood the space with natural light and provide attractive city views. The modern kitchen is sleek and well-designed, complete with integrated appliances and a stylish island with hob, making it ideal for both everyday living and entertaining.

The double bedroom is generously sized, offering a calm and comfortable retreat with ample storage potential, while a modern bathroom suite and well-proportioned hallway complete the layout. Extending to approximately 548 sq. ft., the apartment makes excellent use of space throughout.

Old Street Station is approximately 0.3 miles away (around a 5-minute walk), Shoreditch High Street Station is approximately 0.4 miles (around 7 minutes), Liverpool Street Station is approximately 0.6 miles (around a 10-minute walk), and Moorgate Station is approximately 0.7 miles (around a 12-minute walk), offering excellent connectivity across the City and beyond.

Situated in the heart of Shoreditch, the apartment is surrounded by an eclectic mix of cafés, restaurants, bars, and boutique shops, offering a vibrant lifestyle with everything on your doorstep.



Area Map

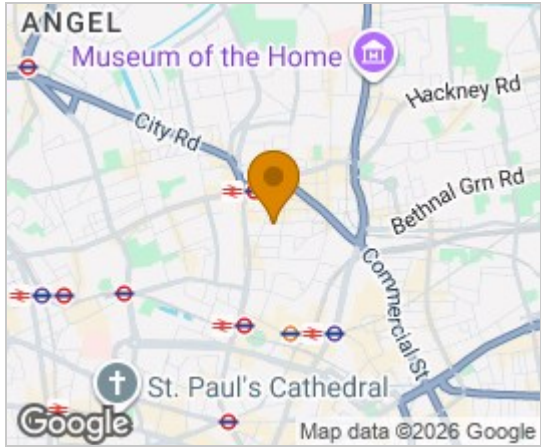

Floor Plans

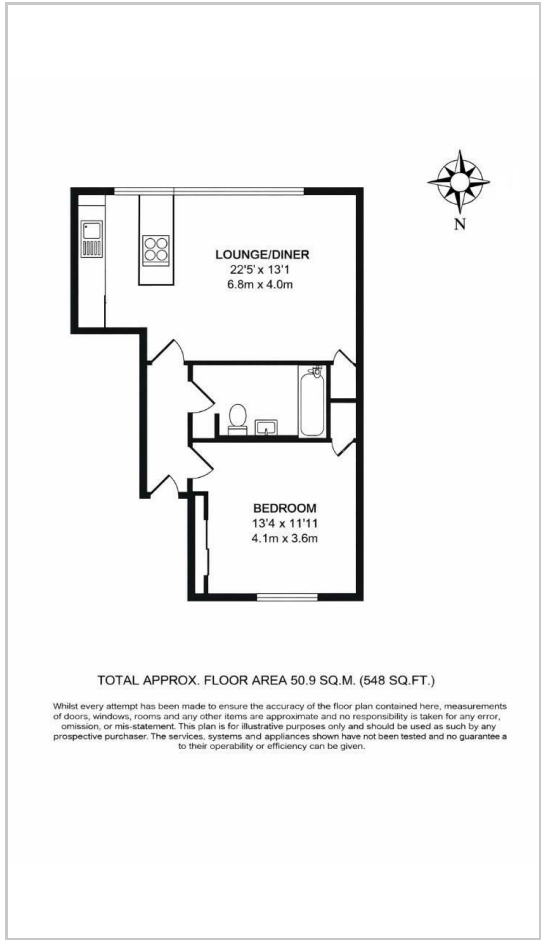

Energy Efficiency Graph

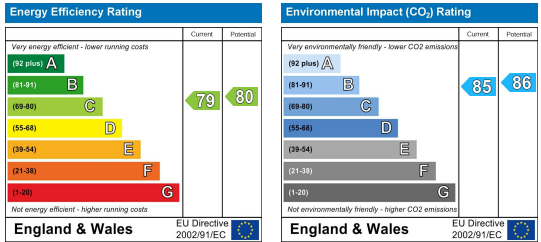

These particulars are intended to give a fair and reliable description of the property but no responsibility for any inaccuracy or error can be accepted and do not constitute an offer or contract. We have not tested any services or appliances (including central heating if fitted) referred to in these particulars and the purchasers are advised to satisfy themselves as to the working order and condition. If a property is unoccupied at any time there may be reconnection charges for any switched off/disconnected or drained services or appliances - All measurements are approximate. **THINKING OF SELLING?** If you are thinking of selling your home or just curious to discover the value of your property, Hunters would be pleased to provide free, no obligation sales and marketing advice. Even if your home is outside the area covered by our local offices we can arrange a Market Appraisal through our national network of Hunters estate agents.